

THE SUITE LIFE

Treat yourself to the luxury of a spacious suite

There's a very easy way to make your Holland America Line cruise even more pleasurable. Indulge yourself — ask your travel advisor to book you in one of our luxurious Vista, Signature, Neptune or Pinnacle suites. We invite you to experience the difference. Get ready to be forever spoiled for any other style of cruising.



SPACIOUS STATEROOMS	VISTA AND SIGNATURE SUITES	NEPTUNE AND PINNACLE SUITES
<p>Refined amenities grace each elegant stateroom. Most of our spacious staterooms are ocean-facing; many have teak-lined verandahs for dining alfresco or sunbathing in private.</p> <ul style="list-style-type: none"> ▪ Our signature Mariner's Dream™ bed featuring a plush Euro-Top mattress and finely woven cotton linens ▪ Daily housekeeping to tidy belongings and keep staterooms immaculate ▪ 100% Egyptian cotton towels and luxurious bathrobes for use during the voyage ▪ Lighted magnifying mirrors; massage showerheads; salon-quality hair dryers ▪ Fragrant soaps, lotions, shampoo and other bath amenities from Elemis <i>Aromapure</i> ▪ Flat-panel TV and DVD player, complimentary DVD library ▪ Generous storage and safes for your valuables ▪ Complimentary fresh fruit on request and complimentary 24-hour In-Room Dining ▪ Nightly turndown service, complimentary shoeshine service and ice service 	<p>Reward yourself with extra room to spread out, your own verandah and a host of complimentary services. For guests choosing suite accommodations, an extra measure of luxurious living awaits.</p> <p>Vista and Signature suites include all the stateroom amenities, PLUS:</p> <ul style="list-style-type: none"> ▪ Teak-lined private verandah ▪ Floor-to-ceiling glass doors, large sitting area and whirlpool bath (Signature Suites) ▪ Choice of firm, medium or soft pillows ▪ Premium duvet; oversized bath towels; and soft, cotton bathrobes ▪ No-host mini-bar ▪ Personalized cruise stationery ▪ One-touch telephone concierge service ▪ Fresh flowers ▪ Umbrellas for your use 	<p>Neptune and Pinnacle suites include all the stateroom and Vista and Signature suite amenities, PLUS:</p> <ul style="list-style-type: none"> ▪ Use of the exclusive Neptune Lounge and personal concierge♦ ▪ Complimentary laundry, pressing and dry cleaning ▪ Complimentary sparkling wine served in the Neptune Lounge upon embarkation ▪ Complimentary bottled water provided in suite at embarkation ▪ Corsage and boutonniere for the first formal night ▪ Cold hors d'oeuvres each evening on request ▪ Binoculars during your cruise ▪ Cocktail party with ship's officers ▪ Priority boarding for tendered ports of call ▪ Special disembarkation service ▪ Priority dining and seating requests ▪ Exclusive daily breakfast service ▪ High tea service in suite on request

♦ Neptune Lounge and personal concierge are for the exclusive use of Pinnacle and Neptune suite guests only.



Reward yourself

A Holland America Line suite gives you the extra room to spread out, your own verandah and a host of complimentary services. For guests choosing suite accommodations, an extra measure of luxurious living awaits. When compared to a hotel suite, a Holland America Line suite is an exceptional value providing an extensive collection of refined amenities designed to make your cruise experience one you'll never forget.

Pinnacle Suite
Approx. 862–1,296 sq. ft. with Verandah

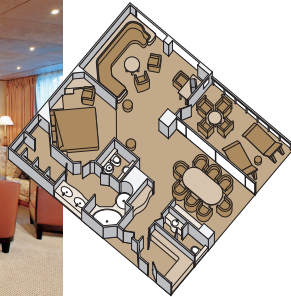

Neptune Suite
Approx. 500–712 sq. ft. with Verandah

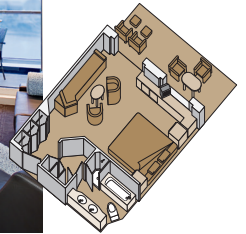

Signature Suite ♦
Approx. 273–456 sq. ft. with Verandah

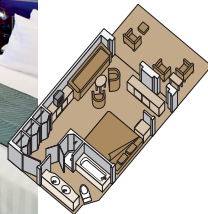

Vista Suite ♦
Approx. 221–379 sq. ft. with Verandah

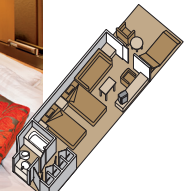

NOTE: Room measurements are approximate, and some rooms in the same category may vary in size and/or have different furniture placement and furnishings from that pictured.

The Neptune Lounge ♦

Choose a spectacular Pinnacle Suite or sumptuous Neptune Suite and you'll also have access to the Neptune Lounge — your own private retreat where you can relax, read and socialize. You can take advantage of personalized services from the lounge's concierge, who will gladly make reservations for shore excursions, car rentals, the Pinnacle Grill dining experience and more.

For guests reserving a Pinnacle or Neptune suite, the Neptune Lounge offers a private place to relax, socialize with other suite guests and enjoy the personalized services of a concierge. Coffee and fresh juices are

available each morning and refreshments are provided throughout the day. Check your email (the Neptune Lounge is Wi-Fi enabled, with generous worktables), relax on comfortable sofas while watching CNN on the large-screen TV, meet friends for bridge or have the concierge arrange dinner in the Pinnacle Grill. One-touch 24-hour concierge service is available when the Neptune Lounge is closed.

- Signature Suites are available on *ms Zuiderdam*, *ms Oosterdam*, *ms Westerdam*, *ms Noordam*, *ms Eurodam*, *ms Nieuw Amsterdam* and *ms Prinsendam*.
- Vista Suites are available on *ms Amsterdam*, *ms Rotterdam*, *ms Zaandam*, *ms Volendam*, *ms Statendam*, *ms Maasdam*, *ms Ryndam*, *ms Veendam* and *ms Prinsendam*.
- Neptune Lounge and personal concierge are for the exclusive use of Pinnacle and Neptune suite guests only.
- There is a nominal fee for Wi-Fi access in the Neptune Lounge.



AP17252



SPACIOUS, ELEGANT SHIPS ■ GRACIOUS, AWARD-WINNING SERVICE ■ WORLDWIDE ITINERARIES
EXTENSIVE ACTIVITIES AND ENRICHMENT PROGRAMS ■ SOPHISTICATED FIVE-STAR DINING

 **Holland America Line**
A Signature of Excellence