



ms Zuiderdam · ms Oosterdam

Deck Plans & Ship Information



Holland America Line

A Signature of Excellence



Vista-class elegance For millennia, the compass has guided intrepid sailors as they explored the Seven Seas. It is fitting that Holland America Line's magnificent Vista-class ships are named for the four points of the compass: ms Zuiderdam (south), ms Oosterdam (east), ms Westerdam (west) and ms Noordam (north). Each embodies the soul of premium cruising, providing more of everything the adventurous heart desires. Discover elegantly appointed staterooms with luxurious Mariner Dream™ beds and spacious verandahs for private viewing, dining and sunning. Here, too, find more dining choices, including the Lido Restaurant, now transformed into a culinary courtyard. More ways to pamper and relax in The Greenhouse Spa and Salon, with its thermal suites and magnificent hydrotherapy pool. And more dazzling surprises, including striking outside glass elevators that whisk guests from floor to floor with panoramic views. Prepare for an utterly enchanting experience — no matter which direction the compass point



UPPER LEFT: The reservations-only *Pinnacle Grill*, renowned for its Sterling Silver Beef and Bvlgari® china, ensures an extraordinary dining experience by providing two servers per table. Holland America Line believes dining is not about quantity, but experience and celebration; we are known far and wide for our innovative culinary concepts and extensive wine list, featuring many selections rated “Excellent” by *Wine Spectator*.

LOWER LEFT: The *Vista Lounge* is one of the most technologically advanced venues at sea, home to a host of award-winning performances. From Las Vegas-style productions to talented vocalists, illusionists, comedians and variety acts, the *ms Zuiderdam* and *ms Oosterdam* offer the very best in onboard entertainment.

UPPER RIGHT: Take a brisk walk on the teak *Promenade Deck* or just relax with an afternoon cocktail. The *ms Zuiderdam* and *ms Oosterdam* also each have a basketball court and a volleyball court where you can hone your game under the wide-open sky.

MIDDLE RIGHT: Have a favorite tune? Settle in for a night of upbeat entertainment and rousing sing-alongs at the *Piano Bar*. Join the late-night scene in the Northern Lights Nightclub or Crow's Nest, both of which feature hot DJs and dance floors. Or if you prefer a live band, you can dance the night away at the Ocean Bar. There's also casino action, live telecasts at the Sports Bar and recent-release movies with free popcorn.

BOTTOM RIGHT: At the heart of every Vista-class ship is a specially commissioned *signature sculpture*, suspended in a three-story atrium. The *ms Oosterdam* features a magnificent globe, symbolic of Holland America's 132-year history of exploring the far corners of the world.





Experience heaven on the high seas.

UPPER LEFT: The *Vista Dining Room* is a two-tiered dining venue that provides one of the finest dining experiences at sea, offering everything from continental cuisine to vegetarian and low-carb options. Five-course menus, created daily and seldom repeated, are enhanced by impeccable service and an extensive wine list. You can also enjoy a special Royal Dutch High Tea once per cruise.

UPPER RIGHT: *The Greenhouse Spa & Salon* is a sensuous treat for all five senses, offering massage and a wide variety of luxurious treatments, including couple's massage rooms, a dry float suite, thermal steam and aromatic room, hydrotherapy pool and relaxation area. You can work out on all the latest exercise and weight-training

equipment or take a Pilates class at the Fitness Center. Or you can simply relax on a heated ceramic lounge and enjoy the glorious passing scenery.

BOTTOM, LEFT TO RIGHT: The *Explorer's Lounge* provides a comfortable after-dinner atmosphere for enjoying hand-dipped chocolates and specialty coffee drinks. Live classical music creates a tasteful ambiance while our skilled crew caters to your every preference.

The relaxed *Lido Restaurant* offers a casual alternative for all three meals. Choose from a variety of fresh, cooked-to-order specialties for lunch and dinner, and indulge yourself with a chocolate dessert extravaganza or late-night snack.

Vista-class ships feature two swimming pools and delightful commissioned sculptures. The aft pool offers fabulous views off the back of the ship, and the *Lido Pool* is sheltered beneath a retractable glass-domed roof. After a dip in the whirlpool, get a quick bite at the *Terrace Grill*, where swimsuits are suitable attire.

Order a latté at the *Windstar Café*, then get connected at the *Internet Center*, your 24-hour link to the world. Fast Internet access gives you the freedom to stay in touch with the latest news or with loved ones back home. Or, bring your laptop and log on from the privacy of your stateroom.



MAIN DECK
Staterooms 1001-1127
252 ft. from bow
to Staterooms 1001 & 1002.

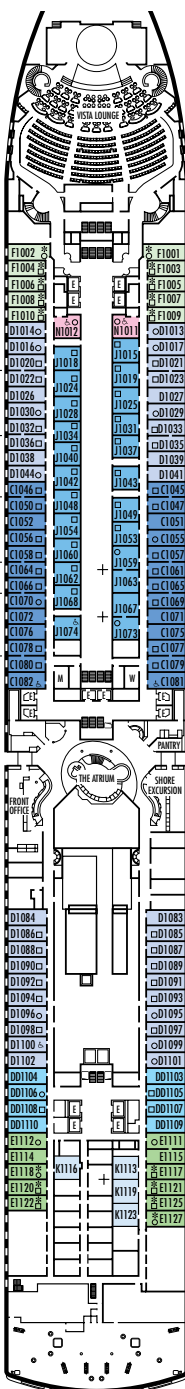

102 ft. to stern
from Staterooms 1122 & 1127.

LOWER PROMENADE DECK

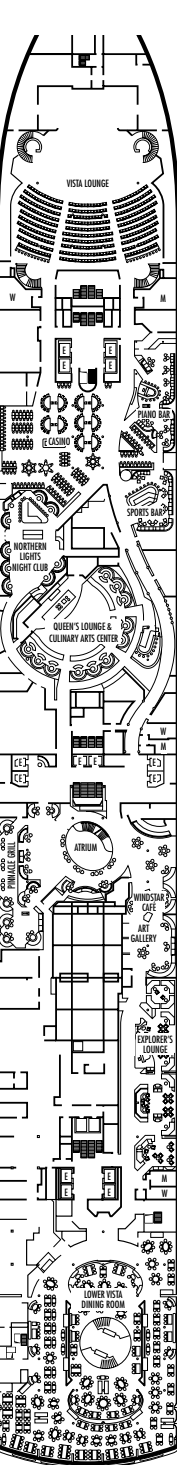

PROMENADE DECK

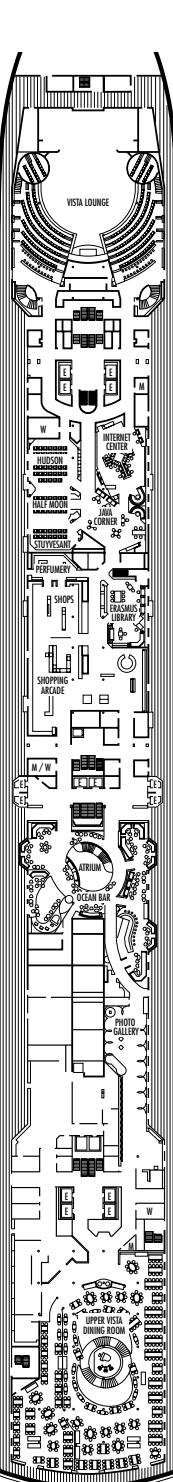

UPPER PROMENADE DECK
Staterooms 4001-4185
1022 ft. from bow
to Staterooms 4001 & 4002.

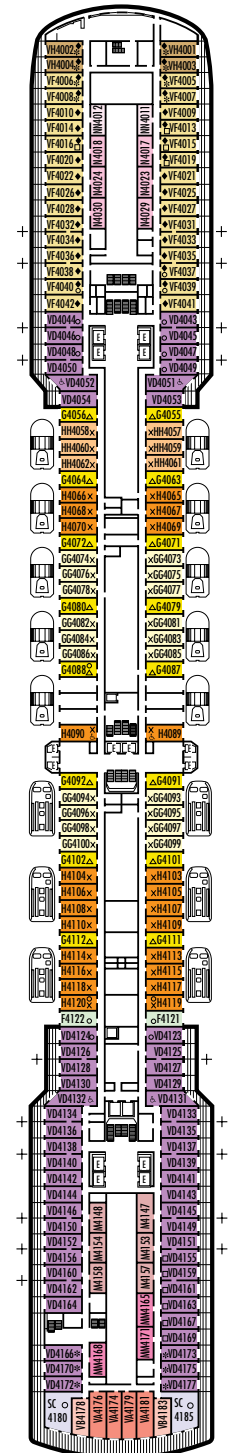

9 ft. to stern from
Staterooms 4180, 4178, 4176,
4174, 4179, 4181, 4183 & 4185.

VERANDAH DECK
Staterooms 5001-5187
102 ft. from bow
to Staterooms 5001 & 5002.

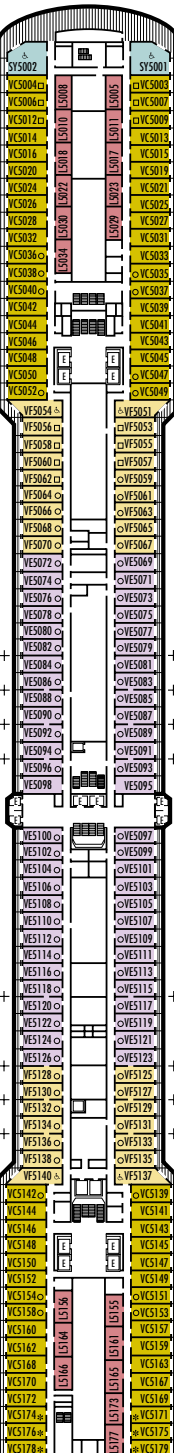

23 ft. to stern from
Staterooms 5186, 5184, 5182,
5180, 5181, 5183, 5185 & 5187.

UPPER VERANDAH DECK
Staterooms 6001-6169
112 ft. from bow
to Staterooms 6003 & 6004.

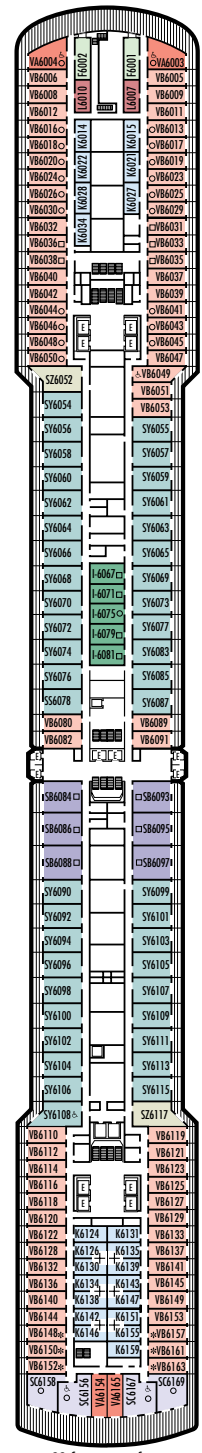

33 ft. to stern from
Staterooms 6158, 6156, 6154,
6165, 6167 & 6169.

ROTTERDAM DECK
Staterooms 7001-7133
121 ft. from bow
to Staterooms 7001 & 7002.

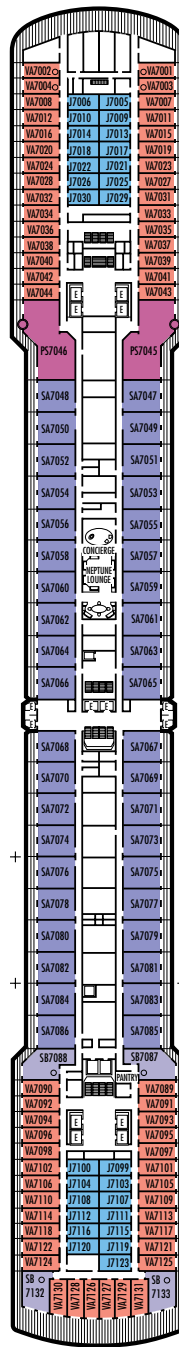

56 ft. to stern from Staterooms
7132, 7130, 7128, 7126, 7127,
7129, 7131 & 7133.

NAVIGATION DECK
Staterooms 8001-8135
186 ft. from bow
to Staterooms 8001 & 8002.

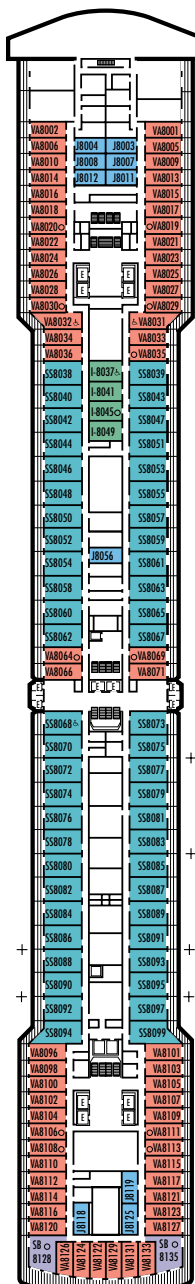

68 ft. to stern from Staterooms
8128, 8126, 8124, 8122, 8129,
8131, 8133, & 8135.

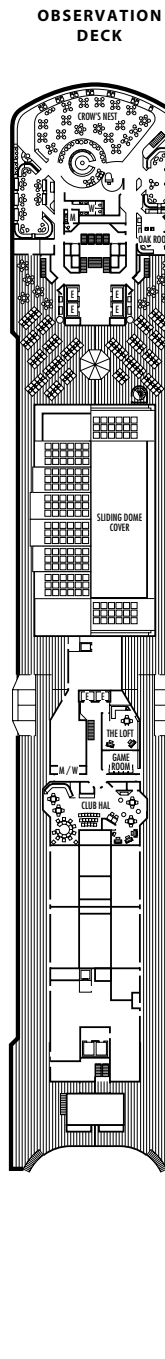
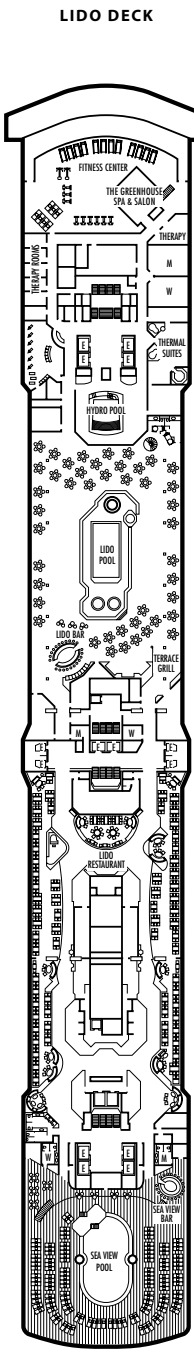

ms Zuiderdam
ms Oosterdam

DECK PLANS & STATEROOMS

The deck plans are color-coded by category of stateroom, and the category letter precedes the stateroom number in each room. All staterooms are equipped with television, mini-bar, mini-safe, data port, telephone and multi-channel music.

Important Note: Not all staterooms within each category have the same furniture configuration and/or facilities. Appropriate symbols within the rooms on the deck plans describe differences from the stateroom descriptions below.

VERANDAH SUITES

PS

Penthouse Verandah Suites: Bedroom with 1 king-size bed, oversized whirlpool bath & shower & additional shower stall, living room, dining room, dressing room, private verandah with whirlpool, pantry, 1 sofa bed for 2 persons, microwave, refrigerator, guest toilet, private stereo system, DVD player, floor-to-ceiling windows.

SA SB SC

Deluxe Verandah Suites: 2 lower beds convertible to 1 king-size bed, bathroom with dual sink vanity, full-size whirlpool bath & shower & additional shower stall, large sitting area, dressing room, private verandah, 1 sofa bed for 2 persons, DVD player, floor-to-ceiling windows.

SS SY SZ

Superior Verandah Suites: 2 lower beds convertible to 1 queen-size bed, bathroom with dual sink vanity, full-size whirlpool bath & shower & additional shower stall, large sitting area, dressing room, private verandah, 1 sofa bed for 1 person, DVD player, floor-to-ceiling windows.

VERANDAH STATEROOMS

VA VB VC VD VE

Deluxe Verandah Outside: 2 lower beds convertible to 1 queen-size bed, bathtub & shower, sitting area, private verandah, floor-to-ceiling windows.

OUTSIDE STATEROOMS

C D DD E F

Large: 2 lower beds convertible to 1 queen-size bed, bathtub & shower.

G GG

Large: 2 lower beds convertible to 1 queen-size bed, bathtub & shower. All G-GG-category staterooms have partial sea views. All GG-category staterooms have fully obstructed views.

H HH

Large: 2 lower beds convertible to 1 queen-size bed, bathtub & shower. All H-HH-category staterooms have fully obstructed views.

INSIDE STATEROOMS

I

Large: 2 lower beds convertible to 1 queen-size bed, shower.

J K

Large or Standard: 2 lower beds convertible to 1 queen-size bed, shower.

L M MM N NN

Standard: 2 lower beds convertible to 1 queen-size bed, shower.

STATEROOM SYMBOL LEGEND

- * Shower only
- Triple (2 lower beds, 1 sofa bed)
- Quad (2 lower beds, 1 sofa bed, 1 upper)
- △ Partial sea view
- × Fully obstructed view
- + Connecting rooms
- ◆ Staterooms have solid steel verandah railings instead of clear-view Plexiglas railings

- ♿ Staterooms SC6156, SC6167, SY5001, SY5002, SY6108, SS8068, VA6003, VA6004, VA8031, VA8032, VB6049, VD4051, VD4052, VD4131, VD4132, VF5051, VF5054, VF5137, VF5140, C1081, C1082, D1100, H4089, H4090, I-8037, J1074, N1011, N1012 are wheelchair accessible, shower only.

SHIP SPECIFICATIONS & FACILITIES

- 1,848 Guests
- 82,000 Gross Tons
- 950 Feet Long
- Automatic Stabilizers
- 11 Guest Decks
- 14 Guest Elevators
- 4 Outside Elevators
- 24 Public Rooms
- 4 Restaurants
- Outdoor Swimming Pools (one with sliding glass roof)
- Spa & Salon
- Two Show Lounges
- Duty-free Shops
- Library
- Casino
- Fitness Center
- Basketball Court
- Volleyball Court
- Internet Center
- Suite Lounge

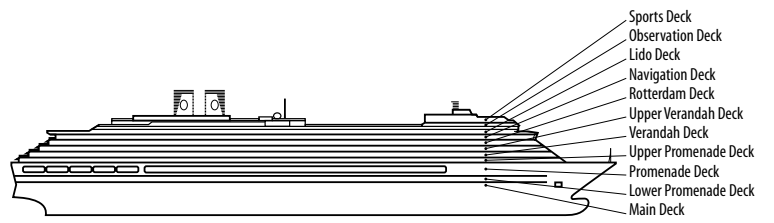

Staterooms with room to move.

Our elegant staterooms are the largest of any premium cruise line. Two-thirds of our staterooms feature spacious, private verandahs where you can enjoy complimentary 24-hour alfresco dining. You'll sleep soundly on a Mariner's Dream™ bed beneath finely woven cotton linens, and each morning you'll discover the daily satellite edition of *The New York Times*, delivered to your stateroom.

For guests staying in the Penthouse Verandah Suites and Deluxe Verandah Suites, the exclusive Neptune Lounge offers a well-stocked library, coffee, tea and snacks, as well as personal concierge service. And all suite guests have access to convenient, one-touch telephone concierge service, 24 hours a day.

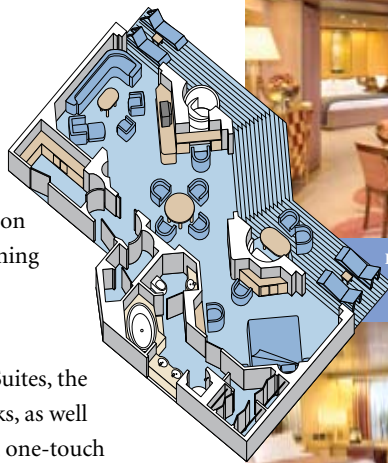

PENTHOUSE VERANDAH SUITE
approx. 1,541 sq. ft.
with Verandah

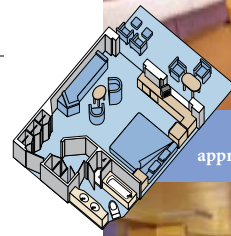

DELUXE VERANDAH SUITE
approx. 510-700 sq. ft. with Verandah

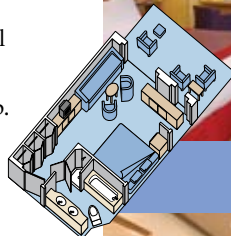

SUPERIOR VERANDAH SUITE
approx. 398 sq. ft. with Verandah

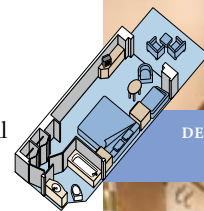

DELUXE VERANDAH OUTSIDE DOUBLE
approx. 254 sq. ft. with Verandah

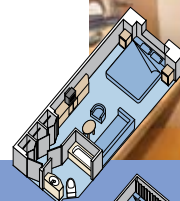

LARGE OUTSIDE DOUBLE
approx. 185 sq. ft.

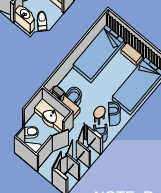

LARGE INSIDE DOUBLE
approx. 170-200 sq. ft.

SUPERIOR SHIP FACILITIES

In addition to the incredible range of dining choices, entertainment options and activities, Vista-class ships provide all the facilities you need to make your voyage everything you'd hope for.

ENRICHING ACTIVITIES

With more than 50 scheduled shipboard activities—from kick-boxing to dancing, wine tasting to art auctions—you're free to do as much or as little as you please. The Explorations Speaker Series, on cruises 10 days or longer, gives you an inside look at the history, culture and traditions of the exciting destinations you'll explore. And kids and teens have all kinds of activities of their own to choose from, so they can enjoy a (supervised) good time while you kick back in peace with a book or magazine from one of the most extensive libraries on the seven seas. You can watch a recent-release movie while you munch free popcorn or indulge your taste for new culinary discoveries at the Queen's Lounge and Culinary Arts Center, which provides cooking demonstrations and interactive classes.

EXCURSIONS AND ONBOARD SERVICES

Planning to explore a destination? We recommend you book online before you depart, but you can also contact the onboard Holland America Shore Excursions Office to find out about tour options and exclusive Medallion Shore Excursions. You'll enjoy duty-free shopping at the Signature Shops and specialty wine and gourmet shop. There is also a photo center and laundry and dry-cleaning services. And for peace of mind, we offer a U.S.- or Canadian-trained doctor and nursing staff, along with a full range of FDA-approved medications.

MEETING ROOMS OF ALL SIZES

No matter what sort of gathering you have in mind, Holland America Line will take care of the details. The *ms Zuiderdam* and *ms Oosterdam* offer meeting rooms for everything from small seminars and cocktail parties to large presentations. You'll also have access to a full range of audio-visual equipment to meet your needs.

www.hollandamerica.com

SPACIOUS, ELEGANT SHIPS • GRACIOUS, UNOBTRUSIVE SERVICE • WORLDWIDE ITINERARIES
EXTENSIVE ACTIVITIES AND ENRICHMENT PROGRAMS • SOPHISTICATED FIVE-STAR DINING

PUBLIC AND MEETING ROOM CAPACITIES

Vista Dining Room	1,114	Crow's Nest	230	Erasmus Library	26
Lido Restaurant	446	Ocean Bar	150	Club HAL® & Teen Area	67
Pinnacle Grill	140	Explorer's Lounge	80	<i>Meeting Rooms</i>	
Windstar Café	70	Piano Bar	65	Hudson Room	40-50
Vista Lounge	804	Sports Bar	42	Half Moon Room	15-25
Java Corner	35	Northern Lights Nightclub	58	Stuyvesant Room	20-30
Queen's Lounge and Culinary Arts Center*	166	Internet Center	30	Queen's Room	34

NOTE: Room measurements are approximated, and some rooms in the same category may vary in size and/or have different furniture placement from that pictured.

Ships' Registry: The Netherlands
VS15826 Effective July 2006

*The Culinary Arts Center will be available on *ms Oosterdam* after October 3, 2006.