



ms Statendam · ms Maasdam
ms Ryndam · ms Veendam

Deck Plans & Ship Information



 **Holland America Line**
A Signature of Excellence



Spacious comfort Grandly proportioned and appointed in timeless splendor, the *ms Statendam*, *ms Maasdam*, *ms Ryndam* and *ms Veendam* are among the most spacious ships at sea. These elegant sister ships are designed to carry fewer guests, offering more space in which to enjoy each voyage of discovery. ~ All four ships are masterpieces of the shipbuilder's art, with classic styling, world-class amenities and more of everything the adventurous heart desires: elegantly appointed public areas, the largest staterooms of any premium cruise line, expansive suites with private verandahs, more exquisite dining choices and more ways to unwind in The Greenhouse Spa & Salon, one of the top full-service luxury resort spas in the world. ~ Every voyage aboard Holland America's ships is graced with small touches, like an abundance of fresh flowers, and bold strokes, like fine art, sculptures and antiques from around the world. ~ The *ms Statendam*, *ms Maasdam*, *ms Ryndam* and *ms Veendam* are four sisters ships as unique as they are united in providing guests with the experience of a lifetime.



UPPER LEFT: The *Rotterdam Dining Room* is a two-tiered dining venue that provides one of the finest dining experiences at sea, offering everything from continental cuisine to vegetarian and low-carb options. Five-course menus, created daily and seldom repeated, are enhanced by impeccable service and an extensive wine list. You can also enjoy special Royal Dutch High Tea once per cruise.

LOWER LEFT: *The Greenhouse Spa & Salon* is a sensuous treat for all five senses, offering massage and a wide variety of luxurious treatments, including couple's massage rooms, a dry float suite, thermal steam and aromatic room and relaxation area. You can work out on all the latest exercise and weight-training equipment or take a Pilates class at the Fitness Center. Or you can simply relax on a heated ceramic lounger and enjoy the glorious passing scenery.

UPPER RIGHT: Take a brisk walk on the teak *Promenade Deck* or just relax with an afternoon cocktail. The ships also have basketball courts and practice tennis courts where you can hone your game under the wide-open sky.

MIDDLE RIGHT: The reservations-only *Pinnacle Grill*, renowned for its Sterling Silver Beef and Bvlgari® china, ensures an extraordinary dining experience by providing two servers per table. Holland America Line believes dining is not about quantity, but experience and celebration; we are known far and wide for our innovative culinary concepts and extensive wine list, featuring many selections rated "Excellent" by *Wine Spectator*.

BOTTOM RIGHT: At the heart of these sumptuous sister ships, a specially commissioned *signature sculpture* is suspended in a soaring, three-story atrium. The *ms Statendam* features the seductive *Fountain of the Sirens*. The dazzling "lightcatcher" Totem sculpture aboard the *ms Maasdam* is comprised of nearly 2,000 glimmering pieces of glass. In the *ms Ryndam* you'll find a monumental marble fountain, much like you'd find in a Roman piazza. And the *ms Veendam* is home to a blue and gold crystalline glass tower. Each of these magnificent installations is as breathtaking as it is unique.





Experience heaven on the high seas.

UPPER LEFT: The *Explorations Café*—powered by *The New York Times*—is a welcoming respite where you can sip a mocha while e-mailing loved ones back home. This elegant, cutting-edge environment offers much more than a comfortable place to enjoy your favorite tunes at a listening station. You can also surf the Internet, work on crossword puzzles and learn about the destinations you'll be exploring through one of the most extensive libraries at sea.

UPPER RIGHT: The *Main Lounge* is home to a host of award-winning performances. From Las Vegas-style productions to talented vocalists, illusionists, comedians and variety acts, all four sister ships offer the very best in onboard entertainment. You can also experience live music at the Piano Bar, try your luck at the casino or dance the night away at the Ocean Bar or Crow's Nest.

BOTTOM, LEFT TO RIGHT: The *Explorer's Lounge* provides a comfortable after-dinner atmosphere for enjoying hand-dipped chocolates and specialty coffee drinks. Live classical music creates a tasteful ambiance while our skilled crew caters to your every preference.

The *Culinary Arts Center*—presented by *Food & Wine* magazine—is a dream come true for food lovers, cooks and epicureans. You'll get a first-hand glimpse of our world-class chefs in action through gourmet demonstrations, tasting events and intimate cooking classes. Overhead mirrors and cameras provide close-ups of the action on large plasma screens, or you can view live broadcasts in the comfort of your stateroom.

The *Lido Pool* is sheltered beneath a retractable glass-domed roof and features a delightful commissioned sculpture of five leaping dolphins cast in bronze. After a dip in the whirlpool, get a quick bite at the Terrace Grill, where swimsuits are suitable attire. The Aft Pool offers fabulous views off the back of the ship.

The relaxed *Lido Restaurant* offers a casual alternative for all three meals. Choose from a variety of fresh, cooked-to-order specialties for lunch and dinner, and indulge yourself with a chocolate dessert extravaganza or late-night snack.



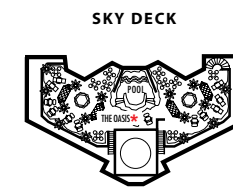
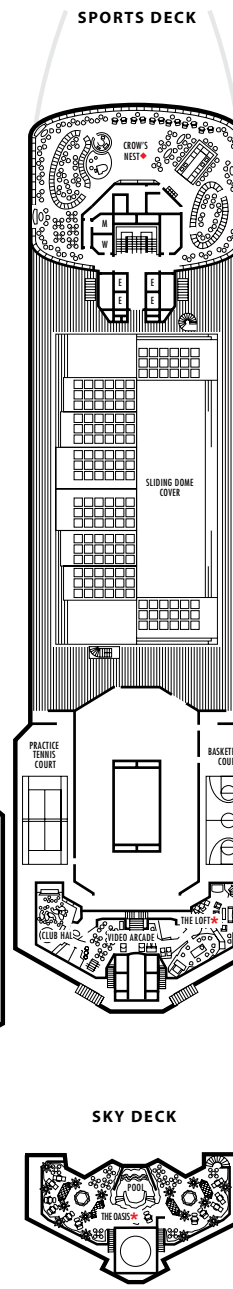
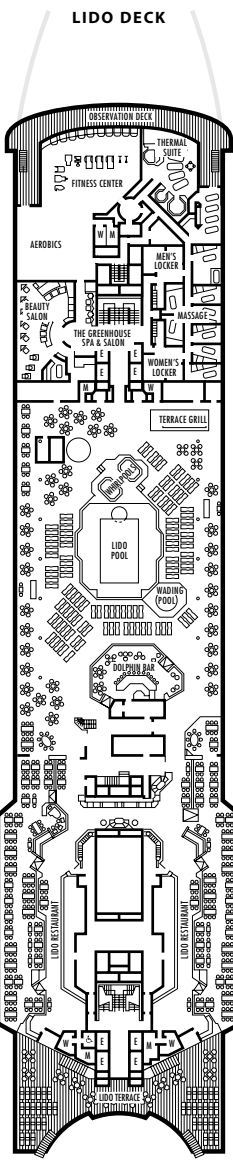
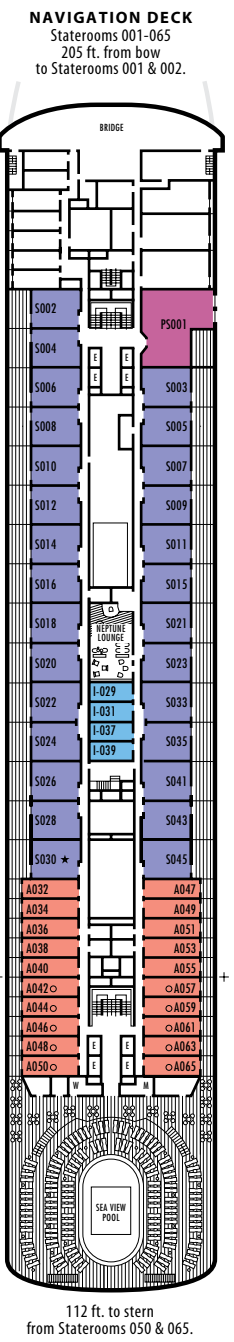
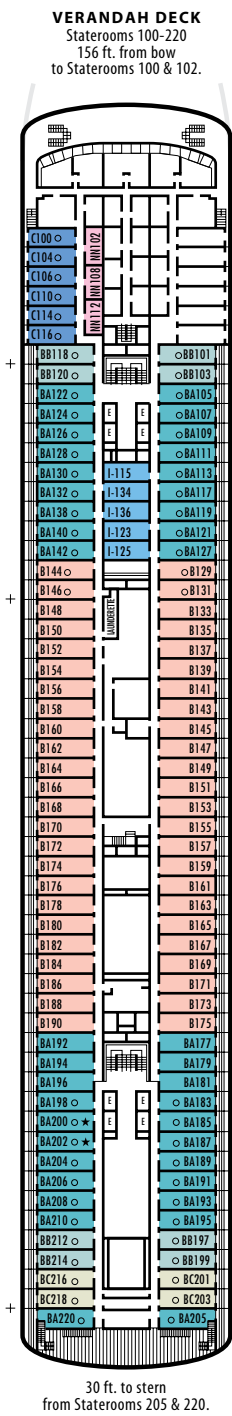
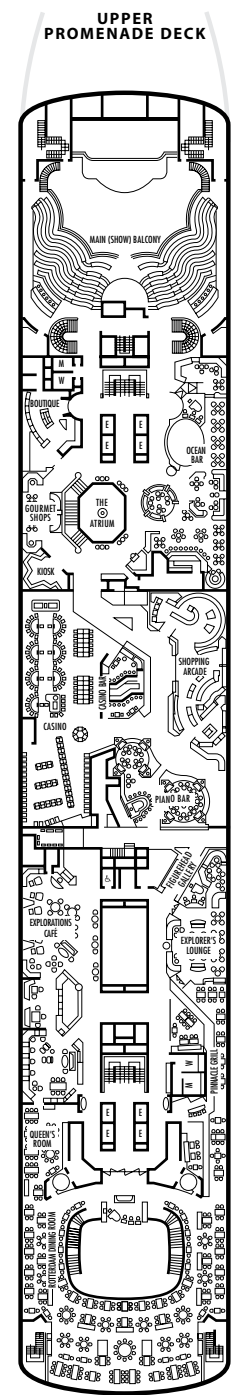
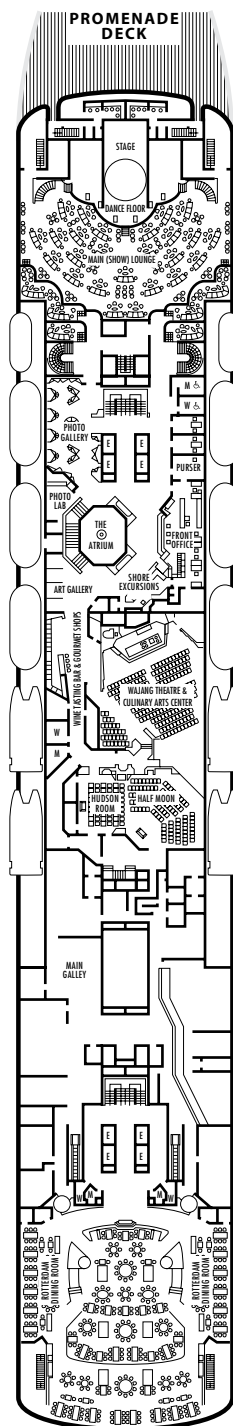
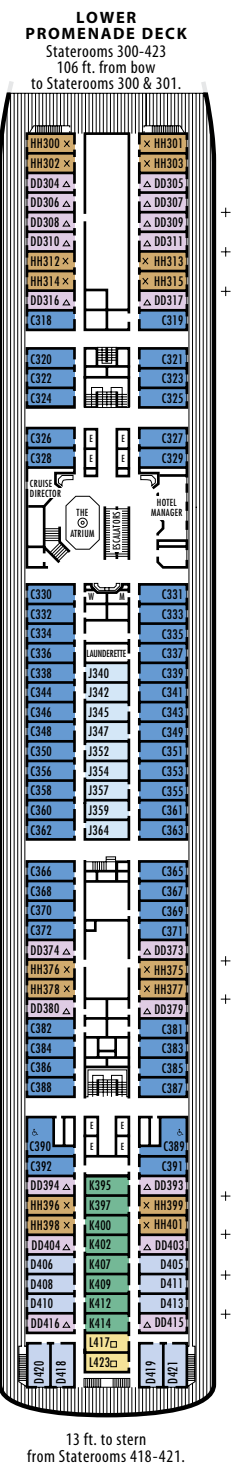
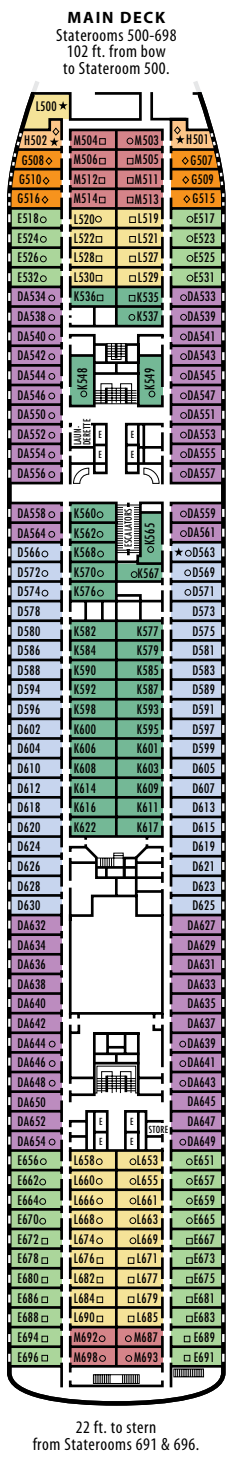
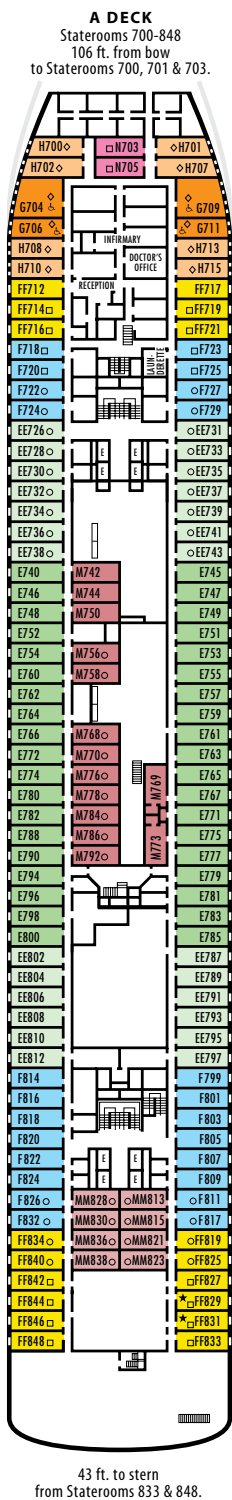

ms Statendam ms Maasdam ms Ryndam ms Veendam

DECK PLANS & STATEROOMS
The deck plans are color-coded by category of stateroom, and the category letter precedes the stateroom number in each room. All staterooms are equipped with DVD player, flat-panel television, telephone and multi-channel music.

Important Note: Not all staterooms within each category have the same furniture configuration and/or facilities. Appropriate symbols within the rooms on the deck plans describe differences from the stateroom descriptions below.

VERANDAH SUITES

PS
Penthouse Verandah Suite: Bedroom with 1 king-size bed, oversize whirlpool bath & shower, living room, dining room, dressing room, private verandah, pantry, 1 sofa bed for 2 persons, mini-bar, refrigerator, guest toilet, floor-to-ceiling windows.

S
Deluxe Verandah Suites: 2 lower beds convertible to 1 king-size bed, whirlpool bath & shower, large sitting area, dressing room, private verandah, 1 sofa bed for 2 persons, mini-bar, refrigerator, floor-to-ceiling windows.

A B BA BB BC
Verandah Suites: 2 lower beds convertible to 1 queen-size bed, whirlpool bath & shower, sitting area, private verandah, mini-bar, refrigerator, floor-to-ceiling windows.

OUTSIDE STATEROOMS

C D DA DD E EE
Large: 2 lower beds convertible to 1 queen-size bed, bathtub & shower. All DD-category staterooms have partial sea views.

HH
Large: 2 lower beds convertible to 1 queen-size bed, bathtub & shower. All HH-category staterooms have fully obstructed views.

INSIDE STATEROOMS

I J K L M MM
Large: 2 lower beds convertible to 1 queen-size bed, shower.
N NN
Standard: 2 lower beds convertible to 1 queen-size bed, shower.

SHIP SPECIFICATIONS & FACILITIES

- 1,258 Guests
- 55,451 Gross Tons
- 720 Feet Long
- Automatic Stabilizers
- 10 Guest Decks
- 8 Guest Elevators
- 15 Public Rooms
- 3 Restaurants
- 2 Outdoor Swimming Pools (one with sliding glass roof)
- Health Spa
- Movie Theatre
- Duty-free Shops
- Library
- Casino
- Internet Center
- Practice Tennis Court
- Basketball Court

STATEROOM SYMBOL LEGEND

- * Shower only
- Triple (2 lower beds, 1 sofa bed)
- Quad (2 lower beds, 1 sofa bed, 1 upper)
- △ Partial sea view
- × Fully obstructed view
- + Connecting rooms (*ms Maasdam, ms Ryndam, ms Veendam* only)
- ◇ These staterooms have portholes instead of windows
- ★ Staterooms H501, H502, L500, D563, FF829, FF831, BA200, BA202, S030 are modified accessible, shower only with small step, step into bathroom, standard interior and exterior door size.
- ♿ Staterooms C389, C390, G704, G706, G709 & G711 are wheelchair accessible, roll-in shower only, wheelchair-accessible doorways.

PUBLIC ROOM NAMES

	MAIN (SHOW) LOUNGE	LIBRARY
<i>ms Statendam</i>	Van Gogh Lounge	Erasmus Library
<i>ms Maasdam</i>	Rembrandt Lounge	Leyden Library
<i>ms Ryndam</i>	Vermeer Lounge	Delft Library
<i>ms Veendam</i>	Rubens Lounge	Hugo De Groot Library

*The *ms Maasdam* has Club HAL area in lieu of The Oasis & The Loft.
♦The *ms Veendam's* Crow's Nest has a different configuration.

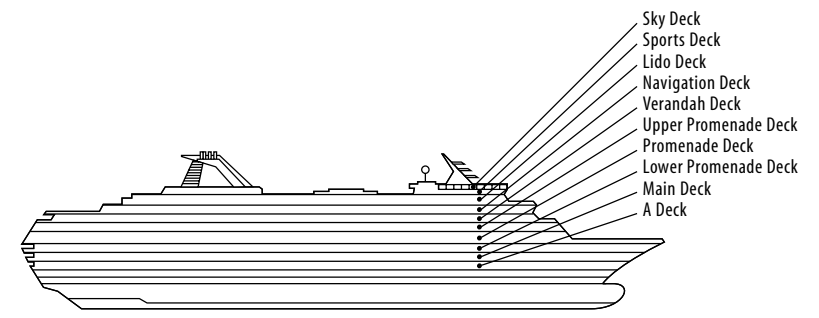

Staterooms with room to move.

Our elegant staterooms are the largest of any premium cruise line. Many of our staterooms feature spacious, private verandahs where you can enjoy complimentary 24-hour alfresco dining, and all staterooms include a flat-panel television, DVD player and ship-to-shore telephone. You'll sleep soundly on a Mariner's Dream™ bed beneath finely woven cotton linens. And each morning you'll discover the daily satellite edition of *The New York Times*, delivered to your stateroom.

For guests staying in the Penthouse Verandah Suites and Deluxe Verandah Suites, the exclusive Neptune Lounge offers a well-stocked library, coffee, tea and snacks, as well as personal concierge service. And all suite guests have access to convenient, one-touch telephone concierge service, 24 hours a day.

SUPERIOR SHIP FACILITIES

In addition to the incredible range of dining choices, entertainment options and activities, the *ms Maasdam*, *ms Ryndam*, *ms Veendam* and *ms Statendam* provide all the facilities you need to make your voyage everything you'd hope for.

ENRICHING ACTIVITIES

With more than 50 scheduled shipboard activities—from kick-boxing to dancing, wine tasting to art auctions—you're free to do as much or as little as you please. The Explorations Speaker Series, on cruises 10 days or longer, gives you an inside look at the history, culture and traditions of the exciting destinations you'll explore. You can even catch a live sports telecast or watch recent-release movies while you munch free popcorn. Kids have all kinds of age-appropriate activities to choose from, so they can enjoy a (supervised) good time. And teens can relax and socialize with new friends at The Oasis or play the latest video games at The Loft, an indoor teens-only space.

EXCURSIONS AND ONBOARD SERVICES

Planning to explore a destination? We recommend you book online before you depart, but you can also contact the onboard Holland America Shore Excursions office to find out about tour options and exclusive Medallion Shore Excursions. You'll enjoy duty-free shopping at the Signature Shops and specialty wine and gourmet shop. There is also a photo center, laundry and dry-cleaning service and self-serve launderettes. And for peace of mind, we offer a U.S.- or Canadian-trained doctor and nursing staff, along with a full range of FDA-approved medications.

MEETING ROOMS OF ALL SIZES

No matter what size gathering you have in mind, Holland America Line will take care of the details. The four sister ships offer meeting rooms for everything from small seminars and cocktail parties to large presentations. You'll also have access to a full range of audio-visual equipment to meet your needs.

www.hollandamerica.com

SPACIOUS, ELEGANT SHIPS • GRACIOUS, UNOBTRUSIVE SERVICE • WORLDWIDE ITINERARIES
EXTENSIVE ACTIVITIES AND ENRICHMENT PROGRAMS • SOPHISTICATED FIVE-STAR DINING

PUBLIC AND MEETING ROOM CAPACITIES

Rotterdam Dining Room	658	Crow's Nest	216	Meeting Rooms	
Lido Restaurant	226	Ocean Bar	120	Hudson Room	35-60
Pinnacle Grill	60	Explorer's Lounge	61	Half Moon Room	56-90
Main (Show) Lounge	600	Piano Bar	35	Queen's Room	28
Wajang Theater and Culinary Arts Center	210	Explorations Café	85		

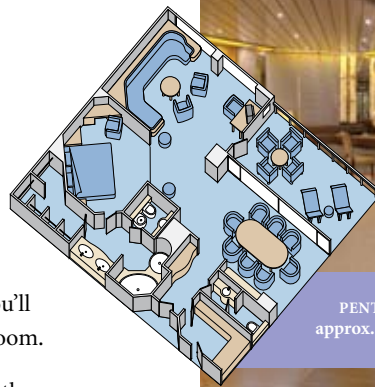

PENTHOUSE VERANDAH SUITE
approx. 1,159 sq. ft. with verandah

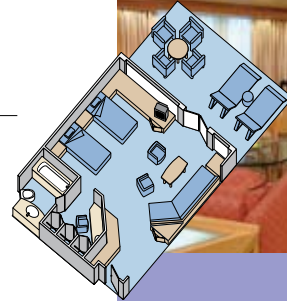

DELUXE VERANDAH SUITE
approx. 556 sq. ft. with verandah



VERANDAH SUITE
approx. 292 sq. ft. with verandah

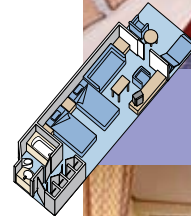

LARGE OUTSIDE DOUBLE
approx. 197 sq. ft.

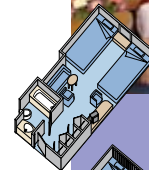

LARGE INSIDE DOUBLE
approx. 182 sq. ft.

NOTE: Room measurements are approximated, and some rooms in the same category may vary in size and/or have different furniture placement from that pictured.

Ships' Registry: The Netherlands

AP15824 Effective July 2006