



7-Day  
Mexican Riviera

*Saturday Departures*

Roundtrip San Diego

2006 SAILING DATES  
 ms Oosterdam: Jan 21, 28;  
 Feb 4, 11, 18, 25;  
 Mar 4, 11, 18, 25;  
 Apr 1, 8, 15, 22;  
 Oct 7, 14, 21, 28;  
 Nov 4, 11, 18, 25;  
 Dec 2, 9, 16

DAY	PORT	ARRIVE	DEPART
Sat	SAN DIEGO, CALIFORNIA		5:00pm
Sun	At sea		
Mon	Cabo San Lucas, Mexico	8:00am	6:00pm
Tue	Mazatlán, Mexico	8:00am	6:00pm
Wed	Puerto Vallarta, Mexico	8:00am	10:00pm
Thu	At sea		
Fri	At sea		
Sat	SAN DIEGO, CALIFORNIA	7:00am	

# Mexico Ports of Call

And a sampling of shore excursions.

## CONTINUED DISCOVERIES

Our shore excursions are designed to bring out the best in each destination, be it nature, history, culture or watersports. Below is a sampling of the adventures we offer in Mexico. To discover our full range of shore excursions and to pre-book your preferences, visit us on line at [www.hollandamerica.com](http://www.hollandamerica.com).

### ACAPULCO, MEXICO

A world-class resort renowned for its beaches, magnificent tropical villas and hotels and, of course, the spectacular divers of La Quebrada. For a thrill of your own, hang on while your jet boat tears through steamy mangrove jungles of Tarzan fame. *Sample shore excursions: Acapulco City Tour with Cliff Divers; Shotover Jet Boat; Dolphin Adventure.*

### CABO SAN LUCAS, MEXICO

At the tip of the Baja Peninsula where the blue Pacific mingles with the Sea of Cortez in a whirl of watercolors. Even more spectacular: waters teeming with marlin, swordfish, sailfish, tuna and other fighting fish. Feast your eyes on exquisite black coral; take in the annual migration of the gray whale. *Sample shore excursions: Deluxe Coastal Cruise with Whale Watching; Half-day Sportfishing Adventure; Sea Kayak & Snorkel Adventure; Beach Horseback Ride.*

### LORETO, MEXICO

This peaceful seaside community, founded in 1697 by Jesuit priest and explorer Juan Maria Salvatierra, was the first European settlement in the Californias. Stroll the cobbled plaza to the Mision Nuestra Señora de Loreta, burnished with years of devotion; commune with nature as you snorkel the crystal-clear lagoons at Isla Coronados. *Sample shore excursions: Loreto Walking Tour; San Javier Mission; Snorkeling at Isla Coronados.*

### MANZANILLO, MEXICO

Like the movie that was filmed here, Manzanillo scores a perfect “10” for the beauty of its beaches and the charm of its town. Farther afield: the Pyramids of La Campana, dating back to the first century; and the charming colonial towns of Colima and Comala, where tropical gardens and the sounds of mariachi bands make for a *muy tranquilo* afternoon. *Sample shore excursions: Colima & Comala with Lunch; Manzanillo City & Shopping; Resort Getaway.*

### MAZATLÁN, MEXICO

Home of the largest shrimp fleet in the world, this cosmopolitan resort city tempts with every variation of this tasty crustacean: grilled, *al mojo de ajo* (with garlic), or in the shell with a tangy squeeze of lime. Other temptations: miles of uninterrupted sandy beaches, busy markets, and sleepy mining towns tucked into the Sierra Madre. *Sample shore excursions: Deluxe City Tour with Papantla Fliers; Old Mazatlán Walking Tour; Deer Island Kayak; Sierra Madre; Concordia & Copala.*

### PICHILINGUE (LA PAZ), MEXICO

A tranquil way of life abounds in La Paz, which means “peace.” Among its simple pleasures: strolling the palm-shaded *malecón*, lazing on the beautiful beaches of nearby Pichilingue Peninsula, snorkeling sapphire seas at lovely Los Islotes, home to a colony of inquisitive sea lions. *Sample shore excursions: Snorkeling at Los Islotes; Highlights of La Paz.*

### PUERTO VALLARTA, MEXICO

No longer the well-kept secret of the artists, writers and Hollywood stars who first “discovered” it in the 1960s, “PV” (as it is affectionately known) still retains the essence of the quaint fishing village it once was. Here is Viejo Vallarta, the quaint old town with its cobblestone streets, red-tiled roofs and bustling market. Here are Mismaloya Beach, Gringo Gulch and Conchas Chinas, the Beverly Hills of Vallarta. *Sample shore excursions: Countryside on Horseback; San Sebastian Flight with Lunch; Dolphin Encounter; Town, Country & Tequila.*



Loreto, Mexico

**SIERRA DE LA GIGANTA  
(SCENIC CRUISING)**

Between Loreto and La Paz witness one of earth's most spectacular scenes: Sierra de la Giganta, a mass of steeply rumpled terra-cotta velvet that unfolds into the rich, blue waters of the Sea of Cortez. Best viewed while lunching on the private verandah of your spacious suite.

**TOPOLOBAMPO, MEXICO**

Located on a splendid deep-water bay where bottlenose dolphins play, seabirds nest and sea lions migrate each winter. Just minutes away is Los Mochis, built on the sweet profits of sugar and the grand visions of the Chihuahua-al-Pacifico Railway, providing luxury rail through Mexico's spectacular Copper Canyon. *Sample shore excursions: Bay, Birds & Dolphin Cruise; The Copper Canyon by Train; Colonial City of El Fuerte; Los Mochis City, Gardens & Shopping.*

**ZIHUATANEJO, MEXICO**

One stop gives you the best of both worlds: Zihuatanejo, a tranquil fishing village set in a scenic, sheltered bay where artisans and fishermen work as they have for centuries; and Ixtapa, a modern resort just five miles away but a world apart, with high-rise hotels, broad palm-lined boulevards and a world-class golf course. *Sample shore excursions: Zihuatanejo Sail & Snorkel; Ixtapa Resort Tour; Isla Ixtapa.*

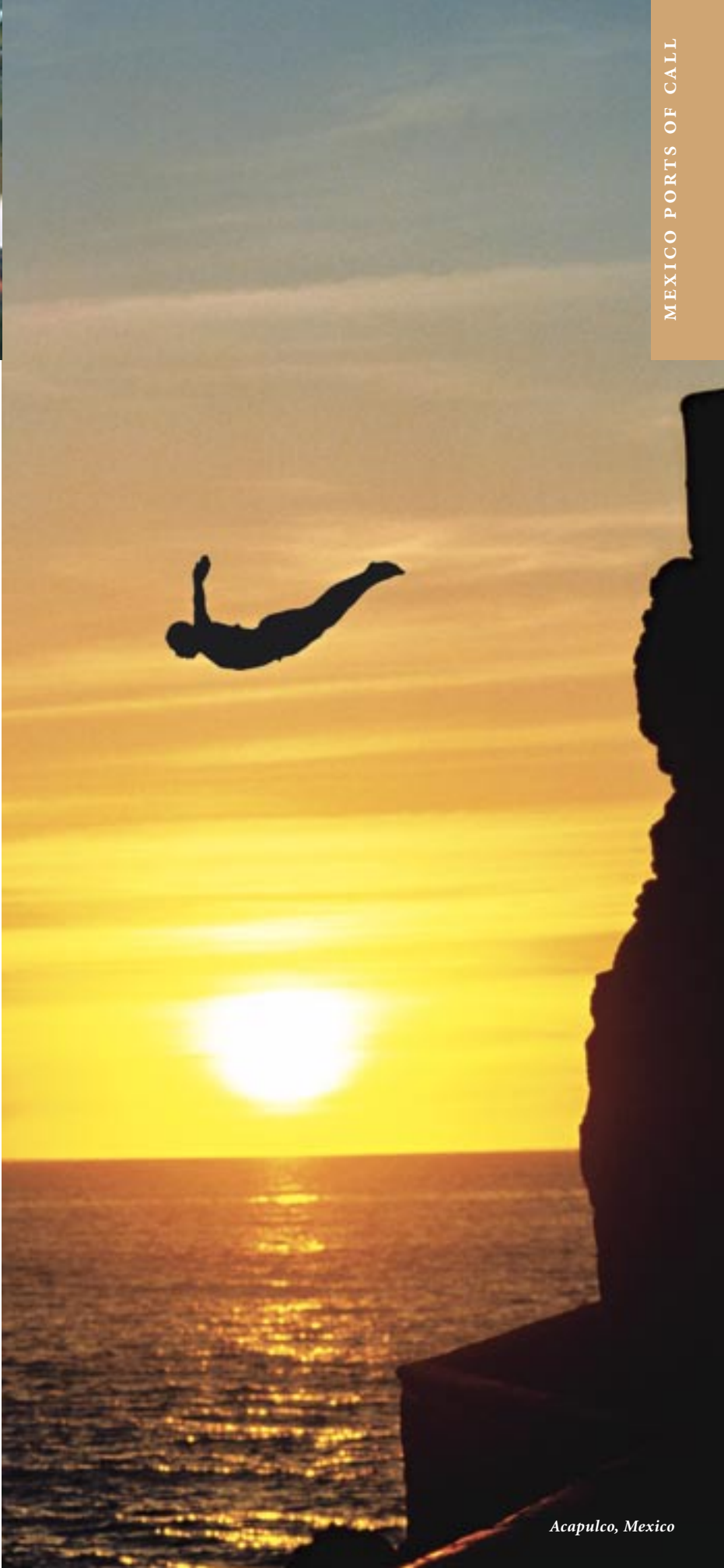



Guatemala

**PARINTINS, BRAZIL**

One of hundreds of small villages scattered along the banks of the Amazon, inhabited by natives who are half-Portuguese and half-Indian — *caboclos* — and who survive by hunting, fishing and growing maize, cassava and cotton. *Sample shore excursions: Boi-Bumba Festival Show; Parintins by Tricycle.*

**PICHILINGUE (LA PAZ), MEXICO**

A tranquil way of life abounds in La Paz, which means “peace.” Among its simple pleasures: strolling the palm-shaded *malecón*, lazing on the beautiful beaches of nearby Pichilingue Peninsula, snorkeling sapphire seas at lovely Los Islotes, home to a colony of inquisitive sea lions. *Sample shore excursions: Snorkeling at Los Islotes; Highlights of La Paz.*

**PUERTO CALDERA, COSTA RICA**

A jumping-off point for Costa Rica’s wonders. Ride an aerial tram through the rain forest canopy or take in the dazzling Jade and Gold Museum in San José. *Sample shore excursions: Tropical Forest Aerial Tram; Skywalk in the Forest; Arenal Volcano & Thermal Waters; San José All-day Tour.*

**PUERTO LIMÓN/PUERTO MOIN, COSTA RICA**

Adventure awaits in the land of perpetual springtime. Go in search of iridescent blue morpho butterflies, wise old shamans, jade and gold museums. *Sample shore excursions: Rio Reventazon White-water Rafting; Rain Forest Aerial Tram; San José Town & Country.*

**PUERTO QUETZAL, GUATEMALA**

Adventure awaits in the cultured little country of Guatemala: colonial Antigua; Lake Atitlan, where modern Maya still weave their stories on backstrap looms; and Tikal, where a secretive jungle plaza is flanked by seven great stone temples. *Sample shore excursions: Mayan Ruins of Tikal; Panajachel, Lake Atitlan & Highlands; Coffee Plantation Tour; Casa Santo Domingo & Antigua.*

**PUERTO VALLARTA, MEXICO**

The quintessential Mexican resort renowned for its cobbled streets, beautiful bay and the luxurious villas of Gringo Gulch. *Sample shore excursions: Dolphin Encounter; Town, Country & Tequila; Sierra Madre Expedition.*

**PUNTARENAS, COSTA RICA**

Yet another chance to witness the wonders of eco-rich Costa Rica. Here find nearly half of all the animal species on earth, truly earning Costa Rica the title of “rich coast.” *Sample shore excursions: Tropical Mangrove River Cruise; Poas Volcano & Cloud Forest; Sarchi & the Artisans of Costa Rica.*

**THE MEDALLION COLLECTION**

Holland America Line is proud to present the Medallion Collection, a series of exclusive tours designed to accommodate our most discerning guests. Each has been carefully chosen to offer a truly different experience, providing an in-depth perspective and unparalleled access to events and sights not otherwise available. For more details, visit us online at [www.hollandamerica.com](http://www.hollandamerica.com).

**ROAD TOWN, TORTOLA  
BRITISH VIRGIN ISLANDS**

An enticing mix of pink and blue buildings, yachts, rum cocktails and pirate lore. *Sample shore excursions: Cane Garden Beach; The North Shore & Pusser’s Landing; Virgin Gorda & The Baths; Swim with the Dolphins.*

**ROATÁN, BAY ISLANDS,  
HONDURAS**

Get ready for lizards that run upright on their hind legs, brilliant macaws and parrots found only here, a reef second in size only to Australia’s Great Barrier Reef. *Sample shore excursions: Catamaran Sail & Snorkel; Dive with Sharks; Roatán West Side Island Tour.*

**ST. GEORGE’S, GRENADA**

The heady scent of nutmeg, cinnamon and cloves turns the simple act of breathing into an exotic experience. Here, too, find mountain waterfalls, white sand beaches and lagoons of mottled blues. *Sample shore excursions: Star Wind Catamaran & Snorkel Adventure; Nature Trail & Beach Swim.*



*Puerto Caldera (Arenal), Costa Rica*

**ST. THOMAS,  
U.S. VIRGIN ISLANDS**

The place for your duty-free shopping spree. Cameras, crystal and perfume are all here. So are beautiful beaches, undersea gardens and calypso harbor cruises. *Sample shore excursions: Champagne Catamaran Sail & Snorkel to St. John; Sea Trekking Helmet Dive & Coral World.*

**SAN BLAS ISLANDS, PANAMA**

Home of the Cuna Indians, a warmly hospitable people famous for their finely sewn, tropically colored *molas*. Organized shore excursions are not available here, but the thatched-hut villages and silken beaches are easily explored on your own.

**SAN JUAN DEL SUR, NICARAGUA**

This lovely beach town is your portal to Masaya, famous for its steaming volcano and colorful crafts market; and colonial Granada on the shores of Lago de Nicaragua, dotted with hundreds of lush volcanic islands. *Sample shore excursions: Granada; Masaya Volcano & Craft Market; Spanish Horses & Coffee; Masaya Shopping Tour.*

**SAN JUAN, PUERTO RICO**

Massive El Morro Fortress guards Old San Juan, as it has for nearly 500 years, while the benevolent Indian spirit Yuquiye keeps watch over the entire island from the highest peak in the rain forest. *Sample shore excursions: Old San Juan Historic Walking Tour; El Yunque Rain Forest Drive.*

**SANTA BÁRBARA DE SAMANÁ,  
DOMINICAN REPUBLIC**

Rich in amber, Taino Indian culture and breathtaking natural history, including Bahía de Samaná, mating and birthing grounds for thousands of humpback whales. *Sample shore excursions: Los Haitises National Park; Samaná Scenic 4x4 Safari.*

**SANTA CRUZ HUATULCO,  
MEXICO**

Tranquil and under-discovered, Huatulco is situated around nine pristine bays featuring water in every shade of blue. Nearby: whitewater rapids and endangered turtle nesting grounds. *Sample shore excursions: Five Bays by Catamaran; Horseback Riding; Copalita River Float Trip; Bird-watching Eco-Tour.*

**SANTARÉM, BRAZIL**

A lively trading center on the Amazon (Ford invested millions in rubber here in the 1920s). Santarém is where the mud-brown Amazon meets the blue waters of the Rio Tapajos. *Sample shore excursions: Tapajos River & Jari Canal Boat Tour; Tapajos National Forest Tour.*

**VICTORIA, BRITISH COLUMBIA**

A bit of England awaits: afternoon tea, red double-decker buses, shops brimming with bone china, tartans and toffee. *Sample shore excursions: Butchart Gardens & Short City Drive; Victoria by Horse-drawn Trolley; Victoria Ale, Trail & Pub Tour; Grand City Drive & Empress High Tea; Victoria Highlights & Craigdarroch Castle.*

**WILLEMSTAD, CURAÇAO**

Amsterdam-like canals, gabled Dutch colonial buildings, an exotic floating market. This bustling duty-free port has it all. Plus the world-famous Curaçao Liqueur Distillery and an intriguing coral reef. *Sample shore excursions: Spanish Water Snorkel Expedition; Curaçao See & Sea Tour; Highlights of Curaçao with Folkloric Show; Canoe Safari; Willemstad Trolley Train.*

# ms Noordam ms Westerdam ms Oosterdam ms Zuiderdam



ms Oosterdam Vista Show Lounge

ms Westerdam Hydro Pool

Spacious and airy, our new Vista-class ships offer all the amenities and comforts demanded by today's sophisticated travelers: more verandah staterooms, more dining choices, more understated elegance.

## SHIP FEATURES

- Elegant two-tiered Dining Room, intimate reservations-only restaurant, poolside Terrace Grill, casual Windstar Café and the Lido Restaurant with its relaxed culinary courtyard
- Two outdoor swimming pools, The Greenhouse Spa & Salon, fitness center, golf simulator
- State-of-the-art show lounge, Casino, Nightclub, Internet Center
- Exclusive lounge and concierge service for guests staying in Penthouse and Deluxe Verandah Suites

## SUITE AMENITIES

For guests choosing suite accommodations, Holland America Line offers a host of complimentary services that will forever spoil you for any other stateroom.

## SUPERIOR VERANDAH SUITES (CATEGORIES SS—SZ)

- Personalized cruise stationery
- Elegant bathrobe for use on your cruise
- Fresh flowers and fruit assortment
- Luxurious beds featuring Sealy® Premium Euro-Top mattresses and finely woven cotton linens

- A no-host mini-bar for easy entertaining in your suite
- DVD player and access to an extensive DVD library

## PENTHOUSE VERANDAH SUITES (CATEGORY PS) AND DELUXE VERANDAH SUITES (CATEGORIES SA—SC)

- Includes all the Superior Verandah Suite amenities, plus:
- Use of the exclusive Neptune Lounge and personal concierge service
  - Complimentary laundry, pressing and dry cleaning throughout your cruise
  - Premium duvet, oversize bath towels and soft cotton bathrobes
  - Gorgeous corsages and boutonnieres for the first formal night
  - Hors d'oeuvres served before dinner each evening on request
  - Binoculars and umbrellas for your use on the cruise
  - VIP party with the Captain
  - Priority boarding for tender ports of call





*ms Noordam*

*The Pinnacle Grill at the Odyssey*



# ms Noordam ms Westerdam ms Oosterdam ms Zuiderdam

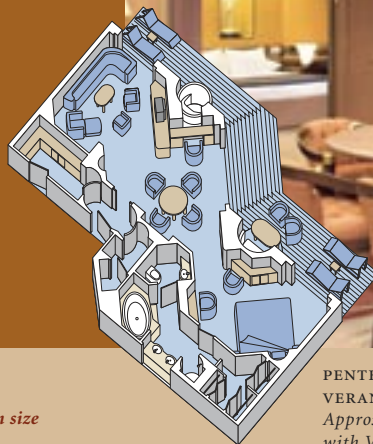

PENTHOUSE  
VERANDAH SUITE  
Approx. 1,318 sq. ft.  
with Verandah

NOTE: Room measurements are approximate, and some rooms in the same category may vary in size and/or have different furniture placement from that pictured.

column 1

## 7- TO 11-DAY CARIBBEAN 2005/2006/2007

	2005 Eastern/Western ms Westerdam/ms Zuiderdam 7-Day		2006/2007 Bahamas ms Westerdam 5-Day		2006/2007 Eastern/Western ms Westerdam/ms Zuiderdam 7-Day		2006/2007 Eastern ms Noordam 10-Day		2006/2007 Southern ms Noordam 11-Day		2005 Holiday Eastern/Western ms Westerdam 8-Day	
VERANDAH STATEROOMS	ES FROM	ES TO	ES	ES FROM	ES TO	ES FROM	ES TO	ES FROM	ES TO	ES FROM	ES TO	
PS Penthouse Verandah Suites	\$4,049	– \$6,049	\$3,559	\$3,944	– \$6,034	\$7,169	– \$9,269	\$7,169	– \$10,319	\$14,069	– \$14,969	
SA Deluxe Verandah Suites	1,942	– 2,867	2,229	2,434	– 3,414	4,299	– 5,229	4,299	– 5,699	6,389	– 7,289	
SB Deluxe Verandah Suites	N/A	N/A	1,979	2,184	– 3,164	3,799	– 4,729	3,799	– 5,199	5,639	– 6,539	
SC Deluxe Verandah Suites	N/A	N/A	1,729	1,934	– 2,914	3,299	– 4,229	3,299	– 4,699	4,889	– 5,789	
SS Superior Verandah Suites	1,349	– 1,979	1,409	1,614	– 2,314	2,699	– 3,359	2,699	– 3,689	3,849	– 4,749	
SY Superior Verandah Suites	N/A	N/A	1,249	1,399	– 2,114	2,399	– 3,059	2,399	– 3,389	3,399	– 4,299	
SZ Superior Verandah Suites	N/A	N/A	N/A	N/A	N/A	N/A	N/A	N/A	N/A	N/A	N/A	
VA Deluxe Verandah Outside	1,109	– 1,609	979	1,169	– 1,639	2,109	– 2,579	2,109	– 2,809	1,989	– 2,429	
VB Deluxe Verandah Outside	1,085	– 1,572	959	1,134	– 1,604	2,039	– 2,509	2,039	– 2,739	1,949	– 2,389	
VC Deluxe Verandah Outside	1,060	– 1,535	939	1,099	– 1,569	1,969	– 2,439	1,969	– 2,669	1,909	– 2,349	
VD Deluxe Verandah Outside	1,036	– 1,498	919	1,064	– 1,534	1,899	– 2,369	1,899	– 2,599	1,869	– 2,309	
VE Deluxe Verandah Outside	999	– 1,461	899	1,029	– 1,499	1,829	– 2,299	1,829	– 2,529	1,829	– 2,269	
VF Deluxe Verandah Outside	N/A	N/A	849	999	– 1,464	1,749	– 2,229	1,749	– 2,459	1,799	– 2,229	
VH Deluxe Verandah Outside	N/A	N/A	N/A	N/A	N/A	N/A	N/A	N/A	N/A	N/A	N/A	
<b>OCEAN-VIEW STATEROOMS</b>												
C Large	984	– 1,420	839	979	– 1,339	1,749	– 2,109	1,749	– 2,289	1,579	– 1,979	
D Large	964	– 1,391	819	954	– 1,314	1,699	– 2,059	1,699	– 2,239	1,539	– 1,939	
DD Large	945	– 1,361	799	929	– 1,289	1,649	– 2,009	1,649	– 2,189	1,499	– 1,899	
E Large	928	– 1,335	779	904	– 1,264	1,599	– 1,959	1,599	– 2,139	1,459	– 1,859	
F Large	903	– 1,298	759	879	– 1,239	1,549	– 1,909	1,549	– 2,089	1,419	– 1,819	
G Large	849	– 1,261	739	854	– 1,214	1,499	– 1,859	1,499	– 2,039	1,379	– 1,779	
GG Large	N/A	N/A	719	829	– 1,189	1,449	– 1,809	1,449	– 1,989	1,339	– 1,739	
H Large	N/A	N/A	699	799	– 1,164	1,399	– 1,759	1,399	– 1,939	1,299	– 1,699	
HH Large	N/A	N/A	N/A	N/A	N/A	N/A	N/A	N/A	N/A	N/A	N/A	
<b>INSIDE STATEROOMS</b>												
I Large	820	– 1,172	674	799	– 1,099	1,374	– 1,674	1,374	– 1,824	1,249	– 1,549	
J Large	800	– 1,143	659	779	– 1,079	1,339	– 1,639	1,339	– 1,789	1,219	– 1,519	
K Large	776	– 1,106	644	759	– 1,059	1,304	– 1,604	1,304	– 1,754	1,189	– 1,489	
L Standard	761	– 1,084	629	739	– 1,039	1,269	– 1,569	1,269	– 1,719	1,159	– 1,459	
M Standard	737	– 1,047	614	719	– 1,019	1,234	– 1,534	1,234	– 1,684	1,129	– 1,429	
<b>MM Standard ("From" Price)</b>	<b>699</b>	<b>– 999</b>	<b>599</b>	<b>699</b>	<b>– 999</b>	<b>1,199</b>	<b>– 1,499</b>	<b>1,199</b>	<b>– 1,649</b>	<b>1,099</b>	<b>– 1,399</b>	
N Standard	N/A	N/A	N/A	N/A	N/A	N/A	N/A	N/A	N/A	N/A	N/A	
NN Standard	N/A	N/A	N/A	N/A	N/A	N/A	N/A	N/A	N/A	N/A	N/A	
* 3rd/4th Person Adult	499	699	370	545	545	780	780	870	870	1,060	1,060	
* 3rd/4th Person Child (2–18)	399	599	370	445	445	780	780	870	870	1,060	1,060	
* Infant – Under Age 2	304	504	260	305	305	450	450	450	450	410	410	
■ Non-Discountable Amount INCLUDED	129	129	110	155	155	200	200	200	200	160	160	
● Taxes	78.88	78.88	51.67	67.77	67.77	84.77	84.77	88.27	88.27	86.64	86.64	
Deposit Requirement	350	350	350	350	350	600	600	600	600	350	350	



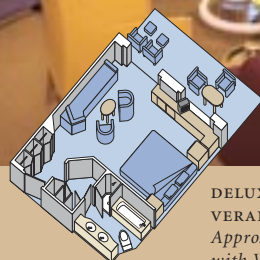

**DELUXE  
VERANDAH SUITE**  
Approx. 510 sq. ft.  
with Verandah

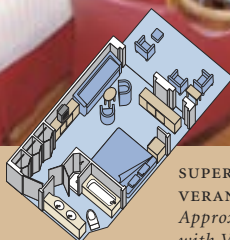
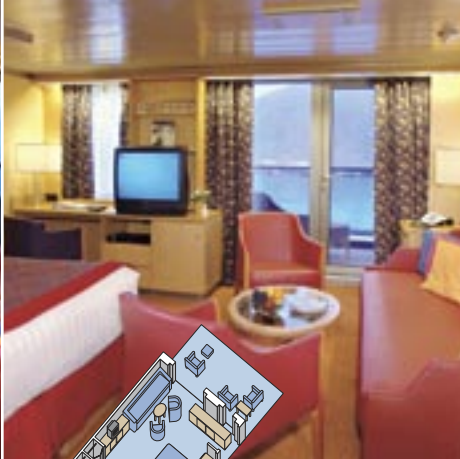

**SUPERIOR  
VERANDAH SUITE**  
Approx. 389 sq. ft.  
with Verandah

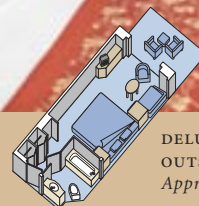

**DELUXE VERANDAH  
OUTSIDE DOUBLE**  
Approx. 249 sq. ft.

## column 2

## 5- TO 8-DAY MEXICO 2005/2006/2007

2005 Holiday Eastern ms Zuiderdam 8-Day		2005 Sea of Cortez ms Oosterdam 5-Day		2005 Mexican Riviera ms Oosterdam 7-Day		2006/2007 Mexican Riviera ms Oosterdam 7-Day		2005 Holiday Mexican Riviera/Sea of Cortez ms Oosterdam 8-Day		
ES FROM	ES TO	ES	ES FROM	ES TO	ES FROM	ES TO	ES FROM	ES TO	ES FROM	ES TO
\$14,169	– \$14,269	\$2,796	\$3,910	– \$5,030	\$3,884	– \$6,024	\$14,169	– \$14,269		
6,489	– 6,589	1,352	1,889	– 2,407	2,814	– 3,764	6,489	– 6,589		
5,739	– 5,839	N/A	N/A	N/A	2,314	– 3,264	5,739	– 5,839		
4,989	– 5,089	N/A	N/A	N/A	1,814	– 2,764	4,989	– 5,089		
3,949	– 4,049	949	1,299	– 1,675	1,484	– 2,154	3,949	– 4,049		
3,499	– 3,599	N/A	N/A	N/A	1,349	– 1,999	3,499	– 3,599		
N/A	N/A	N/A	N/A	N/A	N/A	N/A	N/A	N/A		
2,089	– 2,189	781	1,090	– 1,370	1,169	– 1,624	2,089	– 2,189		
2,049	– 2,149	765	1,067	– 1,340	1,134	– 1,589	2,049	– 2,149		
2,009	– 2,109	748	1,043	– 1,309	1,099	– 1,554	2,009	– 2,109		
1,969	– 2,069	731	1,020	– 1,279	1,064	– 1,519	1,969	– 2,069		
1,929	– 2,029	699	999	– 1,248	1,029	– 1,484	1,929	– 2,029		
1,899	– 1,989	N/A	N/A	N/A	999	– 1,449	1,899	– 1,989		
N/A	N/A	N/A	N/A	N/A	N/A	N/A	N/A	N/A		
1,679	– 1,779	696	970	– 1,214	979	– 1,324	1,679	– 1,779		
1,639	– 1,739	682	951	– 1,190	954	– 1,299	1,639	– 1,739		
1,599	– 1,699	669	933	– 1,166	929	– 1,274	1,599	– 1,699		
1,559	– 1,659	657	916	– 1,144	904	– 1,249	1,559	– 1,659		
1,519	– 1,619	640	893	– 1,114	879	– 1,224	1,519	– 1,619		
1,479	– 1,579	599	849	– 1,083	854	– 1,199	1,479	– 1,579		
1,439	– 1,539	N/A	N/A	N/A	829	– 1,174	1,439	– 1,539		
1,399	– 1,499	N/A	N/A	N/A	799	– 1,149	1,399	– 1,499		
N/A	N/A	N/A	N/A	N/A	N/A	N/A	N/A	N/A		
1,349	– 1,449	583	813	– 1,010	799	– 1,099	1,349	– 1,449		
1,319	– 1,419	570	794	– 986	779	– 1,079	1,319	– 1,419		
1,289	– 1,389	553	770	– 955	759	– 1,059	1,289	– 1,389		
1,259	– 1,359	543	756	– 937	739	– 1,039	1,259	– 1,359		
1,229	– 1,329	526	733	– 906	719	– 1,019	1,229	– 1,329		
<b>1,199</b>	<b>– 1,299</b>	<b>499</b>	<b>699</b>	<b>– 869</b>	<b>699</b>	<b>– 999</b>	<b>1,199</b>	<b>– 1,299</b>		
N/A	N/A	N/A	N/A	N/A	N/A	N/A	N/A	N/A		
N/A	N/A	N/A	N/A	N/A	N/A	N/A	N/A	N/A		
1,060	1,060	360	520	520	545	545	1,060	1,060		
1,060	1,060	360	420	420	445	445	1,060	1,060		
410	410	210	300	300	305	305	410	410		
160	160	110	150	150	155	155	160	160		
66.40	66.40	49.66	74.04	74.04	58.18	58.18	67.18	67.18		
350	350	350	350	350	350	350	350	350		

Fares in U.S. dollars per person based on double occupancy.

✦ Fares are available in Canadian dollars. Please see your travel agent for details.

\* Based on sharing accommodations with two full-fare guests.

■ Non-Discountable Amounts are included in fares presented.

● Taxes are additional.

Single Partners Program: categories F and K.

Single Occupancy: categories PS–VF at 190% of double occupancy; categories C–NN at 150% of double occupancy.

#### 2005

Single Partners Program: categories F and K.

Single Occupancy: categories PS–VH at 190% of double occupancy; categories C–NN at 150% of double occupancy.

#### 2006

Single Partners Program: categories D and K.

Single Occupancy: categories PS–VH at 190% of double occupancy; categories C–NN at 150% of double occupancy.

**2006 Holiday Fares available upon request.**

**Early Savings (ES):** The fares shown are early savings fares and are subject to change. Book early to ensure the best possible rate.

**MAIN DECK**  
Staterooms 1001-1127  
252 ft. from bow  
to Staterooms 1001 & 1002.

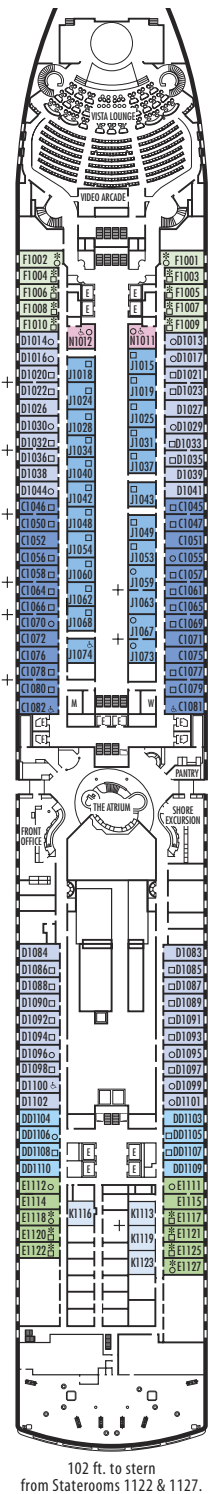

**LOWER PROMENADE DECK**

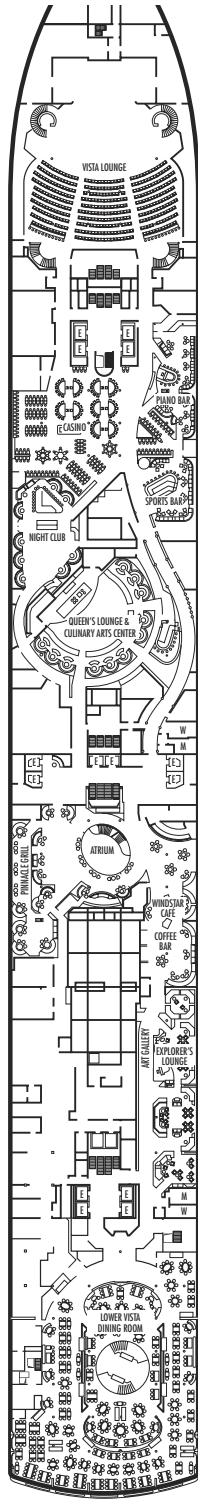

**PROMENADE DECK**

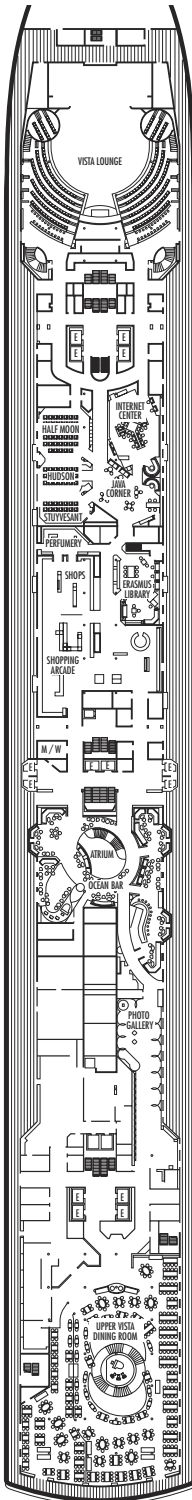

**UPPER PROMENADE DECK**  
Staterooms 4001-4185  
1022 ft. from bow  
to Staterooms 4001 & 4002.

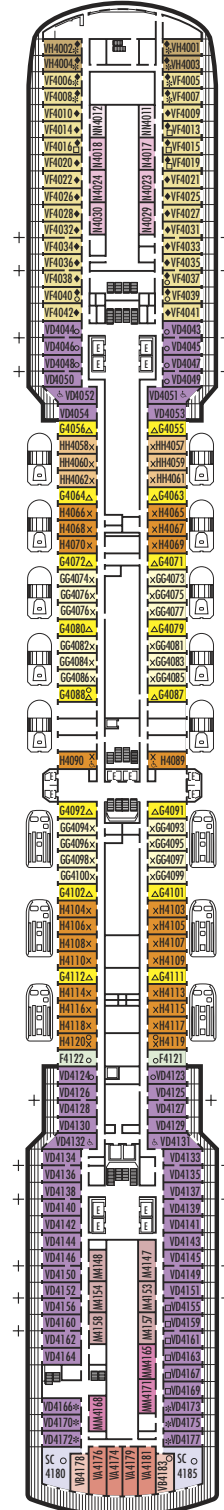

**VERANDAH DECK**  
Staterooms 5001-5187  
102 ft. from bow  
to Staterooms 5001 & 5002.

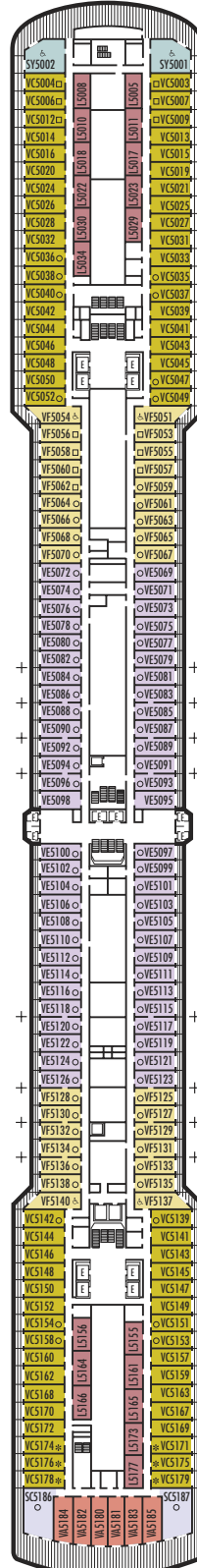

**UPPER VERANDAH DECK**  
Staterooms 6001-6169  
112 ft. from bow  
to Staterooms 6003 & 6004.

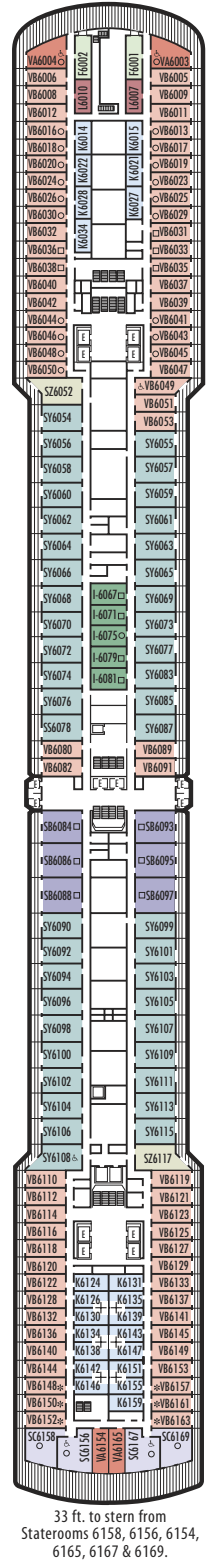

**SHIP SPECIFICATIONS & FACILITIES**

- 1,848 Guests
- 82,000 Gross Tons
- 950 Feet Long
- Automatic Stabilizers
- 11 Guest Decks
- 14 Guest Elevators
- 4 Outside Elevators
- 24 Public Rooms
- 4 Restaurants
- Outdoor Swimming Pools (one with sliding glass roof)
- Spa & Salon
- Two Show Lounges
- Duty-free Shops
- Library
- Casino
- Fitness Center
- Basketball Court
- Volleyball Court
- Golf Simulator
- Internet Center
- Suite Lounge

**ROTTERDAM DECK**  
Staterooms 7001-7133  
121 ft. from bow  
to Staterooms 7001 & 7002.

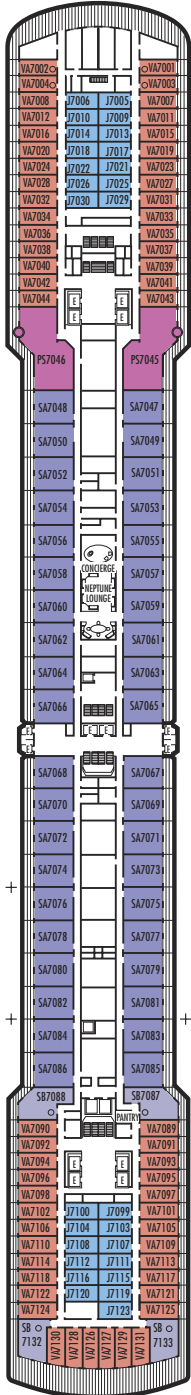

56 ft. to stern from Staterooms 7132, 7130, 7128, 7126, 7127, 7129, 7131 & 7133.

**NAVIGATION DECK**  
Staterooms 8001-8135  
186 ft. from bow  
to Staterooms 8001 & 8002.

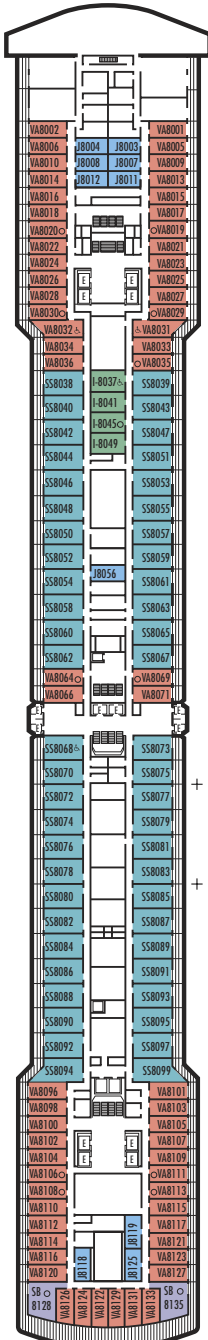

68 ft. to stern from Staterooms 8128, 8126, 8124, 8122, 8129, 8131, 8133, & 8135.

**LIDO DECK**

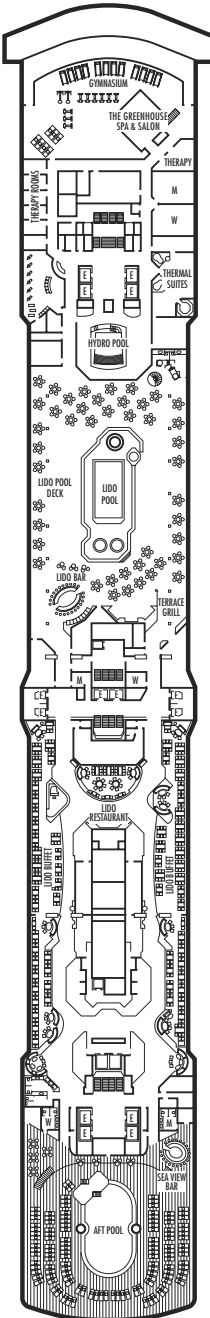

**OBSERVATION DECK**

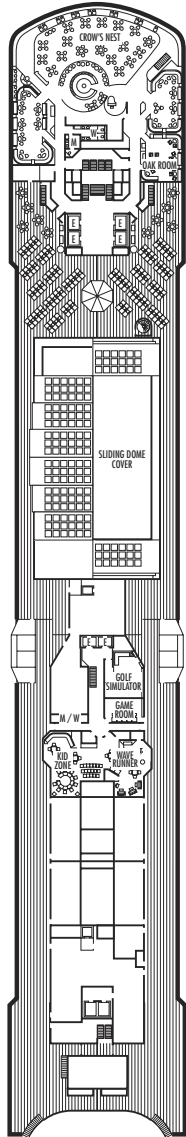

**SPORTS DECK**

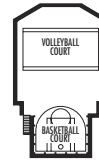
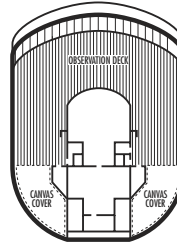

**ms Westerdam**  
**ms Oosterdam**  
**ms Zuiderdam**  
**ms Noordam**

**DECK PLANS & STATEROOMS**

The deck plans are color-coded by category of stateroom, and the category letter precedes the stateroom number in each room. All staterooms are equipped with television, mini-bar, DVD player\*, mini-safe, data port, telephone and multi-channel music.

**Important Note:** Not all staterooms within each category have the same furniture configuration and/or facilities. Appropriate symbols within the rooms on the deck plans describe differences from the stateroom descriptions below.

**VERANDAH SUITES**

**PS**  
**Penthouse Verandah Suites:** Bedroom with 1 king-size bed, oversize whirlpool bath & shower & additional shower stall, living room, dining room, dressing room, private verandah with whirlpool, pantry, 1 sofa bed for 2 persons, microwave, refrigerator, guest toilet, private stereo system, floor-to-ceiling windows.

**SA SB SC**  
**Deluxe Verandah Suites:** 2 lower beds convertible to 1 king-size bed, bathroom with dual sink vanity, full-size whirlpool bath & shower & additional shower stall, large sitting area, dressing room, private verandah, 1 sofa bed for 2 persons, floor-to-ceiling windows.

**SS SY SZ**  
**Superior Verandah Suites:** 2 lower beds convertible to 1 queen-size bed, bathroom with dual sink vanity, full-size whirlpool bath & shower & additional shower stall, large sitting area, dressing room, private verandah, 1 sofa bed for 1 person, floor-to-ceiling windows.

**VERANDAH STATEROOMS**

**VA VB VD VE**  
**Deluxe Verandah Outside:** 2 lower beds convertible to 1 queen-size bed, bath & shower, sitting area, private verandah, floor-to-ceiling windows.

**VC VF VH**  
**Deluxe Verandah Outside:** 2 lower beds convertible to 1 queen-size bed, bath with tub or shower, sitting area, private verandah, floor-to-ceiling windows.

**OUTSIDE STATEROOMS**

**C D DD E F**  
**Large:** 2 lower beds convertible to 1 queen-size bed, bathtub & shower.

**G GG**  
**Large:** 2 lower beds convertible to 1 queen-size bed, bathtub & shower. All G-category staterooms have partial sea views. All GG-category staterooms have fully obstructed views.

**H HH**  
**Large:** 2 lower beds convertible to 1 queen-size bed, bathtub & shower. All H- & HH-category staterooms have fully obstructed views.

**INSIDE STATEROOMS**

**I**  
**Large:** 2 lower beds convertible to 1 queen-size bed, shower.

**J K**  
**Large or Standard:** 2 lower beds convertible to 1 queen-size bed, shower.

**L M MM N NN**  
**Standard:** 2 lower beds convertible to 1 queen-size bed, shower.

\*DVD players will be available in all staterooms for ms Westerdam after April 27, 2005; ms Zuiderdam after December 22, 2005; ms Oosterdam after October 3, 2006. Currently, categories PS-SZ have DVD players. All other categories are equipped with televisions only.

For sailings prior to Holiday 2005 please see the Holland America website at [www.hollandamerica.com](http://www.hollandamerica.com) for stateroom category information.

**STATEROOM SYMBOL LEGEND**

- \* Shower only
- Triple (2 lower beds, 1 sofa bed)
- Quad (2 lower beds, 1 sofa bed, 1 upper)
- △ Partial sea view
- × Fully obstructed view
- ✚ Connecting rooms
- ◆ Staterooms have solid steel verandah railing instead of clear-view Plexiglas railing
- ♿ Staterooms SC6156, SC6167, SY5001, SY5002, SY6108, SS8068, VA6003, VA6004, VA8031, VA8032, VB6049, VD4051, VD4052, VD4131, VD4132, VF5051, VF5054, VF5137, VF5140, C1081, C1082, D1100, H4089, H4090, I-8037, J1074, N1011, N1012 are wheelchair accessible, shower only.

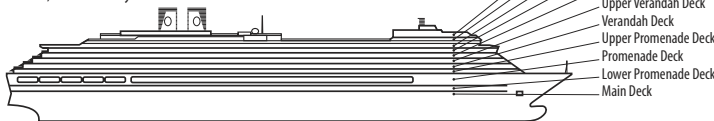

# Hotel Packages

A few extra days to relax and enjoy.

## PRE- AND POST-CRUISE HOTEL ACCOMMODATIONS

### ACAPULCO, MEXICO

ACAPULCO PRINCESS 2005	1 NIGHT	2 NIGHTS	3 NIGHTS
Shared Double	us\$100	us\$170	us\$240
Single Occupancy	165	305	445
3rd Person	65	95	125
2006	1 NIGHT	2 NIGHTS	3 NIGHTS
Shared Double	us\$115	us\$195	us\$275
Single Occupancy	195	350	505
3rd Person	65	95	125

### FT. LAUDERDALE, FLORIDA

HYATT REGENCY PIER 66 HOTEL Apr 1 – 30, and Oct 1 – Dec 25, 2005	1 NIGHT	2 NIGHTS	3 NIGHTS
Shared Double	us\$115	us\$210	us\$305
Single Occupancy	210	400	590
3rd Person	35	50	65
May 1 – Sep 30, 2005	1 NIGHT	2 NIGHTS	3 NIGHTS
Shared Double	us\$95	us\$170	us\$245
Single Occupancy	170	320	470
3rd Person	35	50	65

### FT. LAUDERDALE MARINA MARRIOTT

2006	1 NIGHT	2 NIGHTS	3 NIGHTS
Shared Double	us\$120	us\$220	us\$320
Single Occupancy	220	420	620
3rd Person	20	20	20

### WESTIN FT. LAUDERDALE

2005	1 NIGHT	2 NIGHTS	3 NIGHTS
Shared Double	us\$65	us\$110	us\$155
Single Occupancy	110	200	290
3rd Person	25	35	45
2006	1 NIGHT	2 NIGHTS	3 NIGHTS
Shared Double	us\$60	us\$105	us\$150
Single Occupancy	105	195	285
3rd Person	20	30	40

### LOS ANGELES, CALIFORNIA

WESTIN LONG BEACH 2005	1 NIGHT	2 NIGHTS	3 NIGHTS
Shared Double	us\$105	us\$175	us\$245
Single Occupancy	170	310	450
3rd Person	65	95	125
2006	1 NIGHT	2 NIGHTS	3 NIGHTS
Shared Double	us\$90	us\$160	us\$230
Single Occupancy	160	300	440
3rd Person	45	75	105

### NEW YORK, NEW YORK

HILTON TOWERS NEW YORK* Jan 1 – Mar 31, 2006	1 NIGHT	2 NIGHTS	3 NIGHTS
Shared Double	us\$190	us\$305	us\$420
Single Occupancy	305	535	765
3rd Person	100	130	160
Apr 1 – May 31, 2006	1 NIGHT	2 NIGHTS	3 NIGHTS
Shared Double	us\$210	us\$350	us\$490
Single Occupancy	345	625	905
3rd Person	100	130	160
Sep 1 – Nov 30, 2006	1 NIGHT	2 NIGHTS	3 NIGHTS
Shared Double	us\$255	us\$435	us\$615
Single Occupancy	435	795	1,155
3rd Person	115	160	205
Dec 1 – Dec 31, 2006	1 NIGHT	2 NIGHTS	3 NIGHTS
Shared Double	us\$270	us\$470	us\$670
Single Occupancy	470	870	1,270
3rd Person	100	130	160

### NORFOLK, VIRGINIA

NORFOLK MARRIOTT WATERSIDE 2005	1 NIGHT	2 NIGHTS	3 NIGHTS
Shared Double	us\$110	us\$185	us\$260
Single Occupancy	185	335	485
3rd Person	35	35	35
2006	1 NIGHT	2 NIGHTS	3 NIGHTS
Shared Double	us\$125	us\$195	us\$265
Single Occupancy	200	340	480
3rd Person	50	50	50

### PORTLAND, OREGON

PORTLAND MARRIOTT CITY CENTER 2006	1 NIGHT	2 NIGHTS	3 NIGHTS
Shared Double	us\$100	us\$165	us\$230
Single Occupancy	165	295	425
3rd Person	35	35	35

### PUERTO VALLARTA, MEXICO

CASAMAGNA MARRIOTT RESORT 2005	1 NIGHT	2 NIGHTS	3 NIGHTS
Shared Double	us\$100	us\$165	us\$230
Single Occupancy	165	295	425
3rd Person	40	40	40
Apr, 2006	1 NIGHT	2 NIGHTS	3 NIGHTS
Shared Double	us\$105	us\$170	us\$235
Single Occupancy	170	300	430
3rd Person	35	35	35
May, Sep, Oct 2006	1 NIGHT	2 NIGHTS	3 NIGHTS
Shared Double	us\$95	us\$150	us\$205
Single Occupancy	155	265	375
3rd Person	35	35	35

### SAN DIEGO, CALIFORNIA

SHERATON SAN DIEGO 2005	1 NIGHT	2 NIGHTS	3 NIGHTS
Shared Double	us\$170	us\$290	us\$410
Single Occupancy	290	530	770
3rd Person	75	105	135
2006	1 NIGHT	2 NIGHTS	3 NIGHTS
Shared Double	us\$135	us\$245	us\$355
Single Occupancy	245	465	685
3rd Person	50	75	100

### SAN FRANCISCO, CALIFORNIA

RENAISSANCE PARC 55 2005	1 NIGHT	2 NIGHTS	3 NIGHTS
Shared Double	us\$130	us\$220	us\$310
Single Occupancy	220	400	580
3rd Person	35	35	35
SHERATON FISHERMAN'S WHARF 2006	1 NIGHT	2 NIGHTS	3 NIGHTS
Shared Double	us\$125	us\$215	us\$305
Single Occupancy	215	395	575
3rd Person	65	95	125

### SEATTLE, WASHINGTON

SHERATON SEATTLE 2005	1 NIGHT	2 NIGHTS	3 NIGHTS
Shared Double	us\$140	us\$240	us\$340
Single Occupancy	240	440	640
3rd Person	70	100	130
2006	1 NIGHT	2 NIGHTS	3 NIGHTS
Shared Double	us\$120	us\$215	us\$310
Single Occupancy	220	410	600
3rd Person	50	80	110

# Before You Go

## Helping you plan your cruise.

### Puerto Vallarta, Mexico

#### TAMPA, FLORIDA

TAMPA MARRIOTT WATERSIDE 2005	1 NIGHT	2 NIGHTS	3 NIGHTS
Shared Double	us\$85	us\$150	us\$215
Single Occupancy	155	285	415
3rd Person	20	20	20

GRAND HYATT TAMPA BAY 2006	1 NIGHT	2 NIGHTS	3 NIGHTS
Shared Double	us\$135	us\$245	us\$355
Single Occupancy	245	465	685
3rd Person	55	90	125

#### VANCOUVER, BRITISH COLUMBIA

PAN PACIFIC HOTEL 2005	1 NIGHT	2 NIGHTS	3 NIGHTS
Shared Double	us\$125	us\$210	us\$295
Single Occupancy	210	380	550
3rd Person	75	115	155

2006	1 NIGHT	2 NIGHTS	3 NIGHTS
Shared Double	us\$150	us\$260	us\$370
Single Occupancy	260	480	700
3rd Person	75	115	155

- ♦ *Hotels of equal standard may be substituted when necessary.*

*Rates for hotels are per person and include applicable room taxes and bellman gratuities.*

*Optional Tour Inclusions: Fares are per person and include applicable room taxes and bellman gratuities unless noted otherwise. Holland America Line may substitute hotels of equal standard where necessary. Components of a tour itinerary may be operated in a different order than shown. A minimum number of guests may be required for a tour to operate. All fares are in U.S. dollars and are subject to change.*

*Guests must have a valid passport, necessary visas and any required immunizations prior to participation in a pre- or post-cruise tour. Guests are responsible for incidentals and meals unless noted otherwise.*

*Cancelling pre- and post-cruise hotels and/or tours between 16–45 days before commencing your cruise will result in a cancellation fee of 50% of the total amount; the fee increases to 100% for cancellations less than 16 days before commencing travel.*

*It is a privilege to welcome you on board our ships, and it is our sincere desire that you enjoy an extraordinary vacation. Here are answers to the questions we are frequently asked.*

#### **How do I make Dining Room reservations?**

Whatever your dining preferences — early or main sitting, for two or groupings of four, six or eight guests, with family or friends — Holland America Line will make every effort to honor your request. All dining requests should be made in advance of sailing through your travel agent and confirmed or waitlisted at the time of booking.

Upon embarkation you will find a confirmation card in your stateroom confirming your seating assignment and table number. If, for some reason, your dining request was not submitted before your cruise date, the Maitre d' will assign you to the sitting that is available.

#### **Normal meal hours in the main Dining Room are:**

Breakfast	Open seating	8:00AM
Lunch	Open seating	12:30PM
Dinner	Early sitting	5:45PM
	Upper level of Dining Room	
	Early sitting	6:15PM
	Lower level of Dining Room	
	Main sitting	8:00PM
	Upper level of Dining Room	
	Main sitting	8:30PM
	Lower level of Dining Room	

*ms Prinsendam* has two dinner sittings:  
 First sitting 6:00PM  
 Second sitting 8:15PM

#### **Alternate Dining Rooms**

Our intimate reservations-only restaurants — a delicious alternative to the main Dining Room — are very popular. We recommend you make reservations early in your cruise.

#### **What provisions for children are made on board?**

For infants, Holland America Line provides baby food, diapers, high chairs, booster chairs and cribs for a nominal fee, upon special request (30 days notice) via your travel agent or by calling Ship Services at 1-800-541-1576. For our younger guests, Holland America's **Club HAL®** program offers fully supervised activities, games, parties, menus and shore activities — broken out by ages 5–8, 9–12 and teens 13–17. Specific ships offer children's programs starting at age 3. Please call for details.

#### **Can you accommodate special diets?**

We make every effort to accommodate special dietary requests, including vegetarian, fat-free, sugar- or salt-free if advised at time of booking. Kosher\*, gluten-free or special medical diets must be pre-ordered a minimum of 90 days prior to sailing.

\* *Kosher meals are prepared off the ship in a kosher kitchen, frozen and brought to the table sealed in their original containers. There is no kosher kitchen on board.*

# Smooth Air Travel

Connecting to your cruise.



*Flight delays, diversions, cancellations — with Holland America's Fly Cruise Plan you have the resources of our entire air/sea staff behind you.*

## **HOLLAND AMERICA'S FLY CRUISE PLAN**

In these changing times, it's worth every dollar — and then some.

When your air travel is arranged through Holland America Line, you are automatically enrolled in our Fly Cruise Plan, a program which entitles you to a whole host of benefits:

- **FLIGHT DELAY ASSISTANCE** *If your flight to the embarkation city is delayed, we'll make sure someone is at the airport to meet you and help you with your luggage.*
- **FLIGHT CANCELLATION ASSISTANCE** *If your flight is cancelled or a revised schedule no longer connects to the ship or tour, we will alter your ticket at no charge; if necessary, we'll even rebook on an alternate airline.*
- **TRANSFER SERVICE** *We include all transfers between airport and ship, ship and hotel, hotel and airport.*
- **CUSTOM TRAVEL** *Our AirPlus Service® allows guests to select which airlines they prefer, upgrade flight class, and/or travel to and from their (dis)embarkation port on dates other than those usually booked.*

## **AIR RATES/AIR TAXES/FEES**

Air rates will be quoted and are subject to change until the booking is paid in full. Quoted rates do not include Passenger Facility Charges (us\$3-\$27), federal flight segment fees for each flight segment (take off and landing) of us\$3.20, the September 11 Security Fee of us\$2.50 per passenger enplanement (up to a maximum of \$10), and international arrival and departure taxes (us\$3-\$100).



## **AIRPLUS SERVICE®**

AirPlus Service is available for Fly Cruise guests who wish to customize their air travel. Popular options include:

- Scheduling your travel to allow for an extended stay either before or after your cruise
- Upgrading to First or Business class, subject to availability
- Choosing preferred airlines to gain credit for mileage programs, or because your plans require a certain flight or particular time
- Designating a different gateway city than the one closest to home

Written requests should be faxed to AirPlus Service at (206) 298-3008 or mailed to:

Holland America Line Inc.  
Attn: AirPlus Service  
300 Elliott Avenue West  
Seattle, WA 98119

# Mariner Society®

*"Once aboard, never forgotten." Our past guests are members of a distinguished travel group known as the Mariner Society. Membership is automatic and entitles you to special rewards and extra privileges like these. Whether you've cruised with us fifty times or just once, we're honored to welcome you aboard again as a special and honored guest, a Mariner.*

## PREFERRED PRICING

- Special Mariner fares (on select sailings), and even savings for relatives and friends

## SPECIAL EVENTS AND GIFTS

- Mariner lapel pins, luggage tags, special pillow gifts

- Invitation to a Mariners-only Champagne reception and awards ceremony, hosted by the Captain

## MARINER® MAGAZINE

- Complimentary subscription to our travel magazine, featuring news and Mariner Society updates

Requests should be submitted prior to final payment in order to assure proper consideration. All requests are subject to availability and are not guaranteed. If confirmation is possible, a us\$50 non-refundable service charge and additional airline costs incurred will be assessed. A service charge will be assessed for each additional request that is confirmed. **Confirmed requests to fly in early or fly out late forfeit the associated transfer.**

## BOOK EARLY

The availability of the air rates that we have arranged may be limited. Therefore, it is advantageous for you to book your vacation as early as possible. We reserve the right to limit or close sales from cities without notice.

## LIABILITY AND RELATION WITH AIRLINES

We reserve the right to use the carriers, routing, and fare structure of our choice, and to utilize commuter and/or charter air service without prior notice. As the airfares we use are based on capacity-controlled, promotional, and group fares, we may limit or close sales without prior notice at any time. If, due to any cause beyond our control, we are unable to arrange for air travel or the air travel we arrange is unavailable or otherwise fails to materialize, our liability will be limited to refunding the air add-on amount paid to us. We assume no liability for any acts or omissions of any airline, including, without limitation, those involving cancellation of flights, schedule changes, re-routings, damage to or delay or loss of baggage, flight delays, equipment failures, accidents, pilot or other staff shortages, overbooking or computer errors. The liabilities and obligations of an airline to you, and your rights against an airline, are subject to any and all terms and conditions of the airline's ticket and tariffs.

## SEAT ASSIGNMENTS/SPECIAL REQUESTS

We cannot confirm seat assignment requests or requests for special meals or other special services not mentioned in this brochure. Your travel agent may assist with these arrangements once you receive your tickets. Some airlines or charter operators may not offer advance seat assignments. Guests traveling with other guests who originate from different cities or who request the Fly Cruise Plan at a later time may not receive routing on the same flights.

## AIR CHANGES/REFUNDS

Changes to existing reservations initiated by guests will result in a rescheduling charge of us\$100 per guest if the changes are made after the final payment due date. Airline tickets are issued based on fares which are highly restrictive and often cannot be reissued or exchanged for another carrier or routing.

Departures prior to May 2006: A fee of us\$100 will be assessed for guests who delete the Fly Cruise Plan from their booking.

Departures May 2006/after: Refer to the Cancellation Policy on page 124. The maximum refund for unused air tickets will not exceed the air add-on paid to us. There are no partial refunds. Due to changing airline tariffs, your tickets may reflect fares higher or lower than our air add-on amounts. The difference is neither chargeable nor refundable.

## BAGGAGE

Baggage allowance is governed by airline regulations. Excess baggage charges are the responsibility of the guest. We assume no responsibility for loss, damage, or delay while baggage is in the custody of airlines.

## OVERNIGHT HOTEL ACCOMMODATIONS

It may be necessary to overnight guests en route to or from their cruise due to airline schedules and/or availability. If necessary, the cost of hotel accommodations is not included in the air add-on amounts. Hotels will be selected by Holland America Line and may not be at the port of (dis)embarkation. Guests are responsible for hotel accommodations, meals and items of a personal nature.

## TRANSFERS

A complimentary transfer service between the airport and the ship will be provided for Fly Cruise guests whose flights arrive or depart on (dis)embarkation day only.

## CRUISE-ONLY GUESTS

We recommend that you schedule a minimum of four hours both at the beginning and end of your cruise to allow for transfers, customs clearance and airport security checks.

Note: If you purchase air transportation independently from Holland America Line, you will be responsible for any and all expenses incurred when joining the vessel in progress.

## HOME CITY MOTOR COACH SERVICE

Roundtrip motor coach service is available from the cities listed below for cruises departing from Ft. Lauderdale. Home City Motor Coach program is available only on cruises which embark and disembark from the same port (not available on one-way cruises). A us\$50 per-person fee will apply.

## CRUISES DEPARTING FROM FT. LAUDERDALE:

Boca Raton, FL	Orlando, FL
Bradenton, FL	Palm Coast, FL
Clearwater, FL	Port Charlotte, FL
Daytona Beach, FL	St. Petersburg, FL
Ft. Myers, FL	St. Augustine, FL
Ft. Pierce, FL	Sarasota, FL
Jacksonville, FL	Stuart, FL
Lady Lake, FL	Sun City, FL
Leesburg, FL	Tampa, FL
Melbourne, FL	Vero Beach, FL
Naples, FL	Venice, FL
Ocala, FL	West Palm Beach, FL



## AMTRAK® TRAIN TRAVEL

Travel by Amtrak and receive special discounts up to 25%\* on travel between cities in the U.S. & Canada and select Holland America Line ports of embarkation. Simply book your cruise and call Amtrak at 1-800-USA-RAIL for train travel information and reservations.

\* Restrictions apply.

Amtrak is a registered trademark and service mark of the National Railroad Passenger Corporation.

# Details, Details

## Important policies for your review.

### RESERVATIONS

Travel agencies provide valuable service and counseling to prospective travelers. We encourage you to make your Holland America reservations with a travel agent who understands your individual needs. Travel agencies are not owned or controlled by Holland America Line. Your deposits and payments for Holland America's services are to be paid to the travel agency with which you made your reservations. Since accommodations are limited by the number of staterooms on each ship, reservations should be made as early as possible. Travel documents will be issued only if and when full payment has been received by Holland America Line from the travel agency. Refunds for cancelled or unused services will normally be made to the same travel agency on the basis of the amount actually received by Holland America Line less any applicable cancellation fees and charges. You are responsible for obtaining from your travel agency monies either retained by the agency or received by the agency from Holland America Line. For further information visit our website at [www.hollandamerica.com](http://www.hollandamerica.com) or call 1-877-SAIL HAL. Guests under 21 years of age must be accompanied by a parent, guardian or chaperone who is at least 25 years old; one adult chaperone is required for every five people under 21.

### DEPOSIT AND FINAL PAYMENT REQUIREMENTS

The per-person, per-cruise deposit requirements to secure reservations and Cancellation Protection Plan costs are listed with the cruise prices.

A deposit is required at time of cruise booking. Cancellation Protection Plan, if desired, must be paid for at time of deposit; see Cancellation Protection Plan and Additional Baggage Protection for details (pages 120–121, 125).

Final payment is due no later than 75 days, or 90 days for cruises 26 days or longer, prior to departure. In most cases, we are able to provide you with travel documents, including your cruise contract, approximately 30 days prior to departure. Travel documents, however, are issued only after final payment has been received by Holland America Line.

Travel agents should make checks payable and send to:

Holland America Line Paymaster Corporation  
P.O. Box C34013  
Seattle, WA 98124-1013  
U.S.A.

Payment by American Express, VISA, MasterCard or Discover Card is also accepted.

For faster processing, please include a confirmation number on your check. Travel agents please note that MCOs will not be accepted.

### UPGRADE POLICY

Holland America Line reserves the right to upgrade a guest or guests to more expensive category accommodations at no additional cost.

### CHANGE CHARGES

Changing your itinerary after reservations have been made can result in loss of advantages gained by early planning. In addition, the results of last-minute changes may be disappointing. To cover administrative costs, a per-person charge will be assessed if you request a change in your travel arrangements after final payment due date. Change charges are not assessed for stateroom upgrades or for the addition of services, unless air reservations are altered and/or travel documents must be reissued. For passengers wishing to change date of sailing, please see the Cancellation Policy for applicable charges.

### CANCELLATION POLICY

A full refund (except for amounts paid for CPP) will be made for written cancellations received by Holland America Line, 300 Elliott Avenue West, Seattle, WA 98119 at least 76 days, for cruises 26 days or longer, prior to the date on which you are to commence travel by air, rail, sea or otherwise. Cancellation fees for guests who cancel after that date for any reason, including medical or family reasons, are subject to the following per-person cancellation fees:

#### SAILINGS UNDER 26 DAYS

75–57 days before commencing travel:  
an amount equal to deposit requirement;

56–29 days before commencing travel:  
50% of gross fare;

25–16 days before commencing travel:  
75% of gross fare;

15 days or less before commencing travel:  
100% of gross fare.

#### 26- TO 34- DAY SAILINGS

120–91 days before commencing travel:  
an amount equal to deposit requirement;

90–76 days before commencing travel:  
60% of gross fare;

75 days or less before commencing travel:  
100% of gross fare.

Given that the resale of cancelled space will likely result in a lost opportunity to sell other space, these fees are due regardless of resale. Fees incurred as a result of cancellation cannot be applied to future bookings. Refunds will normally be made to your travel agent. Travel agents may impose their own cancellation fees. Agency fees of any nature are a matter to be decided on solely by the agency and guests.

Name changes require the prior approval of Holland America Line and may not always be possible. Cruise contracts are nontransferable. Name changes and departure date changes are considered reservation cancellations and are subject to cancellation fees.

### CRUISE FARES

Traveling with Holland America Line is one of the best vacation values around. Your cruise fare includes accommodations aboard an elegant Holland America cruise ship with most meals and entertainment on board ship. Not included, however, are items of a personal nature, transfers or optional programs or optional activities, such as alcoholic beverages, soft drinks, laundry and dry cleaning, shore excursions, medical, barber and beauty shop services. All fares are per person in U.S. dollars.

### GRATUITY POLICY

Exceptional service is part of the Holland America cruise experience. Because you are our guest, it is our goal to make sure you receive the finest service possible. And we have made it easy for you to reward excellent service on board.

A gratuity of us\$10 per guest per day for dining and stateroom services will be automatically added to your shipboard account on a daily basis. We are confident that you will find the service on board exemplary and, should you wish to make adjustments, you may do so at the end of the cruise by contacting the front office. A 15% service charge will be automatically added to your bar charges and dining room wine account.

In terminals, airports, ports of call and on shore excursions, we suggest that you extend gratuities consistent with customary local practices.

### FARES, NON-DISCOUNTABLE AMOUNTS, TAXES AND SURCHARGES

Holland America Line reserves the right not to honor any published prices that it determines were erroneous due to printing, electronic, or clerical error. Each cruise fare includes a "Non-Discountable Amount." That portion of the fare is neither commissionable to travel agents nor subject to reduction in the event of a percentage discount promotion, 2-for-1 promotion or otherwise. Fares quoted in this brochure are those in effect at the time of printing. If cost factors dictate the need for fare increases, Holland America Line may do so at any time prior to departure. Guests can cancel (without paying a cancellation fee) rather than accept a fare increase. This right does not apply to increases in Taxes or to surcharges, as described below. The term "Taxes" as used by Holland America Line refers to certain taxes, fees and charges imposed by governmental or quasi-governmental authorities, including port authorities, relating to any aspect of your cruise or tour. If governmental action results in any element of Taxes exceeding the estimates used by Holland America Line for purposes of preparing this brochure, we reserve the right to pass through the extra amount.



Similarly, Holland America Line reserves the right to impose or pass through fuel surcharges, security surcharges or similar incidental surcharges. No right of cancellation exists under either of these circumstances.

#### GUESTS WITH DISABILITIES

We do not discriminate against persons on the basis of disability. We seek, to the extent feasible, to accommodate the needs of persons with disabilities. We have a limited number of staterooms designed for wheelchair access. Service animals are permitted on board ships if prior arrangements have been made. You need to be aware, however, that certain land and shore facilities may not be fully accessible to persons with disabilities. While Holland America Line endeavors to contract with companies which provide accessible services and facilities, we cannot guarantee that all services and facilities will be fully accessible. In limited situations where an individual with a disability would be unable to satisfy certain specified safety and other criteria, even when provided with appropriate auxiliary aids and services, we may find it necessary to ask the individual to make alternative travel arrangements. We must be notified of any special medical, physical or other requirements of passengers at the time of booking. Please contact our Access and Compliance Department at [halw\\_access@hollandamerica.com](mailto:halw_access@hollandamerica.com).

#### MEDICAL SERVICES/INFANTS/ PREGNANCY

Each of our ships is equipped with limited medical facilities that are staffed by a physician and registered nurses. The physician is an independent contractor. There will be a fee charged for all medical services and medications obtained on board. If you become ill during the cruise and the physician is unable to care for your needs on board, you will be transferred to medical facilities on shore. If your condition will require that you have special medical apparatus or assistance on board, we must be made aware of that at time of booking in order to determine whether we can accommodate your needs. If you are using prescription drugs, please bring an adequate supply with you and keep them in your carry-on luggage. Due to the limited medical facilities on the ships, we will not accept reservations for infants 12 weeks or younger at time cruise commences, or women who will be 24 or more weeks pregnant at the time their cruise with Holland America Line concludes.

#### IMMIGRATION AND IMMUNIZATION

For cruises beginning and ending in U.S. ports, government-issued photo identification together with an original or certified copy of your U.S. or Canadian birth certificate or your U.S. or Canadian naturalization certificate is acceptable. For all Panama Canal cruises guests are required to carry a passport valid for 6 months after disembarking the ship and necessary visas. Expired passports are not acceptable. You are responsible for securing necessary visa and immunizations. Information on visas, if applicable, is provided to travel agents by Holland America Line. Information on visas may also be obtained by contacting Zierer Visa Services at 1-866-788-1100 or E-mail [hollandvisainfo@zvs.com](mailto:hollandvisainfo@zvs.com). Guests are responsible for staying apprised of all current requirements. As to immunizations, please check with a travel medicine specialist or local health department for

specific recommendations and/or requirements. Additionally, you may find some helpful information on the U.S. Center for Disease Control website at [www.cdc.gov/travel](http://www.cdc.gov/travel) or call toll free 1-877-FYI-TRIP. Some countries have special requirements for minors (under 18) who are not traveling with both parents. Please discuss this with your travel agent. Non-U.S. citizens must have a valid passport and any necessary visas. Please verify carefully the existing identification requirements for your particular travel situation. In addition, non-U.S. citizens who have previously been admitted to the United States for permanent residence must carry their Permanent Resident Card (Form I-551), commonly known as a Green Card.

#### BAGGAGE POLICY

Holland America Line will carry as baggage only your personal effects for your wearing, comfort or convenience during your travel with Holland America Line. Your baggage needs to be placed in securely constructed and locked suitcases or trunks. If your travel includes a land component, you are limited to two pieces of checked baggage and one overnight or light flight bag which must remain in your custody at all times.

Holland America Line does not assume any liability for loss of or damage to or delay of perishable items, medicine, liquor, cash, credit or debit cards, jewelry, gold, silver or similar valuables, securities, financial instruments, records or other valuable or business documents, computers, cellular telephones, cameras, hearing aids, electric wheelchairs, scooters, or other video or electronic equipment, binoculars, film, videotape, computer disks, audio disks, tapes or CDs. These items should not be left lying about the ship or your stateroom, nor should they be left unattended on other vessels, railcars or other vehicles or in hotels, nor placed in luggage other than the bag you carry with you. In addition, Holland America Line will not assume any liability for any loss of or damage to carry-on baggage left unattended on the ship or on other modes of transportation or in hotels. Holland America's ships provide, at no extra charge, either safe-deposit boxes in the ship's Front Office or stateroom safes. Certain hotels may also provide similar facilities. Your use of safe-deposit boxes, stateroom safes or similar facilities will not increase Holland America's liability as described below.

Holland America Line cannot be responsible for any loss, delay or damage that occurs before baggage comes into Holland America's actual custody when you begin your travel with us or after baggage leaves Holland America's actual custody at the end of your travel with us. In particular, please note that we assume no responsibility for loss, damage or delay while baggage is in the custody of airlines.

If Holland America Line, due to any cause whatsoever, is liable for loss of, damage to or delay of your property, the amount of Holland America's liability will not exceed US\$100 (US\$600 for guests who have purchased Cancellation Protection Plan) unless you have specified to Holland America Line in writing the true value of your property and paid to Holland America Line before departure 1% of the value in excess of US\$100 or US\$600, as applicable. In that event, Holland America Line's liability will be limited to the amount so specified.

#### RESPONSIBILITY

The *ms Noordam*, *ms Amsterdam*, *ms Oosterdam*, *ms Prinsendam*, *ms Zuiderdam*, *ms Volendam*, *ms Zaandam* and *ms Westerdam* are owned by HAL Antillen N.V. and chartered to Holland America Line N.V. The *ms Ryndam* and *ms Maasdam* are owned by HAL Nederland N.V. and chartered to Holland America Line N.V. The *ms Veendam* is owned by Wind Surf Limited and chartered to HAL Cruises Limited. All of these entities are affiliates of Holland America Line Inc. Transportation aboard the ship is provided solely by the Shipowners and Charterers and pursuant to the Cruise Contract that you will receive prior to embarkation. A copy of the form of cruise contract will be provided upon request or can be viewed on our website: [www.hollandamerica.com](http://www.hollandamerica.com). Please note that the contract includes a clause specifying certain courts in the State of Washington as the exclusive forum for resolving disputes.

Non-Holland America Services (such as airlines and ground carriers, shore excursions, restaurants, air ambulance, hotels and shoreside physicians) are generally performed by independent contractors. These Non-Holland America Services are solely at your risk and subject to the terms or arrangements made by you or on your behalf with the independent contractor. We assume no responsibility with respect to these Non-Holland America Services (including cancellation, delay, injury, death or damage to property) even though we may collect monies or make bookings.

Situations may arise which, in our opinion, make it necessary for us to cancel, advance or postpone a scheduled departure, change itineraries or make substitutions involving hotels, restaurants, ports of call, other travel components, vessels or other modes of transportation. In that event, we do not assume responsibility or liability for any resulting losses, expenses or inconvenience. Your full cruise fare will be refunded, however, if the cruise is cancelled prior to initial embarkation. We are not required to make refunds once travel commences regardless of the reason for guests being unable to complete their travel.

#### SHIPS' REGISTRY

The *ms Noordam*, *ms Westerdam*, *ms Ryndam*, *ms Oosterdam*, *ms Prinsendam*, *ms Zuiderdam*, *ms Zaandam*, *ms Volendam*, *ms Maasdam* and *ms Amsterdam* are registered in The Netherlands; *ms Veendam* in the Bahamas. Holland America Line has registered trademarks in the United States and various foreign countries for the names and phrases "Holland America," "Holland America Line," "Westours," "A Tradition of Excellence," "AirPlus Service," "Oceans Apart," "Club HAL," "Wayfarer," "Westfarer," "Seafarer," "Sunfarer," "Eastfarer," and "The World In Your Hands," as well as for the modern and antique ship design logo.

Should you need to contact Holland America Line prior to sailing, please use this address:

Holland America Line Inc.  
300 Elliott Avenue West  
Seattle, Washington 98119  
U.S.A.

# HOLLAND AMERICA LINE IS A PROUD MEMBER OF



Holland America Line



Carnival Cruise Lines

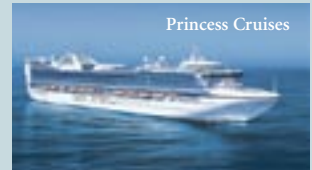

Princess Cruises



Cunard Line



Costa Cruises



Holland America Line is one of the many distinctive cruising experiences available through World's Leading Cruise Lines. Each of our members excels in a particular style of cruise vacationing. Enjoy the timeless sophistication of Holland America Line, the fun spirit of Carnival Cruise Lines, the affordable luxury of Princess Cruises, the classic British tradition of Cunard Line, the Italian charm of Costa Cruises, the casual elegance of Windstar Cruises and the indulgent intimacy of The Yachts of Seabourn.



And only the members of World's Leading Cruise Lines can offer excellent values through Vacation Interchange Privileges. If you have previously cruised on any of our member lines, VIP entitles you to sail Holland America Line for your next vacation and receive certain Holland America past-passenger cruise fare savings when you book. With World's Leading Cruise Lines, you're sure to choose the vacation experience that best fits your lifestyle.

For more information, visit [www.worldsleadingcruiselines.com](http://www.worldsleadingcruiselines.com)



**Holland America Line**

*A Tradition of Excellence*

SPACIOUS, ELEGANT SHIPS  
GRACIOUS, UNOBTRUSIVE SERVICE • WORLDWIDE ITINERARIES  
EXTENSIVE ACTIVITIES AND ENRICHMENT PROGRAMS  
SOPHISTICATED FIVE-STAR DINING

Call your travel agent or 1-877-SAIL HAL, ext. 54  
or visit [www.hollandamerica.com](http://www.hollandamerica.com).

Sail on any member of World's Leading Cruise Lines and you'll be entitled to certain past-guest cruise fare savings currently being extended by any of our lines to their past guests.

Effective March 2005 CB15416 Printed in U.S.A.

©2005 Holland America Line Inc.