

# e-brochure

## April 2005 – April 2007 Caribbean, Mexico & Panama Canal Cruises

ACCESS ANY SECTION OF THE E-BROCHURE BY USING THE BOOKMARKS TAB ON THE LEFT SIDE OF THE SCREEN. CLICK ON THE TOPIC OF INTEREST, AND YOU WILL JUMP TO THAT SECTION IMMEDIATELY.

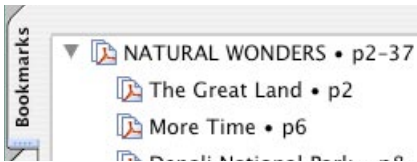

USE ADOBE READER'S NAVIGATION ARROWS TO MOVE A PAGE FORWARD OR BACK, OR TO MOVE TO THE BEGINNING OR END OF THE DOCUMENT.



CLICK ON THE "EXPLORE ADDITIONAL INFORMATION ONLINE" BUTTON TO GO DIRECTLY TO THE HOLLAND AMERICA LINE WEBSITE. YOU MUST BE CONNECTED TO THE INTERNET.

The Holland America Line e-brochure offers you enhanced information to help you plan your cruise vacation. In addition to all the essential details included in our printed brochure — port descriptions and photos, itineraries, itinerary maps, and ship deck plans — the e-brochure provides clickable links to the Holland America Line website [www.hollandamerica.com](http://www.hollandamerica.com) for up-to-date information and resources.

The Caribbean, Mexico & Panama Canal Cruises e-brochure is a document in the Adobe® Portable Document Format (PDF), a publicly available format used by organizations around the world for secure, reliable electronic document distribution. Anyone can open this PDF document on any system — regardless of the software platform, the original application, or the availability of specific fonts — using free Adobe Reader® software that you can [download here](#). The e-brochure is designed for Adobe Reader® versions 6.0 and higher.

*You can navigate through the document and access the online material quickly and easily, using the tips to the left.*

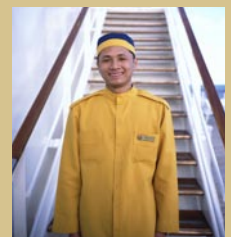





At Holland America Line,  
we believe a ship should look like a ship.

With graceful nautical lines and  
spacious rooms adorned with fine art.

And each stateroom offering  
a luxurious retreat.

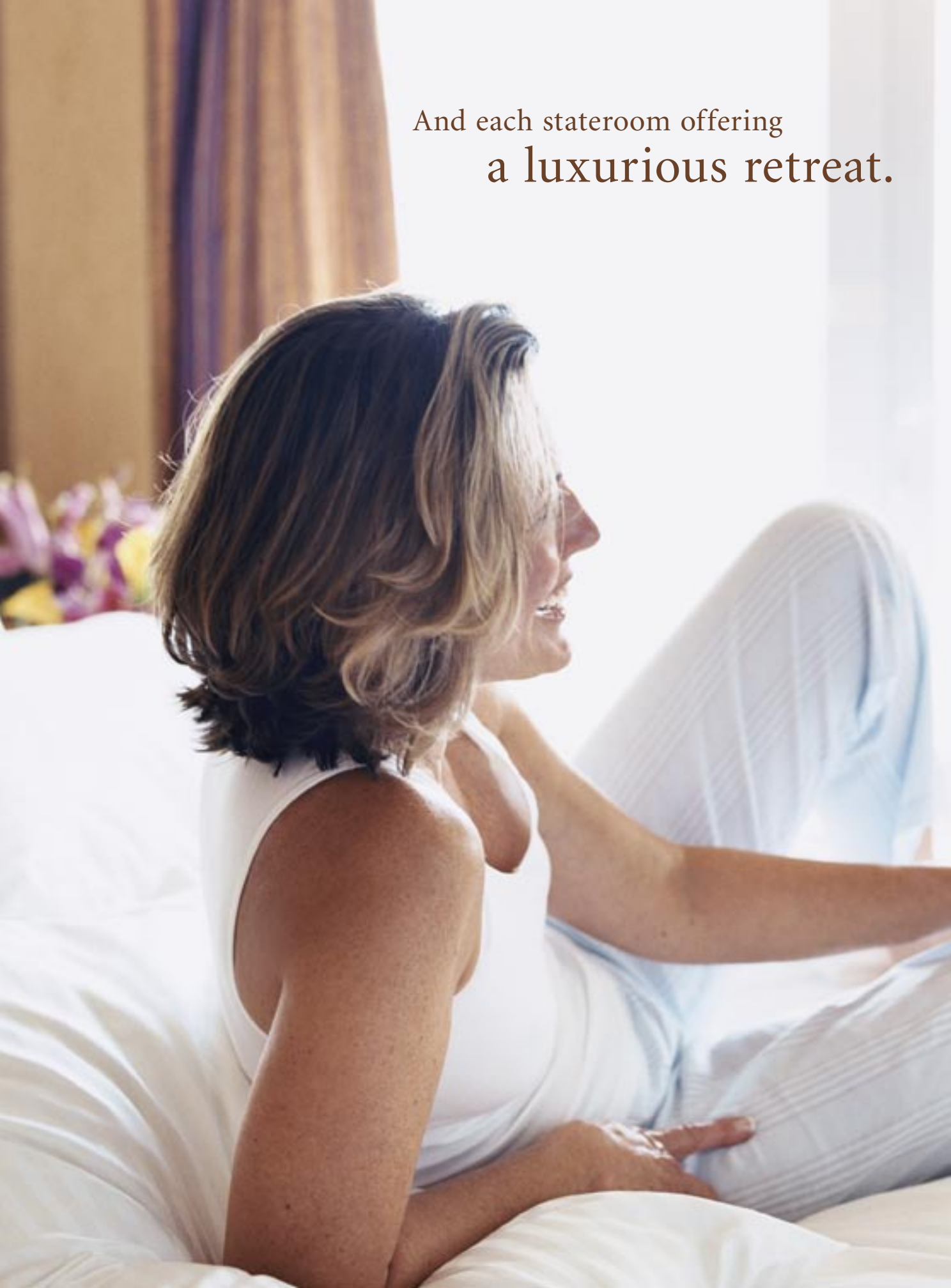

On board a Holland America ship you'll discover an ambiance of refined beauty and traditional maritime styling. Elegantly appointed interiors recall the historic glamour of ocean travel, as do our ships' classic V-shaped prows, which slice gracefully through the waves.

#### CLASSIC DESIGN

- Traditional, graceful ships designed to be true ocean-going vessels
- Wraparound teak Promenade Deck and classic teak deck chairs
- Spacious public rooms adorned with fine art and antiques
- Marine-blue hulls
- Polished brass brightwork — a nautical tradition

#### MID-SIZED SHIPS

- Ships designed to be large enough to offer the amenities required by today's discriminating traveler while carrying far fewer guests
- More space per guest than other major cruise lines
- More suites than any other cruise line
- Largest, most comfortable and finely appointed suites of any major cruise line
- Largest staterooms and verandahs of any premium cruise line
- Early embarkation program allows guests to board as early as 11:00AM

#### EVERY STATEROOM

##### A GRACIOUS RETREAT

- Spacious, elegantly appointed staterooms, many with private verandahs
- Luxurious Euro-Top beds and premium linens\*
- Large, extra-fluffy Egyptian cotton towels; plush bathrobes; magnifying mirrors; salon-quality hair dryers\*
- Flat-panel televisions with DVD players\*
- Complimentary fresh fruit assortment
- Complimentary 24-hour in-room dining
- Nightly turndown service

#### FOR PENTHOUSE AND DELUXE VERANDAH SUITE GUESTS (CATEGORIES PS & S)

- Use of the exclusive Neptune Lounge
- Luxurious duvets and pillows
- Fresh flowers
- Fully stocked no-host mini-bar
- 24-hour one-touch telephone concierge service
- Special (dis)embarkation privileges

*\* All suites have Euro-Top beds. All staterooms on all ships will receive flat-panel televisions and Euro-Top beds by the end of 2005 & 2006 respectively. Please contact us for 2006 completion dates.*

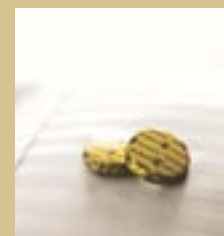

*Luxurious living is found in every detail, from the soft caress of a personal bathrobe to European chocolates on your pillow at night.*

Here, every request —  
be it extra beach towels or two sugars in your tea —  
is miraculously anticipated.







You are  
cared for impeccably  
by a crew who delight in saying “yes.”



At the heart of the Holland America Line experience is a crew adept at anticipating guests' desires — and going above and beyond to fulfill them. Until you've experienced service like this, you don't know why it's so valued. Once you do, there's no going back.

#### A SIGNATURE STYLE

- BEST OVERALL SERVICE — *Porthole Cruise Magazine* Readers' Choice Awards
- Academy-trained professional crew
- Warm, unobtrusive style of service — never in the way, never out of reach
- Nearly one crew member for every two guests
- Over 130 years of polished skills
- BEST OVERALL CRUISE VALUE (13 consecutive years) — World Ocean & Cruise Liner Society
- INTERNATIONAL FIVE STAR DIAMOND AWARD — The American Academy of Hospitality Sciences, 2004

#### IN YOUR STATEROOM

- Daily housekeeping to refresh fruit, tidy belongings and keep staterooms immaculate
- Nightly turndown service
- Complimentary 24-hour in-room dining
- Use of the exclusive Neptune Lounge and personal concierge service for Penthouse and Deluxe Verandah Suite guests

#### IN THE RESTAURANTS

- Two expert servers per table in the main Dining Room, selected for their proven abilities to remember guest preferences
- Knowledgeable wine stewards adept at pairing wine with food
- New table-side waiter service in the enhanced Lido, our popular casual dining restaurant
- Executive chefs inducted into the prestigious Confrérie de la Chaîne des Rôtisseurs, an international food and wine society

#### THROUGHOUT THE SHIP

- Poolside beverage service featuring hand-crafted tropical cocktails and signature recipes using fresh-squeezed juices and premium ingredients
- Expert fitness instructors in yoga, Pilates and weight training
- European-trained aestheticians in the Spa
- Gaming lessons offered by Casino staff
- Complimentary lemonade and iced tea served on deck in mid-afternoon
- Social hosts for dinner and dancing on cruises of 14 days or longer



*With nearly one crew member for every two guests, every detail is promptly and perfectly rendered.*

Fine china and crystal  
set the stage for elegant dining.





Each evening is an  
**occasion to celebrate**  
another memorable day.





Across a myriad of venues, from a casual bite poolside to a formal five-course affair, the crew of Holland America Line knows, as few do, how to orchestrate a truly memorable dining experience.

#### THE ELEGANT MAIN DINING ROOM

- Luxurious two-tiered Dining Room,\* graced with fine art and antiques
- Sophisticated details including Rosenthal china and crisp white table linens
- Five-course menus with offerings from classic French cuisine to vegetarian and low-carbohydrate options
- Menus are created daily and seldom repeated
- Choice of four dinner sittings\*
- Romantic formal nights, a traditional cruise favorite

#### THE PINNACLE GRILL EXPERIENCE

- Intimate, reservations-only dining featuring Sterling Silver beef and fresh seafood
- Luxurious appointments including Bvlgari® china, Riedel® stemware and Frette® linens
- Extensive wine list featuring many selections rated “Excellent” by *Wine Spectator*

#### OTHER DELIGHTFUL WAYS TO DINE

- Fresh, cooked-to-order specialties in the enhanced Lido Restaurant for breakfast and lunch
- Made-to-order dinner entrées and table-side waiter service in the Lido for dinner

- Complimentary in-room dining
- The Terrace Grill on deck, where swimsuits are suitable attire
- Explorations Café featuring pastries and espresso drinks♦
- Daily Afternoon Tea service, elevated to Royal Dutch High Tea once per cruise
- Late-night snack, chocolate dessert extravaganza

#### A MASTER STAFF AND CREW

- Menu design under the direction of Master Chef Rudi Sodamin
- Executive chefs inducted into the prestigious Confrérie de la Chaîne des Rôtisseurs, an international food and wine society
- Two expert servers per table in the main Dining Room

#### SIGNATURE TOUCHES

- Signature cocktails featuring fresh, hand-shaken innovations and classic favorites
- Hand-dipped chocolates in the Explorer’s Lounge
- Ice cream bar featuring complimentary treats
- Complimentary hot hors d’oeuvres during cocktail hour

\* *One-level Dining Room and two dinner sittings on ms Prinsendam.*

♦ *Explorations Café facilities vary by ship and will be on all ships featured in this brochure by the end of 2006.*



*Each evening is a celebration of fine food and wine, a feast for the eyes, the palate and the soul.*



Things to do today:  
melt into the comfort of  
**our opulent spa.**





Enjoy an evening of  
dazzling entertainment.



Every day aboard Holland America Line brings a wealth of activities and indulgences, along with the freedom to partake of as many — or as few — as you please.

#### RELAX AND RECHARGE<sup>▲</sup>

- Newly expanded Greenhouse Spa & Salon offers:
  - Asian-inspired treatment rooms, including couple's massage rooms offering an impressive menu of luxurious treatments
  - Thermal suites with hydrotherapy pool, steam and aromatic room, showers and heated ceramic lounges
- Jacuzzi<sup>®</sup>, hot tub, sauna, steam room
- Two large outdoor pools, one with sliding glass roof
- Lifestyle Fitness Center with yoga, Pilates, spinning and new exercise and weight-training equipment
- Basketball and volleyball courts\*
- Golf simulator and golf swing analysis<sup>♣</sup>
- Luxury duty-free shopping

#### PERSONAL GROWTH

- Culinary Arts Center for gourmet presentations, tasting events and intimate cooking classes
- Explorations Café, powered by *The New York Times*, offering more than 2,000 books, music listening stations, Internet, puzzles and more<sup>♦</sup>
- Explorations Speaker Series featuring experts on subjects such as history, culture and cuisine
- BEST SHORE EXCURSIONS — *Porthole Cruise Magazine* Readers' Choice Awards
- 24-hour e-mail and Internet access

#### ALIVE AT NIGHT

- BEST ONBOARD ENTERTAINMENT — *Onboard Services Magazine*
- Lavish Las Vegas-style production shows
- Talented vocalists, illusionists, comedians and variety acts
- Casino gaming, movies, Piano Bar
- Crow's Nest Nightclub & Late-night Disco
- Club HAL<sup>®</sup> After Hours (10:00PM–midnight)

#### JUST FOR KIDS<sup>♣</sup>

- Club HAL<sup>®</sup> supervised by fun full-time directors and staff
- Colorful playroom for children ages 3–7, featuring art table, big-screen television and games
- Separate area for ages 8–12 with arcade games, Sony Playstations and "Dance Dance Revolution"
- The Loft and The Oasis — special *teens-only* areas with lounge, Internet access, exclusive sun deck with waterfall

<sup>▲</sup> All ships currently have a spa and fitness facility. The enhanced Greenhouse Spa & Salon facilities will be added to the ships throughout 2005 and 2006.

\* Available on all ships except ms Prinsendam.

♣ Available on ms Westerdam and ms Prinsendam only.

♦ Explorations Café facilities vary by ship and will be on all ships featured in this brochure by the end of 2006.

♣ Youth and child facilities vary by ship.



Try your luck in the Casino. Spend time together around the pool. Claim a deck chair and read. Choices abound!



An underwater photograph showing three stingrays swimming in clear, shallow blue water. Sunlight filters through the water, creating a pattern of light and shadow on the sandy bottom. The stingrays are seen from above, with their long tails trailing behind them.

Immerse yourself in the languid  
rhythm of the Caribbean.

Let your spirits fly  
on our own private isle,  
**Half Moon Cay.**



*The quintessential Caribbean.* That's the way guests describe Half Moon Cay, Holland America's private island in the Bahamas. This 1,700-acre island — only two percent of which is developed — features a two-mile crescent of perfect beach and a huge interior lagoon.

#### ON THE WATERFRONT

- BEST PRIVATE ISLAND (4 years running)  
— *Porthole Cruise Magazine*
- Beautiful private beachfront cabanas offering fresh-water shower, refrigerator, hammocks and butler service
- Watersports Center with kayaks, Hobie Cat® sailboats, aqua-cycles, floating foam mats and sailboats for rent
- Banana boat rides
- Beverage service available
- Beachside massage

#### FASCINATING EXCURSIONS

- Horseback Riding by Land and Sea: ride to the island's high point, then through the surf as your horse swims in the ocean
- Stingray Adventure: snorkeling and swimming with rays in a secluded cove
- AquaTrax® Watercraft Adventure: a guided personal watercraft tour and the chance to race on a buoyed course

- Deep-sea fishing for wahoo, snapper and grouper
- Natural history walk with naturalist
- Parasailing over the Caribbean
- Bonefishing in the interior lagoon
- Glass-bottom boat ride
- Scuba adventure
- Snorkel excursion

#### KIDS' FUN

- Half Moon Lagoon aqua park with a multi-level play set featuring water cannons, water walls and slides, and colorful, climbable sea creatures

#### IN THE VILLAGE

- Colorful shops and boutiques
- Bahamian-style hair braiding
- Tropical beach barbecue: a festive island feast catered by the ship's crew (shade available)
- Chapel for weddings, renewal of vows



*A day of play like no other: ride horseback into the sea, watch kids splash down at the aqua park, feel the breeze on your skin.*

*White sand, black sand, talcum-soft or shell-strewn. For the beauty of its beaches, the Eastern Caribbean is unequalled. None is more perfect than the two-mile crescent rimming the bay on Half Moon Cay, our private isle in the Bahamas. Things to do today: paddle a kayak, race a personal watercraft around the buoys, ride a horse through the surf. Or simply soak up the sun.*



## 5- to 7-Day Eastern Caribbean





## 7-Day Eastern Caribbean

Saturday Departures

### Roundtrip Ft. Lauderdale

#### 2006 SAILING DATES

*ms Zuiderdam*: Jan 7, 14, 21, 28;  
Feb 4, 11, 18, 25;  
Mar 4, 11, 18, 25;  
Apr 1, 8, 15

DAY	PORT	ARRIVE	DEPART
Sat	FT. LAUDERDALE, FLORIDA		5:00pm
Sun	Half Moon Cay, Bahamas*	8:00pm	4:00pm
Mon	At sea		
Tue	St. Thomas, U.S. Virgin Islands	8:00pm	11:00pm
Wed	Road Town, Tortola, British Virgin Islands	7:00am	6:00pm
Thu	At sea		
Fri	Nassau, Bahamas	1:00am	8:00pm
Sat	FT. LAUDERDALE, FLORIDA	8:00am	

◆ These sailings depart St. Thomas at 9:00pm.

\* Conditions permitting.

# Caribbean Ports of Call

And a sampling of shore excursions.

## CONTINUED DISCOVERIES

We continue to work out the details for fascinating onshore excursions. Many of the ports that currently show no featured excursions will be updated as information becomes available. Updates will be posted on our website at [www.hollandamerica.com](http://www.hollandamerica.com).

### **BASSE-TERRE, GUADELOUPE**

This butterfly-shaped paradise is made up of two islands, its wings connected by a drawbridge. Here, on the western wing, explore tropical rain forests, smoldering volcanoes and the reefs surrounding pristine Pigeon Island. *Sample shore excursions: Soufrière Volcano Tour; Pigeon Island Glass-bottom Boat.*

### **BASSETERRE, ST. KITTS**

Explore the capital's beautiful old churches, bustling Fort Street, a famed batik studio and a former slave market. *Sample shore excursions: St. Kitts ATV Tour; Catamaran & Snorkel Adventure; Nevis Beach Barbecue.*

### **BELIZE CITY, BELIZE**

An eco-tourist's paradise. Offshore, friendly stingrays glide over the second-longest barrier reef in the world; inland, brilliant butterflies loop through steamy jungles. *Sample shore excursions: Mayan Ruins of Xunantunich & Marimba Lunch; Shark Ray Alley & San Pedro.*

### **BRIDGETOWN, BARBADOS**

Lovely beaches, hills carpeted in sugar cane and a friendly island spirit (part Bajan, part British) await on Barbados. *Sample shore excursions: Natural Wonders of Barbados; Atlantis Odyssey Submarine; Harrison's Cave.*

### **CABRITS / ROSEAU, DOMINICA**

Wonderfully untouched. A sea of greenery where ferns grow 30 feet tall and orchids sprout from trees. Take in the thunder of Trafalgar Falls, breathtaking in triplicate; watch for the rare and beautiful Sisserou parrot, found only here. *Sample shore excursions: Emerald Pool & Rain Forest Drive; Hidden Treasures Adventure Hike & Caribbean Indians; Rain Forest Aerial Tram.*

### **CASTRIES / SOUFRIÈRE, ST. LUCIA**

The island that changed hands between France and Britain 14 times. Hence, both cricket and creole flourish; the world's only drive-in volcano bubbles. *Sample shore excursions: St. Lucian Heritage; Catamaran to Fond Doux Estate.*

### **COLÓN, PANAMA**

Sultry and scrappy, Colón began as the starting point of a railroad that carried prospectors across the Isthmus of Panama to the California gold fields. Today, as the second-largest duty-free port in the world, it is mahogany, bananas and coconuts that pass through its portals. *Sample shore excursions: Embera Indian Village Experience; Kayak in the Panama Canal; Fort San Lorenzo and Gatun Locks.*

### **COSTA MAYA, MEXICO**

The quiet side of Mexico. Here, along an unspoiled coastal paradise, archaeology buffs discover Mayan ruins shrouded in magic and mystery; divers find treasure in fantastic coral reefs. *Sample shore excursions: Kohunlich Mayan Ruins; Coral Reef Snorkel; 4x4 All-terrain Expedition.*

### **COZUMEL, MEXICO**

Once the destination of Mayan women paying homage to Ixchel, Mayan goddess of fertility, today ranked among the world's premier dive spots. Just a ferry ride away: the Mayan ruins of Tulum, spectacularly sited on the sea cliffs. *Sample shore excursions: Chac Tun Caverns & Mayan Riviera Beach; Mayan Ruins of Tulum; Snorkel at Chankanaab National Park; Clear Kayak Peek and Paddle.*

### **EL GUAMACHE, ISLA DE MARGARITA, VENEZUELA**

Quaint colonial villages, restorative mud baths and glorious unspoiled beaches await on this isle where once were harvested lustrous pearls for European society. *Sample shore excursions: Canaima National Park & Angel Falls by Air; Macanao 4-wheel-drive Beach Explorer; Catamaran Sail to Coche Island.*





Grand Turk

Bahamas

**FORT-DE-FRANCE, MARTINIQUE**

Stunning volcanic history (in 1902 Mont Pelée blew open with catastrophic force), rum distilleries and blooms in every tropical hue await on this verdant “Island of Flowers.” *Sample shore excursions: Tropical Tour & St. Pierre; Fort-de-France Historic Walking Tour; Martinique by Land & Sea.*

**FREEPORT, BAHAMAS**

Footloose and duty-free. Marvel at the array of goods from around the world at the ten-acre International Bazaar; sharpen your bartering skills at the lively straw market. Or simply browse the lush Garden of the Groves. *Sample shore excursions: Freeport Highlights Tour; Glass-bottom Boat; Lucayan National Park Kayak & Cave Tour.*

**GATUN LAKE, PANAMA CANAL**

At 23.5 miles long, Gatun Lake is one of the largest artificial lakes in the world and is essential to controlling the water level for the locks in the Panama Canal. It will take nearly 52 million gallons of fresh water from Gatun Lake to float your Holland America ship through the locks.

**GRAND TURK, TURKS & CAICOS ISLANDS**

Named for the fez-like, scarlet blossoms of the cactus that grows there, Grand Turk is a pristine place of simple pleasures. Just offshore discover the world’s largest coral reef system, teeming with marine life. On shore, dine on conch fritters and set your watch to “island time.”

**GEORGE TOWN, GRAND CAYMAN**

Crystalline waters, snorkeling with tame stingrays, civilian submarines: this duty-free port has them all, plus Seven Mile Beach and a charming turtle farm. *Sample shore excursions: Stingray City Cruise & Island Drive; Reef & Wreck Snorkel by Boat; Atlantis Deep-dive Submarine.*

**HALF MOON CAY, BAHAMAS**

Holland America Line’s pristine private island offers everything you need for a day of play in paradise: a two-mile crescent of perfect beach; an interior lagoon; private beachside cabanas with showers, misters and butlers; and all manner of watersports and activities, including a children’s aqua park and a buoyed personal watercraft course. *Sample shore excursions: Horseback Riding by Land and Sea; Deep-sea or Flats Fishing; Stingray Adventure; AquaTrax® Watercraft Adventure.*

**KEY WEST, FLORIDA**

An American town that moves to the sensuous rhythms of the Caribbean. Conch culture, coral reefs, sleek racing catamarans and rich fishing grounds await. *Sample shore excursions: Old Town Trolley & Conch Train; Key West Cup Regatta; World-class Light-tackle Fishing.*

**KRALENDIJK, BONAIRE**

Preservation rules on Bonaire, long known to divers and snorkelers for its pristine, unspoiled reefs. Feast your eyes on gorgeous coral gardens; take in the blush of thousands of pink flamingos reflected in the still salt lake, the hush of the mangroves. *Sample shore excursions: Samur Sail & Snorkel Adventure; Sportfishing; Nature Bike Tour; Mangrove Boat Tour.*

**LA ROMANA, DOMINICAN REPUBLIC**

Your portal to the island the House of Columbus built. In Santo Domingo, its bustling capital, visit the elaborate castle from which Diego Columbus ruled as viceroy and the majestic cathedral that entombs the remains of Christopher. *Sample shore excursions: Horseback Riding; Country Safari Adventure; Cat Sail & Snorkel; Tale of Two Cities.*



Willemstad, Curaçao

#### THE MEDALLION COLLECTION

Holland America Line is proud to present the Medallion Collection, a series of exclusive tours designed to accommodate our most discerning guests. Each has been carefully chosen to offer a truly different experience, providing an in-depth perspective and unparalleled access to events and sights not otherwise available. For more details, visit us online at [www.hollandamerica.com](http://www.hollandamerica.com).

#### NASSAU, BAHAMAS

Colorful, captivating Queen of the Bahamas. Choose from literally thousands of great dives, ranging from wrecks to reefs, blue holes to sea gardens; catch the pink flamingo show at the famed Ardastra Gardens, the action at the Straw Market. *Sample shore excursions: Nassau Helicopter Flightseeing; Stingray City Snorkel at Blue Lagoon; Nassau See & Sea.*

#### OCHO RIOS, JAMAICA

On the island that gives sway to reggae, drift dreamily down a tranquil river on a bamboo raft, sip a planter's punch on the porch of a restored Great House, climb the natural stone steps up Dunn's River Falls. *Sample shore excursions: Dolphin Cove and Dunn's River Falls; Mountain to Sea by Bicycle; Catamaran Sail & Beach Tour.*

#### ORANJESTAD, ARUBA

Colorful floating markets, wondrous coral reefs and landscapes dotted with curiously bent divi-divi trees await on this, the "A" of the Netherlands Antilles' famous ABC islands. (Bonaire and Curaçao round out the trio.) *Sample shore excursions: Natural Wonders of Aruba; Spanish Lagoon Kayak Adventure; Jolly Pirates, Sail, Snorkel, Swim & Swing.*

#### ORINOCO RIVER (SCENIC CRUISING)

The Amazon gets the press, but Rio Orinoco is also awesome by any measure. Home to the Warao, who live in stilt houses. Piranha and pink dolphins ruffle the water; howler monkeys and jaguars cross paths in the dense tropical jungle.

#### PHILIPSBURG, ST. MAARTEN

An island under two flags. On the Dutch side: chocolates, cheeses, casinos. On the French side: bistros, boulangeries and boutiques. *Sample shore excursions: Golden Eagle Catamaran Sail to Tintamar Island; Hidden Forest Adventure Hike & French Marigot; America's Cup Regatta; 4x4 Island Safari.*

#### PORT OF SPAIN, TRINIDAD

Vibrant, busy, constantly in tune with saucily suggestive calypso and resonant with the steel-pan sound that began here. Catch the rhythm at the cultural show; take in the spectacle of scarlet ibis as they take wing from their feeding grounds to roost in the trees at sunset, transforming the foliage into a blaze of scarlet. *Sample shore excursions: Port of Spain City & Mount St. Benedict Monastery; City Tour & Historic Lopinot Estate; Asa Wright Nature Center.*

#### PUERTO LIMÓN, COSTA RICA

A jumping-off point for Costa Rica's wonders. Ride an aerial tram through the rain forest canopy, cruise a jungle canal or take in the dazzling Jade and Gold Museum in San José. *Sample shore excursions: Rio Reventazon White Water Rafting; The Tortuguero Canals; Rain Forest Aerial Tram; San José Town & Country.*

#### PUERTO MOIN, COSTA RICA

Your portal to the treasures of Costa Rica's Caribbean coast. Turtle nesting grounds, rain forests, white-water rivers and tropical flower farms are all here. Plus, the mysterious Land of the Shaman. *Sample shore excursions: Rio Reventazon White-water Rafting; Rain Forest Aerial Tram; San José Town & Country.*

#### PUERTO ORDAZ (CIUDAD GUYANA), VENEZUELA

This industrial-strength port at the confluence of the Orinoco and Caroni rivers is your gateway to historic Ciudad Bolívar, home of the Great Liberator, Simon Bolívar; and Angel Falls, world's highest. *Sample shore excursions: Canaima National Park & Angel Falls by Air; Ciudad Bolívar; Ciudad Guyana Parks & Hydroelectric Plant.*

#### ROAD TOWN, TORTOLA, BRITISH VIRGIN ISLANDS

An enticing mix of pink and blue buildings, yachts, rum cocktails and pirate lore. Play on a soft sand beach or sail away to islands of buccaneer legend: Dead Chest, Great Dog, Treasure Island. *Sample shore excursions: The North Shore & Pusser's Landing; Wreck of the Rhone Two-tank Certified Dive; Virgin Gorda & The Baths; Swim with the Dolphins.*



St. George's, Grenada



Ocho Rios, Jamaica

**ROATÁN, HONDURAS**

An isle of wonders: lizards that run upright on their hind legs, brilliant macaws and parrots found only in Honduras, a reef second in size only to Australia's Great Barrier Reef.

*Sample shore excursions: Catamaran Sail & Snorkel; Dive with Sharks; Roatán West Side Island Tour.*

**SAN JUAN, PUERTO RICO**

By day, see the monuments: historic forts, the stately governor's mansion, Old San Juan. By night, do the town. There are roulette wheels to spin, fiery flamenco shows to catch. *Sample shore excursions: Old San Juan Historic Walking Tour; El Yunque Rain Forest Drive; World Heritage Fortress & Art Museum.*

**SANTA BÁRBARA DE SAMANÁ, DOMINICAN REPUBLIC**

Tranquil, tropical and perfectly situated for explorations of the Dominican Republic's finest treasures: unspoiled Bacardi Island; the amber-rich north coast; and Bahía de Samaná, mating and birthing ground for thousands of humpback whales. *Sample shore excursions: Los Haitises National Park; Samana Scenic 4x4 Safari.*

**SANTO TOMÁS DE CASTILLA, GUATEMALA**

Your portal to the fascinating Mayan ruins of Guatemala and Honduras: the mighty Acropolis of Quirigua National Park and Copán, Paris of the ancient Mayan world. Each an enigma waiting to be solved. *Sample shore excursions: Archaeological Copán & Honduras Countryside; Amatique Bay Resort; Quirigua Archaeological Ruins; Hacienda Tijax; Eco-adventure Hike.*

**ST. CROIX, U.S. VIRGIN ISLANDS**

An island with a multifarious past, St. Croix has flown the flags of the Dutch, English, French, Danish and the Knights of Malta. Today she proudly displays the American flag, and traces of her illustrious past — grand Victorian houses, the ruins of Danish sugar plantations and the restored Whim Greathouse — invite you to explore. *Sample shore excursions: Caribbean Sailing Adventure; Deep-sea Sportfishing; Sea Kayaking.*

**ST. GEORGE'S, GRENADA**

The heady scent of nutmeg, cinnamon and cloves turns breathing into an exotic experience. Here, too, find mountain waterfalls, white sand beaches and

lagoons of mottled blues. *Sample shore excursions: Star Wind Catamaran & Snorkel Adventure; Nature Trail & Beach Swim; Island Tour; Grand Etang Lake & Fort Frederick.*

**ST. JOHN'S, ANTIGUA**

Here find neatly restored Nelson's Dockyard (home of the invincible British Royal Navy during the Great Age of Sail), smooth Cavalier rum and 365 beautiful beaches, one for every day of the year. *Sample shore excursions: Historical Antigua; Off-road 4x4 Safari; Kayak & Snorkel Adventure; Dolphin & Stingray Adventure.*

**ST. THOMAS, U.S. VIRGIN ISLANDS**

The lovely, European-influenced port of Charlotte Amalie wins the prize for Caribbean shopping thrills. Cameras, jewelry, watches, perfumes are all here. So are beautiful beaches, undersea gardens and tales of Blackbeard. *Sample shore excursions: Sea Trekking Helmet Dive & Coral World; Champagne Catamaran Sail & Snorkel to St. John.*

**WILLEMSTAD, CURAÇAO**

Amsterdam-like canals, gabled Dutch colonial buildings, an exotic floating market. This bustling duty-free port has it all. Plus the world-famous Curaçao Liqueur Distillery and an intriguing coral reef teeming with parrotfish and queen angelfish. *Sample shore excursions: Spanish Water Snorkel Expedition; Curaçao See & Sea Tour; Highlights of Curaçao with Folkloric Show; Canoe Safari; Willemstad Trolley Train.*

# ms Noordam ms Westerdam ms Oosterdam ms Zuiderdam



ms Oosterdam Vista Show Lounge

ms Westerdam Hydro Pool

Spacious and airy, our new Vista-class ships offer all the amenities and comforts demanded by today's sophisticated travelers: more verandah staterooms, more dining choices, more understated elegance.

#### SHIP FEATURES

- Elegant two-tiered Dining Room, intimate reservations-only restaurant, poolside Terrace Grill, casual Windstar Café and the Lido Restaurant with its relaxed culinary courtyard
- Two outdoor swimming pools, The Greenhouse Spa & Salon, fitness center, golf simulator
- State-of-the-art show lounge, Casino, Nightclub, Internet Center
- Exclusive lounge and concierge service for guests staying in Penthouse and Deluxe Verandah Suites

#### SUITE AMENITIES

For guests choosing suite accommodations, Holland America Line offers a host of complimentary services that will forever spoil you for any other stateroom.

#### SUPERIOR VERANDAH SUITES (CATEGORIES SS—SZ)

- Personalized cruise stationery
- Elegant bathrobe for use on your cruise
- Fresh flowers and fruit assortment
- Luxurious beds featuring Sealy® Premium Euro-Top mattresses and finely woven cotton linens

- A no-host mini-bar for easy entertaining in your suite
- DVD player and access to an extensive DVD library

#### PENTHOUSE VERANDAH SUITES (CATEGORY PS) AND DELUXE VERANDAH SUITES (CATEGORIES SA—SC)

Includes all the Superior Verandah Suite amenities, plus:

- Use of the exclusive Neptune Lounge and personal concierge service
- Complimentary laundry, pressing and dry cleaning throughout your cruise
- Premium duvet, oversize bath towels and soft cotton bathrobes
- Gorgeous corsages and boutonnieres for the first formal night
- Hors d'oeuvres served before dinner each evening on request
- Binoculars and umbrellas for your use on the cruise
- VIP party with the Captain
- Priority boarding for tender ports of call





*ms Noordam*

*The Pinnacle Grill at the Odyssey*



# ms Noordam ms Westerdam ms Oosterdam ms Zuiderdam

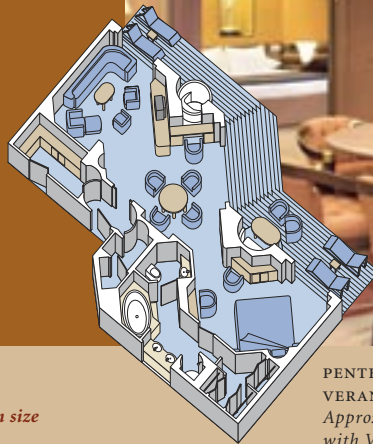

PENTHOUSE  
VERANDAH SUITE  
Approx. 1,318 sq. ft.  
with Verandah

NOTE: Room measurements are approximate, and some rooms in the same category may vary in size and/or have different furniture placement from that pictured.

column 1

## 7- TO 11-DAY CARIBBEAN 2005/2006/2007

	2005 Eastern/Western ms Westerdam/ms Zuiderdam 7-Day		2006/2007 Bahamas ms Westerdam 5-Day		2006/2007 Eastern/Western ms Westerdam/ms Zuiderdam 7-Day		2006/2007 Eastern ms Noordam 10-Day		2006/2007 Southern ms Noordam 11-Day		2005 Holiday Eastern/Western ms Westerdam 8-Day	
VERANDAH STATEROOMS	ES FROM	ES TO	ES	ES FROM	ES TO	ES FROM	ES TO	ES FROM	ES TO	ES FROM	ES TO	
PS Penthouse Verandah Suites	\$4,049	– \$6,049	\$3,559	\$3,944	– \$6,034	\$7,169	– \$9,269	\$7,169	– \$10,319	\$14,069	– \$14,969	
SA Deluxe Verandah Suites	1,942	– 2,867	2,229	2,434	– 3,414	4,299	– 5,229	4,299	– 5,699	6,389	– 7,289	
SB Deluxe Verandah Suites	N/A	N/A	1,979	2,184	– 3,164	3,799	– 4,729	3,799	– 5,199	5,639	– 6,539	
SC Deluxe Verandah Suites	N/A	N/A	1,729	1,934	– 2,914	3,299	– 4,229	3,299	– 4,699	4,889	– 5,789	
SS Superior Verandah Suites	1,349	– 1,979	1,409	1,614	– 2,314	2,699	– 3,359	2,699	– 3,689	3,849	– 4,749	
SY Superior Verandah Suites	N/A	N/A	1,249	1,399	– 2,114	2,399	– 3,059	2,399	– 3,389	3,399	– 4,299	
SZ Superior Verandah Suites	N/A	N/A	N/A	N/A	N/A	N/A	N/A	N/A	N/A	N/A	N/A	
VA Deluxe Verandah Outside	1,109	– 1,609	979	1,169	– 1,639	2,109	– 2,579	2,109	– 2,809	1,989	– 2,429	
VB Deluxe Verandah Outside	1,085	– 1,572	959	1,134	– 1,604	2,039	– 2,509	2,039	– 2,739	1,949	– 2,389	
VC Deluxe Verandah Outside	1,060	– 1,535	939	1,099	– 1,569	1,969	– 2,439	1,969	– 2,669	1,909	– 2,349	
VD Deluxe Verandah Outside	1,036	– 1,498	919	1,064	– 1,534	1,899	– 2,369	1,899	– 2,599	1,869	– 2,309	
VE Deluxe Verandah Outside	999	– 1,461	899	1,029	– 1,499	1,829	– 2,299	1,829	– 2,529	1,829	– 2,269	
VF Deluxe Verandah Outside	N/A	N/A	849	999	– 1,464	1,749	– 2,229	1,749	– 2,459	1,799	– 2,229	
VH Deluxe Verandah Outside	N/A	N/A	N/A	N/A	N/A	N/A	N/A	N/A	N/A	N/A	N/A	
OCEAN-VIEW STATEROOMS												
C Large	984	– 1,420	839	979	– 1,339	1,749	– 2,109	1,749	– 2,289	1,579	– 1,979	
D Large	964	– 1,391	819	954	– 1,314	1,699	– 2,059	1,699	– 2,239	1,539	– 1,939	
DD Large	945	– 1,361	799	929	– 1,289	1,649	– 2,009	1,649	– 2,189	1,499	– 1,899	
E Large	928	– 1,335	779	904	– 1,264	1,599	– 1,959	1,599	– 2,139	1,459	– 1,859	
F Large	903	– 1,298	759	879	– 1,239	1,549	– 1,909	1,549	– 2,089	1,419	– 1,819	
G Large	849	– 1,261	739	854	– 1,214	1,499	– 1,859	1,499	– 2,039	1,379	– 1,779	
GG Large	N/A	N/A	719	829	– 1,189	1,449	– 1,809	1,449	– 1,989	1,339	– 1,739	
H Large	N/A	N/A	699	799	– 1,164	1,399	– 1,759	1,399	– 1,939	1,299	– 1,699	
HH Large	N/A	N/A	N/A	N/A	N/A	N/A	N/A	N/A	N/A	N/A	N/A	
INSIDE STATEROOMS												
I Large	820	– 1,172	674	799	– 1,099	1,374	– 1,674	1,374	– 1,824	1,249	– 1,549	
J Large	800	– 1,143	659	779	– 1,079	1,339	– 1,639	1,339	– 1,789	1,219	– 1,519	
K Large	776	– 1,106	644	759	– 1,059	1,304	– 1,604	1,304	– 1,754	1,189	– 1,489	
L Standard	761	– 1,084	629	739	– 1,039	1,269	– 1,569	1,269	– 1,719	1,159	– 1,459	
M Standard	737	– 1,047	614	719	– 1,019	1,234	– 1,534	1,234	– 1,684	1,129	– 1,429	
<b>MM Standard ("From" Price)</b>	<b>699</b>	<b>– 999</b>	<b>599</b>	<b>699</b>	<b>– 999</b>	<b>1,199</b>	<b>– 1,499</b>	<b>1,199</b>	<b>– 1,649</b>	<b>1,099</b>	<b>– 1,399</b>	
N Standard	N/A	N/A	N/A	N/A	N/A	N/A	N/A	N/A	N/A	N/A	N/A	
NN Standard	N/A	N/A	N/A	N/A	N/A	N/A	N/A	N/A	N/A	N/A	N/A	
* 3rd/4th Person Adult	499	699	370	545	545	780	780	870	870	1,060	1,060	
* 3rd/4th Person Child (2–18)	399	599	370	445	445	780	780	870	870	1,060	1,060	
* Infant – Under Age 2	304	504	260	305	305	450	450	450	450	410	410	
■ Non-Discountable Amount INCLUDED	129	129	110	155	155	200	200	200	200	160	160	
● Taxes	78.88	78.88	51.67	67.77	67.77	84.77	84.77	88.27	88.27	86.64	86.64	
Deposit Requirement	350	350	350	350	350	600	600	600	600	350	350	

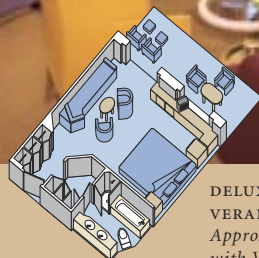

**DELUXE VERANDAH SUITE**  
Approx. 510 sq. ft.  
with Verandah

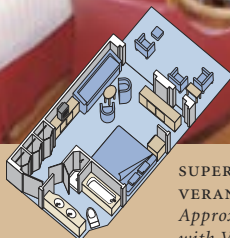
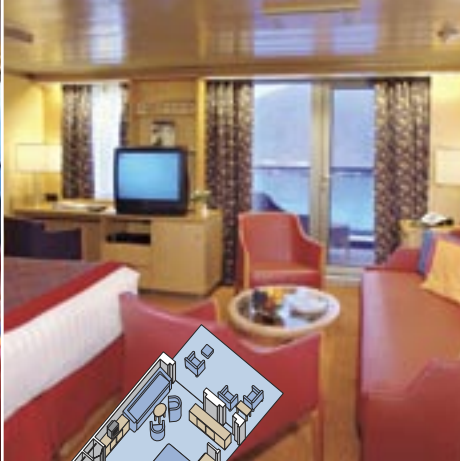

**SUPERIOR VERANDAH SUITE**  
Approx. 389 sq. ft.  
with Verandah

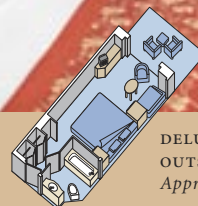

**DELUXE VERANDAH OUTSIDE DOUBLE**  
Approx. 249 sq. ft.

column 2

5- TO 8-DAY MEXICO 2005/2006/2007

2005 Holiday Eastern <i>ms Zuiderdam</i> 8-Day		2005 Sea of Cortez <i>ms Oosterdam</i> 5-Day			2005 Mexican Riviera <i>ms Oosterdam</i> 7-Day			2006/2007 Mexican Riviera <i>ms Oosterdam</i> 7-Day		2005 Holiday Mexican Riviera/Sea of Cortez <i>ms Oosterdam</i> 8-Day	
ES FROM	ES TO	ES	ES FROM	ES TO	ES FROM	ES TO	ES FROM	ES TO	ES FROM	ES TO	
\$14,169	– \$14,269	\$2,796	\$3,910	– \$5,030	\$3,884	– \$6,024	\$14,169	– \$14,269			
6,489	– 6,589	1,352	1,889	– 2,407	2,814	– 3,764	6,489	– 6,589			
5,739	– 5,839	N/A	N/A	N/A	2,314	– 3,264	5,739	– 5,839			
4,989	– 5,089	N/A	N/A	N/A	1,814	– 2,764	4,989	– 5,089			
3,949	– 4,049	949	1,299	– 1,675	1,484	– 2,154	3,949	– 4,049			
3,499	– 3,599	N/A	N/A	N/A	1,349	– 1,999	3,499	– 3,599			
N/A	N/A	N/A	N/A	N/A	N/A	N/A	N/A	N/A			
2,089	– 2,189	781	1,090	– 1,370	1,169	– 1,624	2,089	– 2,189			
2,049	– 2,149	765	1,067	– 1,340	1,134	– 1,589	2,049	– 2,149			
2,009	– 2,109	748	1,043	– 1,309	1,099	– 1,554	2,009	– 2,109			
1,969	– 2,069	731	1,020	– 1,279	1,064	– 1,519	1,969	– 2,069			
1,929	– 2,029	699	999	– 1,248	1,029	– 1,484	1,929	– 2,029			
1,899	– 1,989	N/A	N/A	N/A	999	– 1,449	1,899	– 1,989			
N/A	N/A	N/A	N/A	N/A	N/A	N/A	N/A	N/A			
1,679	– 1,779	696	970	– 1,214	979	– 1,324	1,679	– 1,779			
1,639	– 1,739	682	951	– 1,190	954	– 1,299	1,639	– 1,739			
1,599	– 1,699	669	933	– 1,166	929	– 1,274	1,599	– 1,699			
1,559	– 1,659	657	916	– 1,144	904	– 1,249	1,559	– 1,659			
1,519	– 1,619	640	893	– 1,114	879	– 1,224	1,519	– 1,619			
1,479	– 1,579	599	849	– 1,083	854	– 1,199	1,479	– 1,579			
1,439	– 1,539	N/A	N/A	N/A	829	– 1,174	1,439	– 1,539			
1,399	– 1,499	N/A	N/A	N/A	799	– 1,149	1,399	– 1,499			
N/A	N/A	N/A	N/A	N/A	N/A	N/A	N/A	N/A			
1,349	– 1,449	583	813	– 1,010	799	– 1,099	1,349	– 1,449			
1,319	– 1,419	570	794	– 986	779	– 1,079	1,319	– 1,419			
1,289	– 1,389	553	770	– 955	759	– 1,059	1,289	– 1,389			
1,259	– 1,359	543	756	– 937	739	– 1,039	1,259	– 1,359			
1,229	– 1,329	526	733	– 906	719	– 1,019	1,229	– 1,329			
<b>1,199</b>	<b>– 1,299</b>	<b>499</b>	<b>699</b>	<b>– 869</b>	<b>699</b>	<b>– 999</b>	<b>1,199</b>	<b>– 1,299</b>			
N/A	N/A	N/A	N/A	N/A	N/A	N/A	N/A	N/A			
N/A	N/A	N/A	N/A	N/A	N/A	N/A	N/A	N/A			
1,060	1,060	360	520	520	545	545	1,060	1,060			
1,060	1,060	360	420	420	445	445	1,060	1,060			
410	410	210	300	300	305	305	410	410			
160	160	110	150	150	155	155	160	160			
66.40	66.40	49.66	74.04	74.04	58.18	58.18	67.18	67.18			
350	350	350	350	350	350	350	350	350			

Fares in U.S. dollars per person based on double occupancy.

- ✦ Fares are available in Canadian dollars. Please see your travel agent for details.
- \* Based on sharing accommodations with two full-fare guests.
- Non-Discountable Amounts are included in fares presented.
- Taxes are additional.

Single Partners Program: categories F and K.  
Single Occupancy: categories PS–VF at 190% of double occupancy; categories C–NN at 150% of double occupancy.

**2005**  
Single Partners Program: categories F and K.  
Single Occupancy: categories PS–VH at 190% of double occupancy; categories C–NN at 150% of double occupancy.

**2006**  
Single Partners Program: categories D and K.  
Single Occupancy: categories PS–VH at 190% of double occupancy; categories C–NN at 150% of double occupancy.

**2006 Holiday Fares available upon request.**

**Early Savings (ES):** The fares shown are early savings fares and are subject to change. Book early to ensure the best possible rate.

**MAIN DECK**  
Staterooms 1001-1127  
252 ft. from bow  
to Staterooms 1001 & 1002.

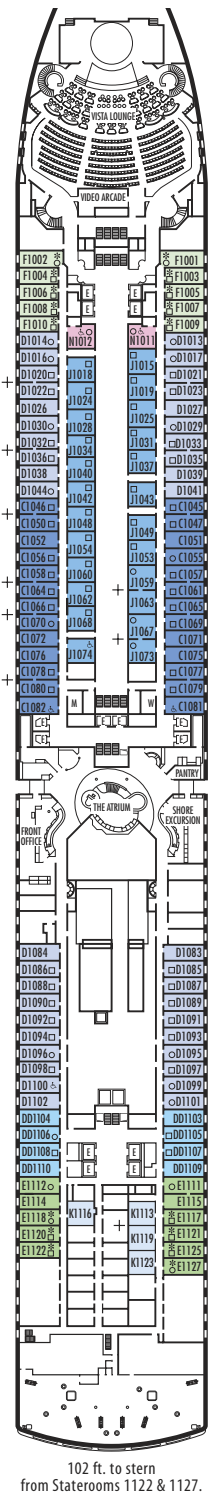

**LOWER PROMENADE DECK**

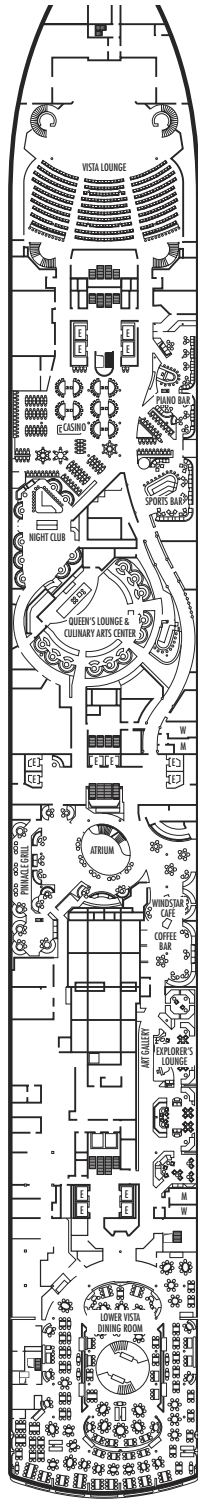

**PROMENADE DECK**

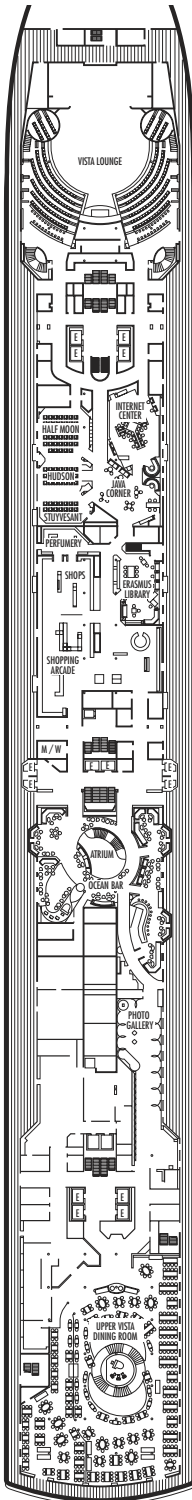

**UPPER PROMENADE DECK**  
Staterooms 4001-4185  
1022 ft. from bow  
to Staterooms 4001 & 4002.

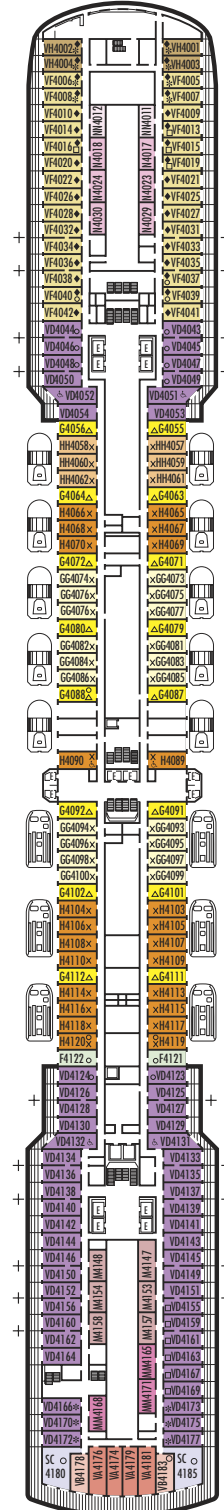

**VERANDAH DECK**  
Staterooms 5001-5187  
102 ft. from bow  
to Staterooms 5001 & 5002.

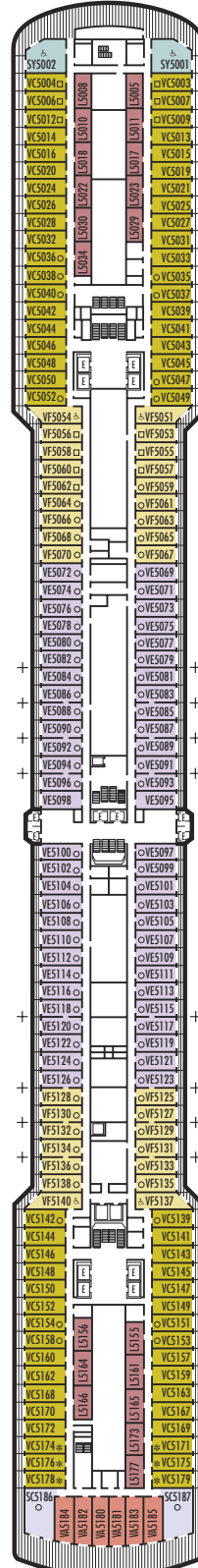

**UPPER VERANDAH DECK**  
Staterooms 6001-6169  
112 ft. from bow  
to Staterooms 6003 & 6004.

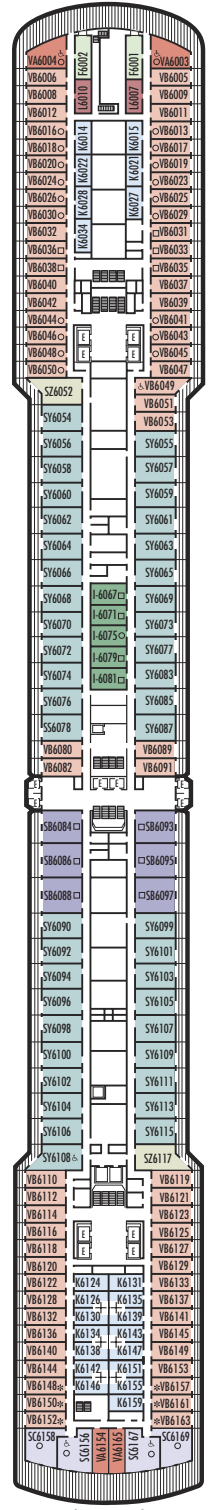

**SHIP SPECIFICATIONS & FACILITIES**

- 1,848 Guests
- 82,000 Gross Tons
- 950 Feet Long
- Automatic Stabilizers
- 11 Guest Decks
- 14 Guest Elevators
- 4 Outside Elevators
- 24 Public Rooms
- 4 Restaurants
- Outdoor Swimming Pools (one with sliding glass roof)
- Spa & Salon
- Two Show Lounges
- Duty-free Shops
- Library
- Casino
- Fitness Center
- Basketball Court
- Volleyball Court
- Golf Simulator
- Internet Center
- Suite Lounge



**ROTTERDAM DECK**  
Staterooms 7001-7133  
121 ft. from bow  
to Staterooms 7001 & 7002.

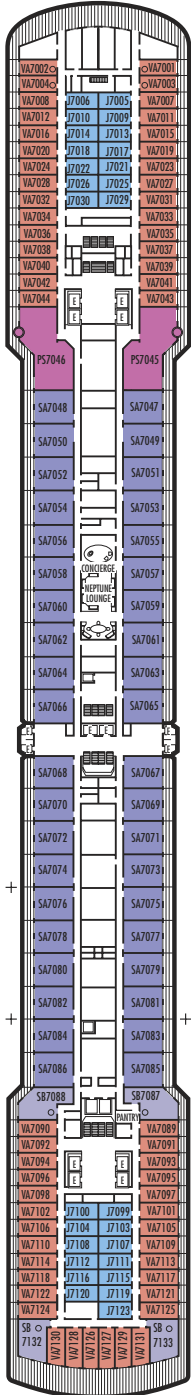

56 ft. to stern from Staterooms 7132, 7130, 7128, 7126, 7127, 7129, 7131 & 7133.

**NAVIGATION DECK**  
Staterooms 8001-8135  
186 ft. from bow  
to Staterooms 8001 & 8002.

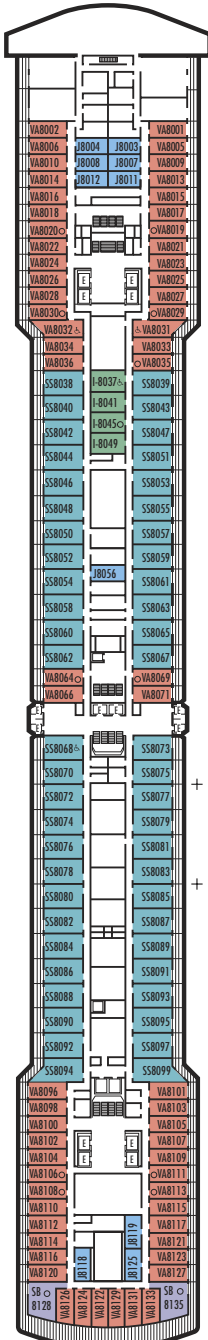

68 ft. to stern from Staterooms 8128, 8126, 8124, 8122, 8129, 8131, 8133, & 8135.

**LIDO DECK**

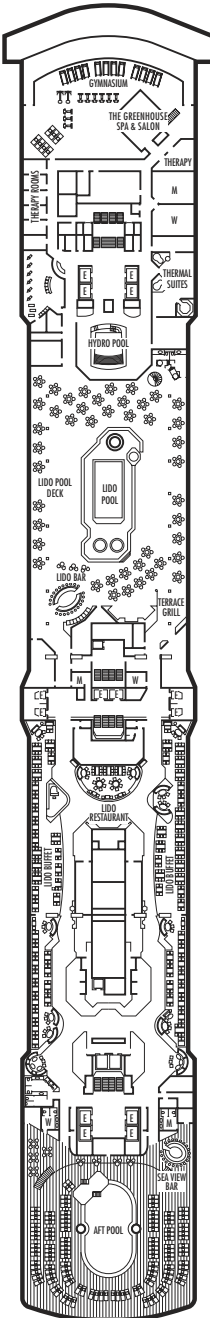

**OBSERVATION DECK**

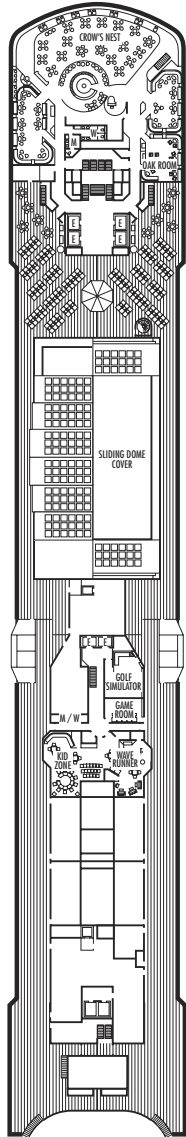

**SPORTS DECK**

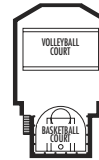
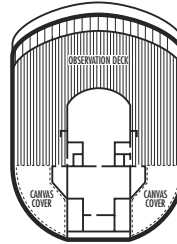

**ms Westerdam**  
**ms Oosterdam**  
**ms Zuiderdam**  
**ms Noordam**

**DECK PLANS & STATEROOMS**

The deck plans are color-coded by category of stateroom, and the category letter precedes the stateroom number in each room. All staterooms are equipped with television, mini-bar, DVD player\*, mini-safe, data port, telephone and multi-channel music.

**Important Note:** Not all staterooms within each category have the same furniture configuration and/or facilities. Appropriate symbols within the rooms on the deck plans describe differences from the stateroom descriptions below.

**VERANDAH SUITES**

**PS**  
**Penthouse Verandah Suites:** Bedroom with 1 king-size bed, oversize whirlpool bath & shower & additional shower stall, living room, dining room, dressing room, private verandah with whirlpool, pantry, 1 sofa bed for 2 persons, microwave, refrigerator, guest toilet, private stereo system, floor-to-ceiling windows.

SA SB SC

**Deluxe Verandah Suites:** 2 lower beds convertible to 1 king-size bed, bathroom with dual sink vanity, full-size whirlpool bath & shower & additional shower stall, large sitting area, dressing room, private verandah, 1 sofa bed for 2 persons, floor-to-ceiling windows.

SS SY SZ

**Superior Verandah Suites:** 2 lower beds convertible to 1 queen-size bed, bathroom with dual sink vanity, full-size whirlpool bath & shower & additional shower stall, large sitting area, dressing room, private verandah, 1 sofa bed for 1 person, floor-to-ceiling windows.

**VERANDAH STATEROOMS**

VA VB VD VE  
**Deluxe Verandah Outside:** 2 lower beds convertible to 1 queen-size bed, bath & shower, sitting area, private verandah, floor-to-ceiling windows.

VC VF VH

**Deluxe Verandah Outside:** 2 lower beds convertible to 1 queen-size bed, bath with tub or shower, sitting area, private verandah, floor-to-ceiling windows.

**OUTSIDE STATEROOMS**

C D DD E F  
**Large:** 2 lower beds convertible to 1 queen-size bed, bathtub & shower.

G GG

**Large:** 2 lower beds convertible to 1 queen-size bed, bathtub & shower. All G-category staterooms have partial sea views. All GG-category staterooms have fully obstructed views.

H HH

**Large:** 2 lower beds convertible to 1 queen-size bed, bathtub & shower. All H- & HH-category staterooms have fully obstructed views.

**INSIDE STATEROOMS**

I  
**Large:** 2 lower beds convertible to 1 queen-size bed, shower.

J K

**Large or Standard:** 2 lower beds convertible to 1 queen-size bed, shower.

L M MM N NN

**Standard:** 2 lower beds convertible to 1 queen-size bed, shower.

\*DVD players will be available in all staterooms for ms Westerdam after April 27, 2005; ms Zuiderdam after December 22, 2005; ms Oosterdam after October 3, 2006. Currently, categories PS-SZ have DVD players. All other categories are equipped with televisions only.

For sailings prior to Holiday 2005 please see the Holland America website at [www.hollandamerica.com](http://www.hollandamerica.com) for stateroom category information.

**STATEROOM SYMBOL LEGEND**

- \* Shower only
- Triple (2 lower beds, 1 sofa bed)
- Quad (2 lower beds, 1 sofa bed, 1 upper)
- △ Partial sea view
- × Fully obstructed view
- ✚ Connecting rooms
- ◆ Staterooms have solid steel verandah railing instead of clear-view Plexiglas railing
- ♿ Staterooms SC6156, SC6167, SY5001, SY5002, SY6108, SS8068, VA6003, VA6004, VA8031, VA8032, VB6049, VD4051, VD4052, VD4131, VD4132, VF5051, VF5054, VF5137, VF5140, C1081, C1082, D1100, H4089, H4090, I-8037, J1074, N1011, N1012 are wheelchair accessible, shower only.

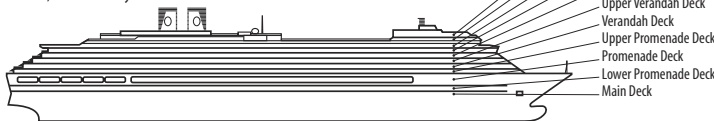

# Hotel Packages

A few extra days to relax and enjoy.

## PRE- AND POST-CRUISE HOTEL ACCOMMODATIONS

### ACAPULCO, MEXICO

ACAPULCO PRINCESS 2005	1 NIGHT	2 NIGHTS	3 NIGHTS
Shared Double	us\$100	us\$170	us\$240
Single Occupancy	165	305	445
3rd Person	65	95	125
2006	1 NIGHT	2 NIGHTS	3 NIGHTS
Shared Double	us\$115	us\$195	us\$275
Single Occupancy	195	350	505
3rd Person	65	95	125

### FT. LAUDERDALE, FLORIDA

HYATT REGENCY PIER 66 HOTEL Apr 1 – 30, and Oct 1 – Dec 25, 2005	1 NIGHT	2 NIGHTS	3 NIGHTS
Shared Double	us\$115	us\$210	us\$305
Single Occupancy	210	400	590
3rd Person	35	50	65
May 1 – Sep 30, 2005	1 NIGHT	2 NIGHTS	3 NIGHTS
Shared Double	us\$95	us\$170	us\$245
Single Occupancy	170	320	470
3rd Person	35	50	65

### FT. LAUDERDALE MARINA MARRIOTT

2006	1 NIGHT	2 NIGHTS	3 NIGHTS
Shared Double	us\$120	us\$220	us\$320
Single Occupancy	220	420	620
3rd Person	20	20	20

### WESTIN FT. LAUDERDALE

2005	1 NIGHT	2 NIGHTS	3 NIGHTS
Shared Double	us\$65	us\$110	us\$155
Single Occupancy	110	200	290
3rd Person	25	35	45
2006	1 NIGHT	2 NIGHTS	3 NIGHTS
Shared Double	us\$60	us\$105	us\$150
Single Occupancy	105	195	285
3rd Person	20	30	40

### LOS ANGELES, CALIFORNIA

WESTIN LONG BEACH 2005	1 NIGHT	2 NIGHTS	3 NIGHTS
Shared Double	us\$105	us\$175	us\$245
Single Occupancy	170	310	450
3rd Person	65	95	125
2006	1 NIGHT	2 NIGHTS	3 NIGHTS
Shared Double	us\$90	us\$160	us\$230
Single Occupancy	160	300	440
3rd Person	45	75	105

### NEW YORK, NEW YORK

HILTON TOWERS NEW YORK* Jan 1 – Mar 31, 2006	1 NIGHT	2 NIGHTS	3 NIGHTS
Shared Double	us\$190	us\$305	us\$420
Single Occupancy	305	535	765
3rd Person	100	130	160
Apr 1 – May 31, 2006	1 NIGHT	2 NIGHTS	3 NIGHTS
Shared Double	us\$210	us\$350	us\$490
Single Occupancy	345	625	905
3rd Person	100	130	160
Sep 1 – Nov 30, 2006	1 NIGHT	2 NIGHTS	3 NIGHTS
Shared Double	us\$255	us\$435	us\$615
Single Occupancy	435	795	1,155
3rd Person	115	160	205
Dec 1 – Dec 31, 2006	1 NIGHT	2 NIGHTS	3 NIGHTS
Shared Double	us\$270	us\$470	us\$670
Single Occupancy	470	870	1,270
3rd Person	100	130	160

### NORFOLK, VIRGINIA

NORFOLK MARRIOTT WATERSIDE 2005	1 NIGHT	2 NIGHTS	3 NIGHTS
Shared Double	us\$110	us\$185	us\$260
Single Occupancy	185	335	485
3rd Person	35	35	35
2006	1 NIGHT	2 NIGHTS	3 NIGHTS
Shared Double	us\$125	us\$195	us\$265
Single Occupancy	200	340	480
3rd Person	50	50	50

### PORTLAND, OREGON

PORTLAND MARRIOTT CITY CENTER 2006	1 NIGHT	2 NIGHTS	3 NIGHTS
Shared Double	us\$100	us\$165	us\$230
Single Occupancy	165	295	425
3rd Person	35	35	35

### PUERTO VALLARTA, MEXICO

CASAMAGNA MARRIOTT RESORT 2005	1 NIGHT	2 NIGHTS	3 NIGHTS
Shared Double	us\$100	us\$165	us\$230
Single Occupancy	165	295	425
3rd Person	40	40	40
Apr, 2006	1 NIGHT	2 NIGHTS	3 NIGHTS
Shared Double	us\$105	us\$170	us\$235
Single Occupancy	170	300	430
3rd Person	35	35	35
May, Sep, Oct 2006	1 NIGHT	2 NIGHTS	3 NIGHTS
Shared Double	us\$95	us\$150	us\$205
Single Occupancy	155	265	375
3rd Person	35	35	35

### SAN DIEGO, CALIFORNIA

SHERATON SAN DIEGO 2005	1 NIGHT	2 NIGHTS	3 NIGHTS
Shared Double	us\$170	us\$290	us\$410
Single Occupancy	290	530	770
3rd Person	75	105	135
2006	1 NIGHT	2 NIGHTS	3 NIGHTS
Shared Double	us\$135	us\$245	us\$355
Single Occupancy	245	465	685
3rd Person	50	75	100

### SAN FRANCISCO, CALIFORNIA

RENAISSANCE PARC 55 2005	1 NIGHT	2 NIGHTS	3 NIGHTS
Shared Double	us\$130	us\$220	us\$310
Single Occupancy	220	400	580
3rd Person	35	35	35
SHERATON FISHERMAN'S WHARF 2006	1 NIGHT	2 NIGHTS	3 NIGHTS
Shared Double	us\$125	us\$215	us\$305
Single Occupancy	215	395	575
3rd Person	65	95	125

### SEATTLE, WASHINGTON

SHERATON SEATTLE 2005	1 NIGHT	2 NIGHTS	3 NIGHTS
Shared Double	us\$140	us\$240	us\$340
Single Occupancy	240	440	640
3rd Person	70	100	130
2006	1 NIGHT	2 NIGHTS	3 NIGHTS
Shared Double	us\$120	us\$215	us\$310
Single Occupancy	220	410	600
3rd Person	50	80	110

# Before You Go

## Helping you plan your cruise.

### Puerto Vallarta, Mexico

#### TAMPA, FLORIDA

TAMPA MARRIOTT WATERSIDE 2005	1 NIGHT	2 NIGHTS	3 NIGHTS
Shared Double	us\$85	us\$150	us\$215
Single Occupancy	155	285	415
3rd Person	20	20	20

GRAND HYATT TAMPA BAY 2006	1 NIGHT	2 NIGHTS	3 NIGHTS
Shared Double	us\$135	us\$245	us\$355
Single Occupancy	245	465	685
3rd Person	55	90	125

#### VANCOUVER, BRITISH COLUMBIA

PAN PACIFIC HOTEL 2005	1 NIGHT	2 NIGHTS	3 NIGHTS
Shared Double	us\$125	us\$210	us\$295
Single Occupancy	210	380	550
3rd Person	75	115	155

2006	1 NIGHT	2 NIGHTS	3 NIGHTS
Shared Double	us\$150	us\$260	us\$370
Single Occupancy	260	480	700
3rd Person	75	115	155

- ♦ *Hotels of equal standard may be substituted when necessary.*

*Rates for hotels are per person and include applicable room taxes and bellman gratuities.*

*Optional Tour Inclusions: Fares are per person and include applicable room taxes and bellman gratuities unless noted otherwise. Holland America Line may substitute hotels of equal standard where necessary. Components of a tour itinerary may be operated in a different order than shown. A minimum number of guests may be required for a tour to operate. All fares are in U.S. dollars and are subject to change.*

*Guests must have a valid passport, necessary visas and any required immunizations prior to participation in a pre- or post-cruise tour. Guests are responsible for incidentals and meals unless noted otherwise.*

*Cancelling pre- and post-cruise hotels and/or tours between 16–45 days before commencing your cruise will result in a cancellation fee of 50% of the total amount; the fee increases to 100% for cancellations less than 16 days before commencing travel.*

*It is a privilege to welcome you on board our ships, and it is our sincere desire that you enjoy an extraordinary vacation. Here are answers to the questions we are frequently asked.*

#### **How do I make Dining Room reservations?**

Whatever your dining preferences — early or main sitting, for two or groupings of four, six or eight guests, with family or friends — Holland America Line will make every effort to honor your request. All dining requests should be made in advance of sailing through your travel agent and confirmed or waitlisted at the time of booking.

Upon embarkation you will find a confirmation card in your stateroom confirming your seating assignment and table number. If, for some reason, your dining request was not submitted before your cruise date, the Maitre d' will assign you to the sitting that is available.

#### **Normal meal hours in the main Dining Room are:**

Breakfast	Open seating	8:00AM
Lunch	Open seating	12:30PM
Dinner	Early sitting	5:45PM
	Upper level of Dining Room	
	Early sitting	6:15PM
	Lower level of Dining Room	
	Main sitting	8:00PM
	Upper level of Dining Room	
	Main sitting	8:30PM
	Lower level of Dining Room	

*ms Prinsendam* has two dinner sittings:  
 First sitting 6:00PM  
 Second sitting 8:15PM

#### **Alternate Dining Rooms**

Our intimate reservations-only restaurants — a delicious alternative to the main Dining Room — are very popular. We recommend you make reservations early in your cruise.

#### **What provisions for children are made on board?**

For infants, Holland America Line provides baby food, diapers, high chairs, booster chairs and cribs for a nominal fee, upon special request (30 days notice) via your travel agent or by calling Ship Services at 1-800-541-1576. For our younger guests, Holland America's **Club HAL®** program offers fully supervised activities, games, parties, menus and shore activities — broken out by ages 5–8, 9–12 and teens 13–17. Specific ships offer children's programs starting at age 3. Please call for details.

#### **Can you accommodate special diets?**

We make every effort to accommodate special dietary requests, including vegetarian, fat-free, sugar- or salt-free if advised at time of booking. Kosher\*, gluten-free or special medical diets must be pre-ordered a minimum of 90 days prior to sailing.

- \* *Kosher meals are prepared off the ship in a kosher kitchen, frozen and brought to the table sealed in their original containers. There is no kosher kitchen on board.*

# Smooth Air Travel

Connecting to your cruise.



*Flight delays, diversions, cancellations — with Holland America's Fly Cruise Plan you have the resources of our entire air/sea staff behind you.*

## HOLLAND AMERICA'S FLY CRUISE PLAN

In these changing times, it's worth every dollar — and then some.

When your air travel is arranged through Holland America Line, you are automatically enrolled in our Fly Cruise Plan, a program which entitles you to a whole host of benefits:

- **FLIGHT DELAY ASSISTANCE** *If your flight to the embarkation city is delayed, we'll make sure someone is at the airport to meet you and help you with your luggage.*
- **FLIGHT CANCELLATION ASSISTANCE** *If your flight is cancelled or a revised schedule no longer connects to the ship or tour, we will alter your ticket at no charge; if necessary, we'll even rebook on an alternate airline.*
- **TRANSFER SERVICE** *We include all transfers between airport and ship, ship and hotel, hotel and airport.*
- **CUSTOM TRAVEL** *Our AirPlus Service® allows guests to select which airlines they prefer, upgrade flight class, and/or travel to and from their (dis)embarkation port on dates other than those usually booked.*

## AIR RATES/AIR TAXES/FEES

Air rates will be quoted and are subject to change until the booking is paid in full. Quoted rates do not include Passenger Facility Charges (US\$3–\$27), federal flight segment fees for each flight segment (take off and landing) of US\$3.20, the September 11 Security Fee of US\$2.50 per passenger enplanement (up to a maximum of \$10), and international arrival and departure taxes (US\$3–\$100).



## AIRPLUS SERVICE®

AirPlus Service is available for Fly Cruise guests who wish to customize their air travel. Popular options include:

- Scheduling your travel to allow for an extended stay either before or after your cruise
- Upgrading to First or Business class, subject to availability
- Choosing preferred airlines to gain credit for mileage programs, or because your plans require a certain flight or particular time
- Designating a different gateway city than the one closest to home

Written requests should be faxed to AirPlus Service at (206) 298-3008 or mailed to:

Holland America Line Inc.  
Attn: AirPlus Service  
300 Elliott Avenue West  
Seattle, WA 98119

# Mariner Society®

*"Once aboard, never forgotten." Our past guests are members of a distinguished travel group known as the Mariner Society. Membership is automatic and entitles you to special rewards and extra privileges like these. Whether you've cruised with us fifty times or just once, we're honored to welcome you aboard again as a special and honored guest, a Mariner.*

## PREFERRED PRICING

- Special Mariner fares (on select sailings), and even savings for relatives and friends

## SPECIAL EVENTS AND GIFTS

- Mariner lapel pins, luggage tags, special pillow gifts

- Invitation to a Mariners-only Champagne reception and awards ceremony, hosted by the Captain

## MARINER® MAGAZINE

- Complimentary subscription to our travel magazine, featuring news and Mariner Society updates

Requests should be submitted prior to final payment in order to assure proper consideration. All requests are subject to availability and are not guaranteed. If confirmation is possible, a us\$50 non-refundable service charge and additional airline costs incurred will be assessed. A service charge will be assessed for each additional request that is confirmed. **Confirmed requests to fly in early or fly out late forfeit the associated transfer.**

## BOOK EARLY

The availability of the air rates that we have arranged may be limited. Therefore, it is advantageous for you to book your vacation as early as possible. We reserve the right to limit or close sales from cities without notice.

## LIABILITY AND RELATION WITH AIRLINES

We reserve the right to use the carriers, routing, and fare structure of our choice, and to utilize commuter and/or charter air service without prior notice. As the airfares we use are based on capacity-controlled, promotional, and group fares, we may limit or close sales without prior notice at any time. If, due to any cause beyond our control, we are unable to arrange for air travel or the air travel we arrange is unavailable or otherwise fails to materialize, our liability will be limited to refunding the air add-on amount paid to us. We assume no liability for any acts or omissions of any airline, including, without limitation, those involving cancellation of flights, schedule changes, re-routings, damage to or delay or loss of baggage, flight delays, equipment failures, accidents, pilot or other staff shortages, overbooking or computer errors. The liabilities and obligations of an airline to you, and your rights against an airline, are subject to any and all terms and conditions of the airline's ticket and tariffs.

## SEAT ASSIGNMENTS/SPECIAL REQUESTS

We cannot confirm seat assignment requests or requests for special meals or other special services not mentioned in this brochure. Your travel agent may assist with these arrangements once you receive your tickets. Some airlines or charter operators may not offer advance seat assignments. Guests traveling with other guests who originate from different cities or who request the Fly Cruise Plan at a later time may not receive routing on the same flights.

## AIR CHANGES/REFUNDS

Changes to existing reservations initiated by guests will result in a rescheduling charge of us\$100 per guest if the changes are made after the final payment due date. Airline tickets are issued based on fares which are highly restrictive and often cannot be reissued or exchanged for another carrier or routing.

Departures prior to May 2006: A fee of us\$100 will be assessed for guests who delete the Fly Cruise Plan from their booking.

Departures May 2006/after: Refer to the Cancellation Policy on page 124. The maximum refund for unused air tickets will not exceed the air add-on paid to us. There are no partial refunds. Due to changing airline tariffs, your tickets may reflect fares higher or lower than our air add-on amounts. The difference is neither chargeable nor refundable.

## BAGGAGE

Baggage allowance is governed by airline regulations. Excess baggage charges are the responsibility of the guest. We assume no responsibility for loss, damage, or delay while baggage is in the custody of airlines.

## OVERNIGHT HOTEL ACCOMMODATIONS

It may be necessary to overnight guests en route to or from their cruise due to airline schedules and/or availability. If necessary, the cost of hotel accommodations is not included in the air add-on amounts. Hotels will be selected by Holland America Line and may not be at the port of (dis)embarkation. Guests are responsible for hotel accommodations, meals and items of a personal nature.

## TRANSFERS

A complimentary transfer service between the airport and the ship will be provided for Fly Cruise guests whose flights arrive or depart on (dis)embarkation day only.

## CRUISE-ONLY GUESTS

We recommend that you schedule a minimum of four hours both at the beginning and end of your cruise to allow for transfers, customs clearance and airport security checks.

Note: If you purchase air transportation independently from Holland America Line, you will be responsible for any and all expenses incurred when joining the vessel in progress.

## HOME CITY MOTOR COACH SERVICE

Roundtrip motor coach service is available from the cities listed below for cruises departing from Ft. Lauderdale. Home City Motor Coach program is available only on cruises which embark and disembark from the same port (not available on one-way cruises). A us\$50 per-person fee will apply.

## CRUISES DEPARTING FROM FT. LAUDERDALE:

Boca Raton, FL	Orlando, FL
Bradenton, FL	Palm Coast, FL
Clearwater, FL	Port Charlotte, FL
Daytona Beach, FL	St. Petersburg, FL
Ft. Myers, FL	St. Augustine, FL
Ft. Pierce, FL	Sarasota, FL
Jacksonville, FL	Stuart, FL
Lady Lake, FL	Sun City, FL
Leesburg, FL	Tampa, FL
Melbourne, FL	Vero Beach, FL
Naples, FL	Venice, FL
Ocala, FL	West Palm Beach, FL



## AMTRAK® TRAIN TRAVEL

Travel by Amtrak and receive special discounts up to 25%\* on travel between cities in the U.S. & Canada and select Holland America Line ports of embarkation. Simply book your cruise and call Amtrak at 1-800-USA-RAIL for train travel information and reservations.

\* Restrictions apply.

Amtrak is a registered trademark and service mark of the National Railroad Passenger Corporation.

# Details, Details

## Important policies for your review.

### RESERVATIONS

Travel agencies provide valuable service and counseling to prospective travelers. We encourage you to make your Holland America reservations with a travel agent who understands your individual needs. Travel agencies are not owned or controlled by Holland America Line. Your deposits and payments for Holland America's services are to be paid to the travel agency with which you made your reservations. Since accommodations are limited by the number of staterooms on each ship, reservations should be made as early as possible. Travel documents will be issued only if and when full payment has been received by Holland America Line from the travel agency. Refunds for cancelled or unused services will normally be made to the same travel agency on the basis of the amount actually received by Holland America Line less any applicable cancellation fees and charges. You are responsible for obtaining from your travel agency monies either retained by the agency or received by the agency from Holland America Line. For further information visit our website at [www.hollandamerica.com](http://www.hollandamerica.com) or call 1-877-SAIL HAL. Guests under 21 years of age must be accompanied by a parent, guardian or chaperone who is at least 25 years old; one adult chaperone is required for every five people under 21.

### DEPOSIT AND FINAL PAYMENT REQUIREMENTS

The per-person, per-cruise deposit requirements to secure reservations and Cancellation Protection Plan costs are listed with the cruise prices.

A deposit is required at time of cruise booking. Cancellation Protection Plan, if desired, must be paid for at time of deposit; see Cancellation Protection Plan and Additional Baggage Protection for details (pages 120–121, 125).

Final payment is due no later than 75 days, or 90 days for cruises 26 days or longer, prior to departure. In most cases, we are able to provide you with travel documents, including your cruise contract, approximately 30 days prior to departure. Travel documents, however, are issued only after final payment has been received by Holland America Line.

Travel agents should make checks payable and send to:

Holland America Line Paymaster Corporation  
P.O. Box C34013  
Seattle, WA 98124-1013  
U.S.A.

Payment by American Express, VISA, MasterCard or Discover Card is also accepted.

For faster processing, please include a confirmation number on your check. Travel agents please note that MCOs will not be accepted.

### UPGRADE POLICY

Holland America Line reserves the right to upgrade a guest or guests to more expensive category accommodations at no additional cost.

### CHANGE CHARGES

Changing your itinerary after reservations have been made can result in loss of advantages gained by early planning. In addition, the results of last-minute changes may be disappointing. To cover administrative costs, a per-person charge will be assessed if you request a change in your travel arrangements after final payment due date. Change charges are not assessed for stateroom upgrades or for the addition of services, unless air reservations are altered and/or travel documents must be reissued. For passengers wishing to change date of sailing, please see the Cancellation Policy for applicable charges.

### CANCELLATION POLICY

A full refund (except for amounts paid for CPP) will be made for written cancellations received by Holland America Line, 300 Elliott Avenue West, Seattle, WA 98119 at least 76 days, for cruises 26 days or longer, prior to the date on which you are to commence travel by air, rail, sea or otherwise. Cancellation fees for guests who cancel after that date for any reason, including medical or family reasons, are subject to the following per-person cancellation fees:

#### SAILINGS UNDER 26 DAYS

75–57 days before commencing travel:  
an amount equal to deposit requirement;

56–29 days before commencing travel:  
50% of gross fare;

25–16 days before commencing travel:  
75% of gross fare;

15 days or less before commencing travel:  
100% of gross fare.

#### 26- TO 34- DAY SAILINGS

120–91 days before commencing travel:  
an amount equal to deposit requirement;

90–76 days before commencing travel:  
60% of gross fare;

75 days or less before commencing travel:  
100% of gross fare.

Given that the resale of cancelled space will likely result in a lost opportunity to sell other space, these fees are due regardless of resale. Fees incurred as a result of cancellation cannot be applied to future bookings. Refunds will normally be made to your travel agent. Travel agents may impose their own cancellation fees. Agency fees of any nature are a matter to be decided on solely by the agency and guests.

Name changes require the prior approval of Holland America Line and may not always be possible. Cruise contracts are nontransferable. Name changes and departure date changes are considered reservation cancellations and are subject to cancellation fees.

### CRUISE FARES

Traveling with Holland America Line is one of the best vacation values around. Your cruise fare includes accommodations aboard an elegant Holland America cruise ship with most meals and entertainment on board ship. Not included, however, are items of a personal nature, transfers or optional programs or optional activities, such as alcoholic beverages, soft drinks, laundry and dry cleaning, shore excursions, medical, barber and beauty shop services. All fares are per person in U.S. dollars.

### GRATUITY POLICY

Exceptional service is part of the Holland America cruise experience. Because you are our guest, it is our goal to make sure you receive the finest service possible. And we have made it easy for you to reward excellent service on board.

A gratuity of us\$10 per guest per day for dining and stateroom services will be automatically added to your shipboard account on a daily basis. We are confident that you will find the service on board exemplary and, should you wish to make adjustments, you may do so at the end of the cruise by contacting the front office. A 15% service charge will be automatically added to your bar charges and dining room wine account.

In terminals, airports, ports of call and on shore excursions, we suggest that you extend gratuities consistent with customary local practices.

### FARES, NON-DISCOUNTABLE AMOUNTS, TAXES AND SURCHARGES

Holland America Line reserves the right not to honor any published prices that it determines were erroneous due to printing, electronic, or clerical error. Each cruise fare includes a "Non-Discountable Amount." That portion of the fare is neither commissionable to travel agents nor subject to reduction in the event of a percentage discount promotion, 2-for-1 promotion or otherwise. Fares quoted in this brochure are those in effect at the time of printing. If cost factors dictate the need for fare increases, Holland America Line may do so at any time prior to departure. Guests can cancel (without paying a cancellation fee) rather than accept a fare increase. This right does not apply to increases in Taxes or to surcharges, as described below. The term "Taxes" as used by Holland America Line refers to certain taxes, fees and charges imposed by governmental or quasi-governmental authorities, including port authorities, relating to any aspect of your cruise or tour. If governmental action results in any element of Taxes exceeding the estimates used by Holland America Line for purposes of preparing this brochure, we reserve the right to pass through the extra amount.

Similarly, Holland America Line reserves the right to impose or pass through fuel surcharges, security surcharges or similar incidental surcharges. No right of cancellation exists under either of these circumstances.

#### GUESTS WITH DISABILITIES

We do not discriminate against persons on the basis of disability. We seek, to the extent feasible, to accommodate the needs of persons with disabilities. We have a limited number of staterooms designed for wheelchair access. Service animals are permitted on board ships if prior arrangements have been made. You need to be aware, however, that certain land and shore facilities may not be fully accessible to persons with disabilities. While Holland America Line endeavors to contract with companies which provide accessible services and facilities, we cannot guarantee that all services and facilities will be fully accessible. In limited situations where an individual with a disability would be unable to satisfy certain specified safety and other criteria, even when provided with appropriate auxiliary aids and services, we may find it necessary to ask the individual to make alternative travel arrangements. We must be notified of any special medical, physical or other requirements of passengers at the time of booking. Please contact our Access and Compliance Department at [halw\\_access@hollandamerica.com](mailto:halw_access@hollandamerica.com).

#### MEDICAL SERVICES/INFANTS/ PREGNANCY

Each of our ships is equipped with limited medical facilities that are staffed by a physician and registered nurses. The physician is an independent contractor. There will be a fee charged for all medical services and medications obtained on board. If you become ill during the cruise and the physician is unable to care for your needs on board, you will be transferred to medical facilities on shore. If your condition will require that you have special medical apparatus or assistance on board, we must be made aware of that at time of booking in order to determine whether we can accommodate your needs. If you are using prescription drugs, please bring an adequate supply with you and keep them in your carry-on luggage. Due to the limited medical facilities on the ships, we will not accept reservations for infants 12 weeks or younger at time cruise commences, or women who will be 24 or more weeks pregnant at the time their cruise with Holland America Line concludes.

#### IMMIGRATION AND IMMUNIZATION

For cruises beginning and ending in U.S. ports, government-issued photo identification together with an original or certified copy of your U.S. or Canadian birth certificate or your U.S. or Canadian naturalization certificate is acceptable. For all Panama Canal cruises guests are required to carry a passport valid for 6 months after disembarking the ship and necessary visas. Expired passports are not acceptable. You are responsible for securing necessary visa and immunizations. Information on visas, if applicable, is provided to travel agents by Holland America Line. Information on visas may also be obtained by contacting Zierer Visa Services at 1-866-788-1100 or E-mail [hollandvisainfo@zvs.com](mailto:hollandvisainfo@zvs.com). Guests are responsible for staying apprised of all current requirements. As to immunizations, please check with a travel medicine specialist or local health department for

specific recommendations and/or requirements. Additionally, you may find some helpful information on the U.S. Center for Disease Control website at [www.cdc.gov/travel](http://www.cdc.gov/travel) or call toll free 1-877-FYI-TRIP. Some countries have special requirements for minors (under 18) who are not traveling with both parents. Please discuss this with your travel agent. Non-U.S. citizens must have a valid passport and any necessary visas. Please verify carefully the existing identification requirements for your particular travel situation. In addition, non-U.S. citizens who have previously been admitted to the United States for permanent residence must carry their Permanent Resident Card (Form I-551), commonly known as a Green Card.

#### BAGGAGE POLICY

Holland America Line will carry as baggage only your personal effects for your wearing, comfort or convenience during your travel with Holland America Line. Your baggage needs to be placed in securely constructed and locked suitcases or trunks. If your travel includes a land component, you are limited to two pieces of checked baggage and one overnight or light flight bag which must remain in your custody at all times.

Holland America Line does not assume any liability for loss of or damage to or delay of perishable items, medicine, liquor, cash, credit or debit cards, jewelry, gold, silver or similar valuables, securities, financial instruments, records or other valuable or business documents, computers, cellular telephones, cameras, hearing aids, electric wheelchairs, scooters, or other video or electronic equipment, binoculars, film, videotape, computer disks, audio disks, tapes or CDs. These items should not be left lying about the ship or your stateroom, nor should they be left unattended on other vessels, railcars or other vehicles or in hotels, nor placed in luggage other than the bag you carry with you. In addition, Holland America Line will not assume any liability for any loss of or damage to carry-on baggage left unattended on the ship or on other modes of transportation or in hotels. Holland America's ships provide, at no extra charge, either safe-deposit boxes in the ship's Front Office or stateroom safes. Certain hotels may also provide similar facilities. Your use of safe-deposit boxes, stateroom safes or similar facilities will not increase Holland America's liability as described below.

Holland America Line cannot be responsible for any loss, delay or damage that occurs before baggage comes into Holland America's actual custody when you begin your travel with us or after baggage leaves Holland America's actual custody at the end of your travel with us. In particular, please note that we assume no responsibility for loss, damage or delay while baggage is in the custody of airlines.

If Holland America Line, due to any cause whatsoever, is liable for loss of, damage to or delay of your property, the amount of Holland America's liability will not exceed US\$100 (US\$600 for guests who have purchased Cancellation Protection Plan) unless you have specified to Holland America Line in writing the true value of your property and paid to Holland America Line before departure 1% of the value in excess of US\$100 or US\$600, as applicable. In that event, Holland America Line's liability will be limited to the amount so specified.

#### RESPONSIBILITY

The *ms Noordam*, *ms Amsterdam*, *ms Oosterdam*, *ms Prinsendam*, *ms Zuiderdam*, *ms Volendam*, *ms Zaandam* and *ms Westerdam* are owned by HAL Antillen N.V. and chartered to Holland America Line N.V. The *ms Ryndam* and *ms Maasdam* are owned by HAL Nederland N.V. and chartered to Holland America Line N.V. The *ms Veendam* is owned by Wind Surf Limited and chartered to HAL Cruises Limited. All of these entities are affiliates of Holland America Line Inc. Transportation aboard the ship is provided solely by the Shipowners and Charterers and pursuant to the Cruise Contract that you will receive prior to embarkation. A copy of the form of cruise contract will be provided upon request or can be viewed on our website: [www.hollandamerica.com](http://www.hollandamerica.com). Please note that the contract includes a clause specifying certain courts in the State of Washington as the exclusive forum for resolving disputes.

Non-Holland America Services (such as airlines and ground carriers, shore excursions, restaurants, air ambulance, hotels and shoreside physicians) are generally performed by independent contractors. These Non-Holland America Services are solely at your risk and subject to the terms or arrangements made by you or on your behalf with the independent contractor. We assume no responsibility with respect to these Non-Holland America Services (including cancellation, delay, injury, death or damage to property) even though we may collect monies or make bookings.

Situations may arise which, in our opinion, make it necessary for us to cancel, advance or postpone a scheduled departure, change itineraries or make substitutions involving hotels, restaurants, ports of call, other travel components, vessels or other modes of transportation. In that event, we do not assume responsibility or liability for any resulting losses, expenses or inconvenience. Your full cruise fare will be refunded, however, if the cruise is cancelled prior to initial embarkation. We are not required to make refunds once travel commences regardless of the reason for guests being unable to complete their travel.

#### SHIPS' REGISTRY

The *ms Noordam*, *ms Westerdam*, *ms Ryndam*, *ms Oosterdam*, *ms Prinsendam*, *ms Zuiderdam*, *ms Zaandam*, *ms Volendam*, *ms Maasdam* and *ms Amsterdam* are registered in The Netherlands; *ms Veendam* in the Bahamas. Holland America Line has registered trademarks in the United States and various foreign countries for the names and phrases "Holland America," "Holland America Line," "Westours," "A Tradition of Excellence," "AirPlus Service," "Oceans Apart," "Club HAL," "Wayfarer," "Westfarer," "Seafarer," "Sunfarer," "Eastfarer," and "The World In Your Hands," as well as for the modern and antique ship design logo.

Should you need to contact Holland America Line prior to sailing, please use this address:

Holland America Line Inc.  
300 Elliott Avenue West  
Seattle, Washington 98119  
U.S.A.

# HOLLAND AMERICA LINE IS A PROUD MEMBER OF



Holland America Line



Carnival Cruise Lines



Princess Cruises



Cunard Line



Costa Cruises



Holland America Line is one of the many distinctive cruising experiences available through World's Leading Cruise Lines. Each of our members excels in a particular style of cruise vacationing. Enjoy the timeless sophistication of Holland America Line, the fun spirit of Carnival Cruise Lines, the affordable luxury of Princess Cruises, the classic British tradition of Cunard Line, the Italian charm of Costa Cruises, the casual elegance of Windstar Cruises and the indulgent intimacy of The Yachts of Seabourn.



And only the members of World's Leading Cruise Lines can offer excellent values through Vacation Interchange Privileges. If you have previously cruised on any of our member lines, VIP entitles you to sail Holland America Line for your next vacation and receive certain Holland America past-passenger cruise fare savings when you book. With World's Leading Cruise Lines, you're sure to choose the vacation experience that best fits your lifestyle.

For more information, visit [www.worldsleadingcruiselines.com](http://www.worldsleadingcruiselines.com)



**Holland America Line**

*A Tradition of Excellence*

SPACIOUS, ELEGANT SHIPS  
GRACIOUS, UNOBTRUSIVE SERVICE • WORLDWIDE ITINERARIES  
EXTENSIVE ACTIVITIES AND ENRICHMENT PROGRAMS  
SOPHISTICATED FIVE-STAR DINING

Call your travel agent or 1-877-SAIL HAL, ext. 54  
or visit [www.hollandamerica.com](http://www.hollandamerica.com).

Sail on any member of World's Leading Cruise Lines and you'll be entitled to certain past-guest cruise fare savings currently being extended by any of our lines to their past guests.

Effective March 2005 CB15416 Printed in U.S.A.

©2005 Holland America Line Inc.